



Otley 28 Hall Road, Cheltenham, GL53 0HE

£2,750 Per month

**TO LET**



- Four Bedrooms
- Three Reception Rooms
- Large Garden
- Gas Central Heating
- Council Tax Band - D
- Two Bathrooms
- Unfurnished
- Driveway Parking
- Period Features
- EPC Rating - D

## THE PROPERTY

A beautiful example of an Edwardian semi-detached house located in a highly desirable position in ever popular Leckhampton within walking distance of superb local amenities and schools.

The property has been updated and extended in recent years providing a delightful living space with flexible accommodation throughout. The property briefly comprises of a through sitting / formal dining room with wood burning stove and bay window, cloakroom, utility, contemporary fitted kitchen / breakfast room with stylish fitted kitchen units and range cooker and space for dining and casual seating and bi-folding doors to the garden. Upstairs there are two double bedrooms to the first floor with a well-appointed family bathroom, plus a further two double bedrooms and a shower room to the top floor.

Externally there is off road parking to the front and a deceptively large garden with two patio areas and three large sections including fruit trees and mature planting. The property is warmed throughout by gas central heating

## SITUATION

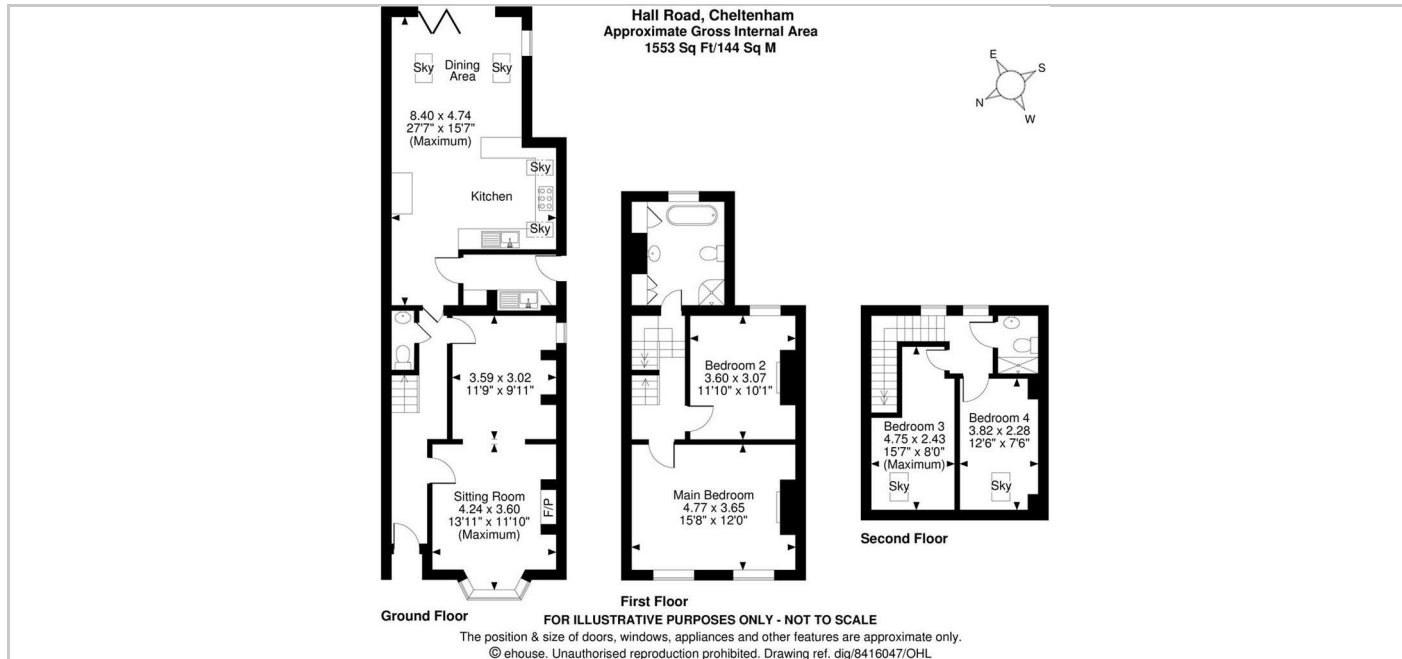

## Directions