



Northwick Close, NW8

£426 Per week

A one-double bedroom flat situated in a private mews in St. John's Wood, on the first floor. The apartment has a bright, open-plan reception and a modern kitchen with integrated appliances. Ideal for a single professional.

Cedric Chambers is conveniently located in the heart of St. John's Wood with multiple underground stations nearby and the Lords Cricket Ground.

Features

- One Double Bedroom
- Open-Plan Reception
- First Floor Flat
- Open Plan Kitchen
- Part Furnished
- Mews Flat

Northwick Close, London, NW8

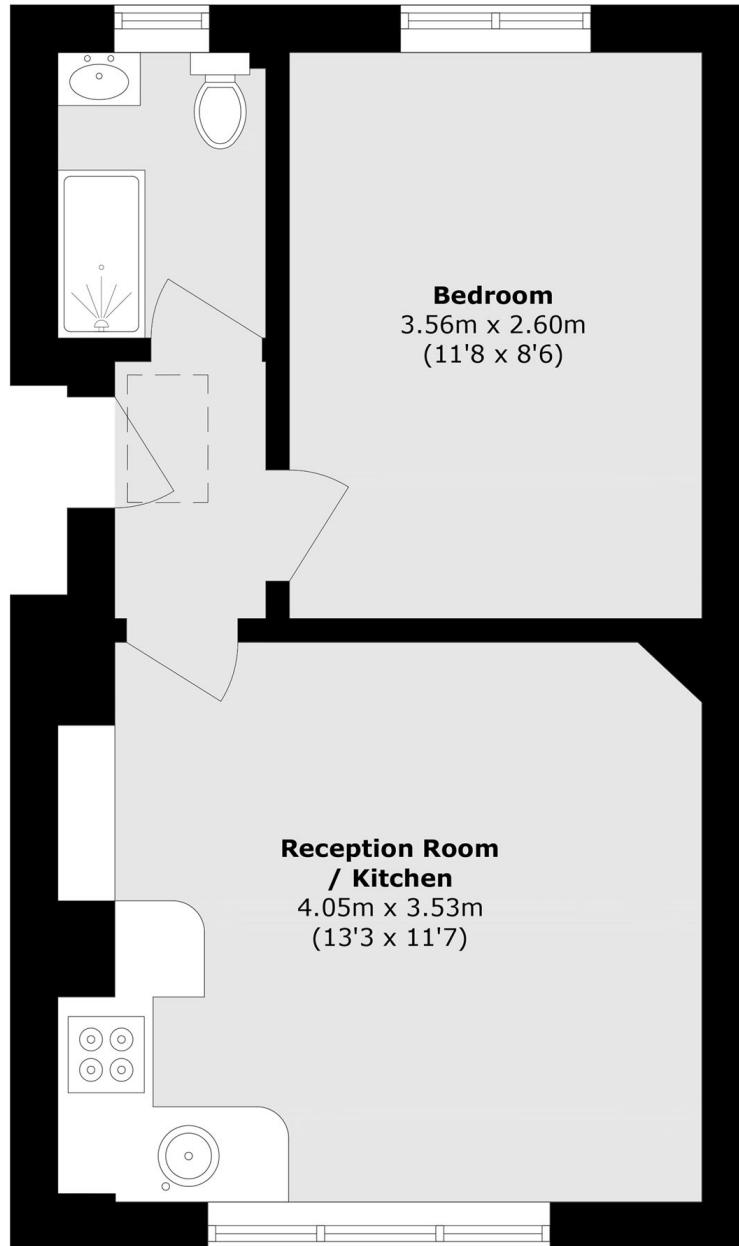

Total area (approx.): 28.7 sq. m (308.9 sq. ft)