



Field View, Wethersfield, Braintree, CM7 4FF



welcome to

Field View, Wethersfield, Braintree

William H Brown are delighted to offer this modern five bedroom family home spread across three floors, featuring ample living space and positioned in a quiet cul-de-sac, with field views in the popular village of Wethersfield. The property is close to local amenities and the primary school.



Entrance Hall

Stairs to first floor, radiator, luxury vinyl flooring.

Cloakroom

Low level WC, hand wash basin, heated towel rail, luxury vinyl flooring.

Lounge

28' 3" x 11' 10" (8.61m x 3.61m)

Double glazed window to front aspect, double glazed window to rear aspect, double glazed door to rear, three radiators.

Dining Room

12' 2" x 11' 10" (3.71m x 3.61m)

Double glazed French doors to rear, radiator, luxury vinyl flooring.

Kitchen

10' 2" x 9' 10" (3.10m x 3.00m)

Double glazed window to front aspect, range of base and eye level units with work surface over incorporating a one and a half stainless steel sink drainer with hot and cold mixer tap, integrated oven with four ring hob and extractor fan, integrated dishwasher, integrated fridge freezer, radiator, luxury vinyl flooring.

Utility Room

6' 7" x 6' 7" (2.01m x 2.01m)

Obscure double glazed window to side aspect, stainless steel sink drainer, plumbing for washing machine, radiator.

Landing

Stairs leading to second floor.

Bedroom

16' 5" x 9' 10" (5.00m x 3.00m)

Double glazed window to front aspect, radiator.

En-Suite

8' 2" x 7' 10" (2.49m x 2.39m)

Obscure double glazed window to front aspect, walk in shower cubicle, low level WC, hand wash basin, shaver point.

Bedroom Two

14' 1" x 10' 10" (4.29m x 3.30m)

Double glazed window to front aspect, radiator.

En-Suite

5' 11" x 5' 7" (1.80m x 1.70m)

Double glazed window to side aspect, walk in shower cubicle, low level WC, pedestal hand wash basin, heated towel rail.

Bedroom Five

12' 6" x 10' 2" (3.81m x 3.10m)

L'shaped, double glazed window to rear, radiator.

Bathroom

9' 2" x 7' 10" (2.79m x 2.39m)

Obscure double glazed window to rear aspect, low level WC, pedestal hand wash basin, panel enclosed bath with hot and cold mixer tap and shower attachment, heated towel rail.

Landing

Airing cupboard

Bedroom Three

15' 1" x 9' 10" (4.60m x 3.00m)

Double glazed window to front aspect, radiator , cluster of built in wardrobes, eves storage

Bedroom Four

13' 9" x 12' 2" (4.19m x 3.71m)

Double glazed window to front aspect, radiator.

Shower Room

6' 3" x 3' 11" (1.91m x 1.19m)

Walk in shower cubicle, low level WC, pedestal hand wash basin, heated towel rail.

Garden

Large laid to lawn garden approximately 100 ft enclosed by panel fencing.

Parking

Double width driveway for multi cars leading to double garage with power and lighting.



view this property online williamhbrown.co.uk/Property/BTR110070



welcome to

Field View, Wethersfield, Braintree

- Five Double Bedrooms
- Detached Family Home
- Two En-Suite, Bathroom & Cloakroom
- Two Reception Rooms
- Air Source Heat Pump

Tenure: Freehold EPC Rating: B
Council Tax Band: G

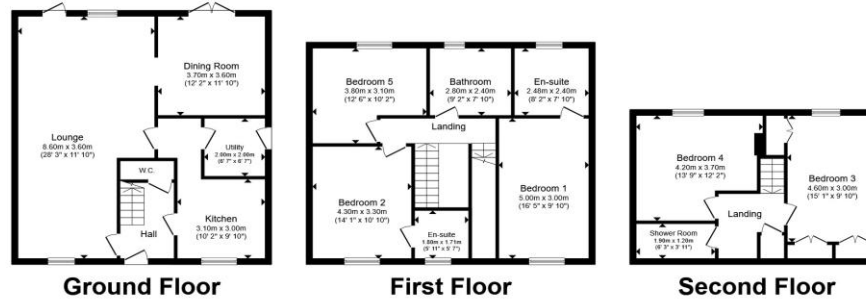

offers over

£675,000

Total floor area 181.0 m² (1,948 sq.ft.) approx
This floor plan is for illustrative purposes only. It is not drawn to scale. Any measurements, floor areas (including any total floor area), openings and orientation are approximate. No details are guaranteed, they cannot be relied upon for any purpose and they do not form part of any agreement. No liability is taken for any error, omission or misstatement. A party must rely upon its own inspection(s). Powered by www.propertybox.io

william
h brown



view this property online [williamhbrown.co.uk/Property/BTR110070](https://www.williamhbrown.co.uk/Property/BTR110070)

Please note the marker reflects the
postcode not the actual property



Property Ref:
BTR110070 - 0003

1. MONEY LAUNDERING REGULATIONS Intending purchasers will be asked to produce identification documentation at a later stage and we would ask for your co-operation in order that there is no delay in agreeing the sale. 2. These particulars do not constitute part or all of an offer or contract. 3. The measurements indicated are supplied for guidance only and as such must be considered incorrect. Potential buyers are advised to recheck measurements before committing to any expense. 4. We have not tested any apparatus, equipment, fixtures or services and it is in the buyers interest to check the working condition of any appliances. 5. Where an EPC, or a Home Report (Scotland only) is held for this property, it is available for inspection at the branch by appointment. If you require a printed version of a Home Report, you will need to pay a reasonable production charge reflecting printing and other costs. 6. We are not able to offer an opinion either written or verbal on the content of these reports and this must be obtained from your legal representative. 7. Whilst we take care in preparing these reports, a buyer should ensure that his/her legal representative confirms as soon as possible all matters relating to title including the extent and boundaries of the property and other important matters before exchange of contracts.

William H Brown is a trading name of Sequence (UK) Limited which is registered in England and Wales under company number 4268443, Registered Office is Cumbria House, 16-20 Hockliffe Street, Leighton Buzzard, Bedfordshire, LU7 1GN. VAT Registration Number is 500 2481 05.

william
h brown



01376 320018



braintree@williamhbrown.co.uk



51-53 High Street, BRAINTREE, Essex, CM7 1JX



[williamhbrown.co.uk](https://www.williamhbrown.co.uk)