

£215,000

Burket Close

Southall, UB2 5NU

PROPERTY SUMMARY

Situated on the second floor, in Burket Close Norwood Green this well presented two bedroom flat offers a fantastic opportunity for first time buyers & Investors.

The property features a spacious double bedroom, a bright open plan living area with a charming Juliet balcony that allows plenty of natural light to flow through. A well maintained bathroom adds to the homes overall appeal.

Location is a key highlight, with excellent transport connections nearby including Elizabeth Line, providing fast and convenient access into Central London as well as easy access to the M4 for those commuting by car. The property is also just a short distance from Southall Broadway known for its vibrant atmosphere and wide variety of international restaurants, shops & amenities.

Further benefits include an extended lease of 167 years upon completion and the added benefit of being offered with no onward chain, ensuring a smooth and straightforward purchase.

Tenure: Leasehold 167 Years
Annual Service Charge: £2,600
Annual Ground Rent: £90

1



1



1





Burket Close, Southall

Approximate Gross Internal Area
431 sq ft - 40 sq m

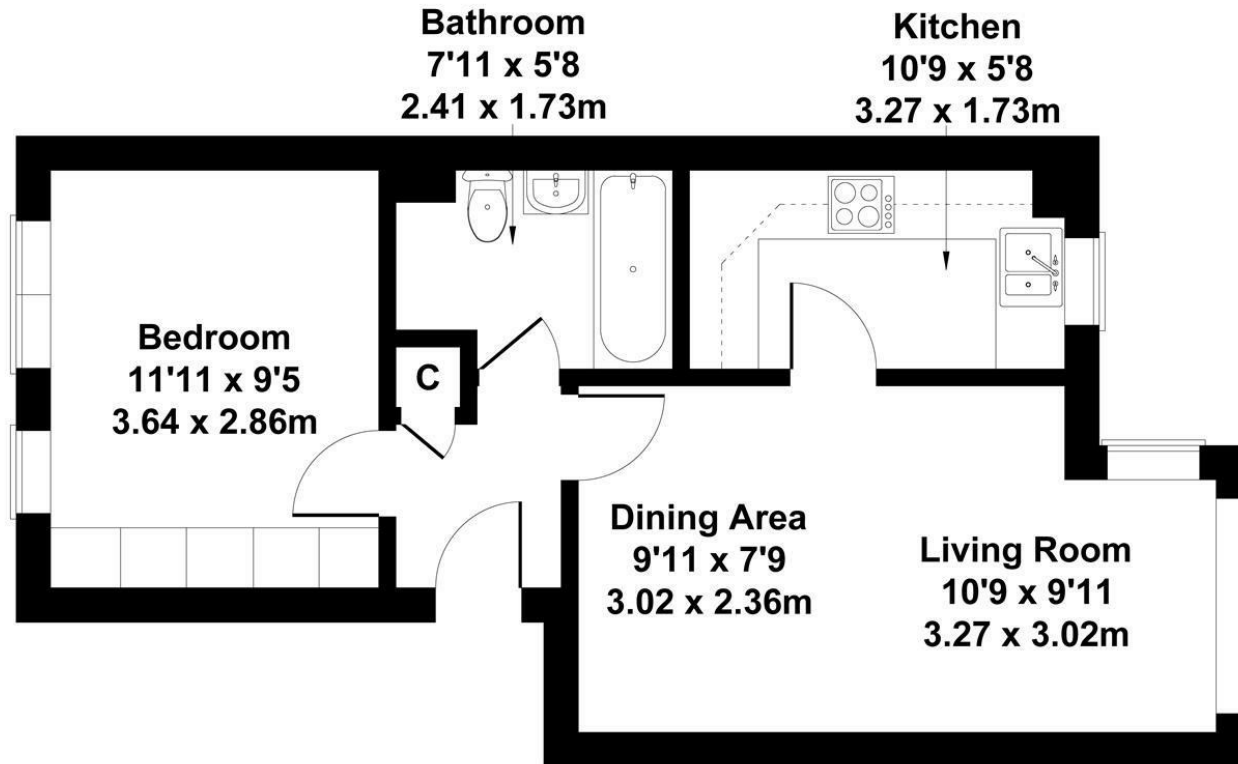

LOCAL AUTHORITY

Hounslow

TENURE

Leasehold

COUNCIL TAX BAND

B

VIEWINGS

By prior appointment only

Energy Efficiency Rating		Current	Potential
Very energy efficient - lower running costs			
(92 plus) A			
(81-91) B			
(69-80) C		69	79
(55-68) D			
(39-54) E			
(21-38) F			
(1-20) G			
Not energy efficient - higher running costs			
England & Wales		EU Directive 2002/91/EC	



Not to Scale. Produced by The Plan Portal 2026
For Illustrative Purposes Only.

Shaw
& Co

Agents Note: Whilst every care has been taken to prepare these particulars, they are for guidance purposes only. All measurements are approximate and are for general guidance purposes only and whilst every care has been taken to ensure their accuracy, they should not be relied upon and potential buyers/tenants are advised to recheck the measurements

**Shaw
& Co**
ESTATE
AGENTS

OFFICE ADDRESS

10 Central Parade
New Heston Road
Heston
Middlesex
TW5 0LH

OFFICE DETAILS

0208 570 7258
heston@shawandcoestates.com