



Semi-Detached Bungalow

17 Shellbridge Way, Ardrossan, KA22 8LP



taylorandhenderson.co.uk

1		2		1		C	EPC rating
---	--	---	--	---	--	---	----------------------

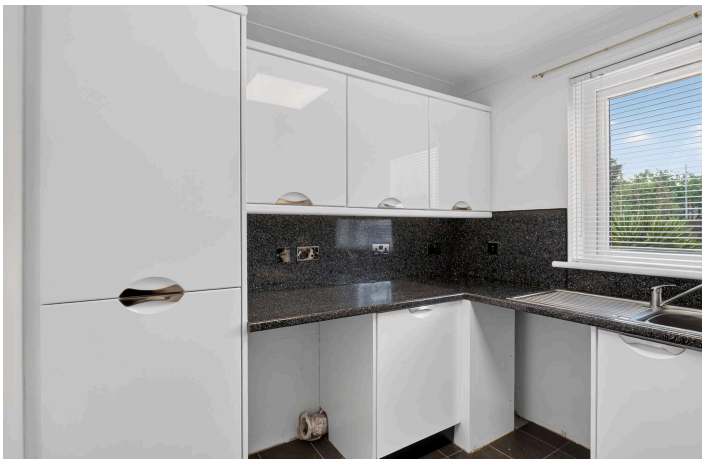

17 Shellbridge Way

Situated in the popular seaside town of Ardrossan, this charming two-bedroom semi-detached bungalow offers comfortable, modern living on a generous corner plot, making it an ideal choice for first-time buyers, downsizers, or those seeking single-level accommodation. The property comprises a bright and spacious lounge, a well-appointed kitchen with ample storage and workspace, two well-proportioned bedrooms both with built in mirrored wardrobes, and a stylish modern shower room. Externally, the bungalow occupies an impressive corner plot with generous gardens offering excellent outdoor space for parking, relaxing, entertaining, or gardening. The extensive grounds also provide potential for further landscaping or extension, subject to the relevant planning permissions. Conveniently located close to local amenities, transport links, schools, and the beautiful Ayrshire coastline, this delightful home combines modern comfort with the benefits of seaside living. Early viewing is highly recommended to fully appreciate all that this attractive property has to offer

Measurements

Hall / Landing	9'9 x 11'9
Kitchen	9'3 x 8'1
Lounge	10'7 x 14'9
Shower Room	6'2 x 6'5
Bedroom 1	11'3 x 9'8
Bedroom 2	8'0 x 8'1

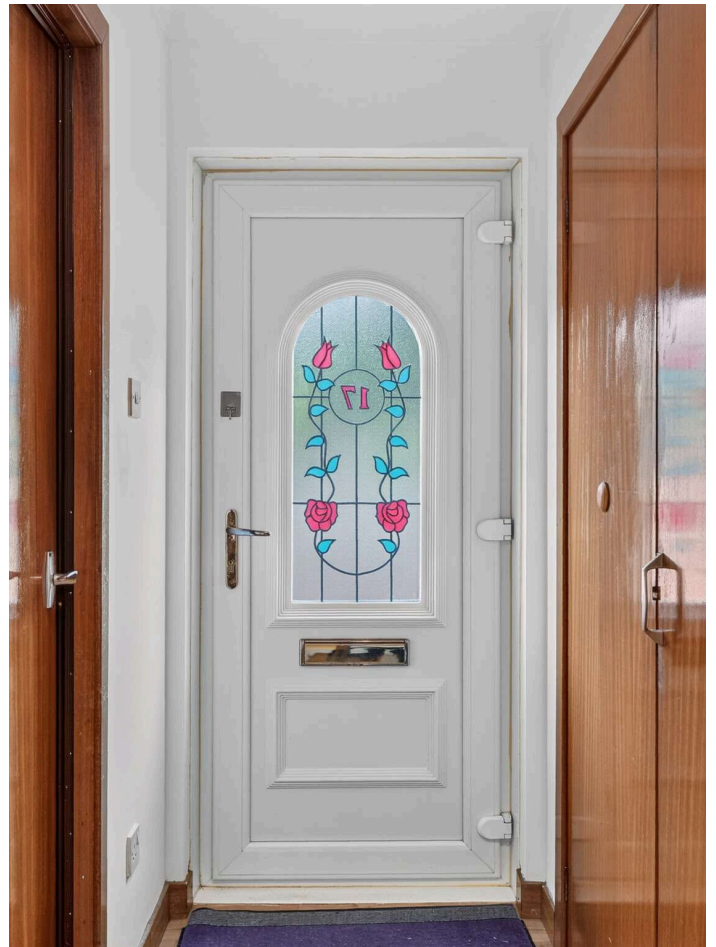

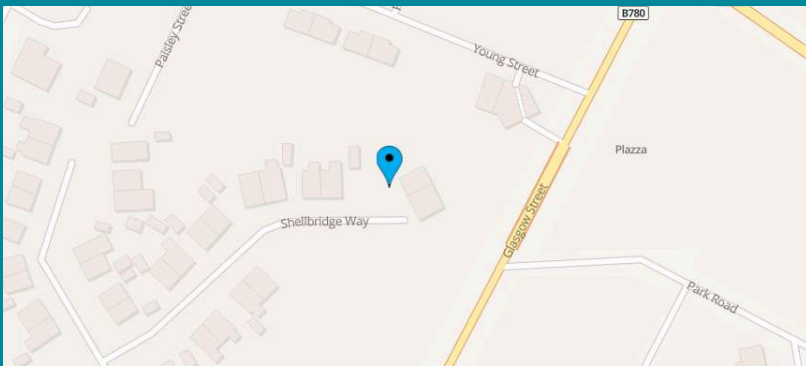

Viewing
Through solicitors on 01294 606700

Email
property@taylorandhenderson.co.uk

Reference
E509743

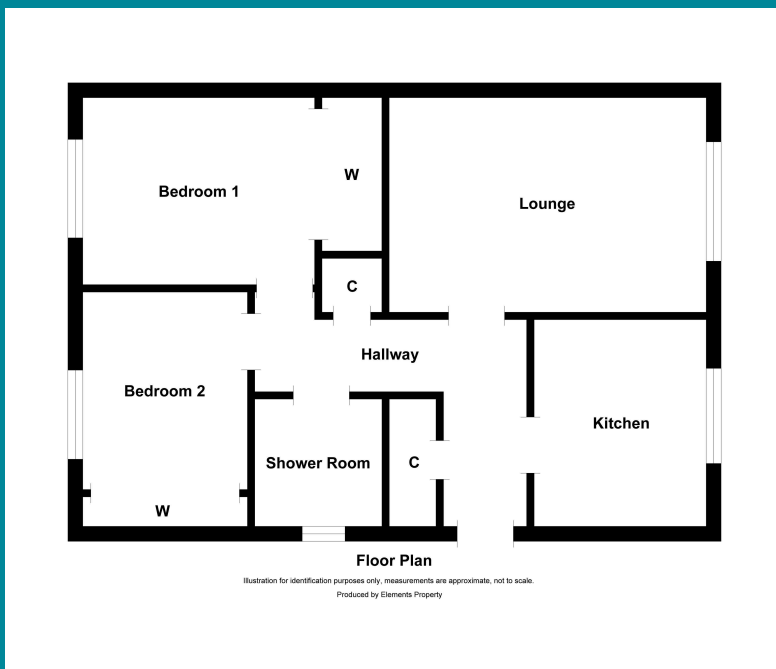

Our Offices

51 Hamilton Street, Saltcoats, Ayrshire, KA21 5DX
Tel: 01294 606700 & Fax: 01294 464827

22 Bank Street, Irvine, Ayrshire, KA12 0AG
Tel: 01294 278306 & Fax: 01294 272886

83 Main Street, Kilwinning, Ayrshire, KA13 6AN
Tel: 01294 557506 & Fax: 01294 558552
Email: property@taylorandhenderson.co.uk

espc rightmove  zoopla  OnTheMarket



DISCLAIMER: Whilst we endeavour to make these particulars as accurate as possible, they do not form part of any contract of offer, nor are they guaranteed. Measurements are approximate and in most cases are taken with a digital/sonic-measuring device and are taken to the widest point. We have not tested the electricity, gas or water services or any appliances. Photographs are reproduced for general information and it must not be inferred that any item is included for sale with the property. If there is any part of this that you find misleading or simply wish clarification on any point, please contact our office immediately when we will endeavour to assist you in any way possible.