



Moor Lane

London, EC2Y

£2,800 per month
(£646.15 per week)

A stunning studio apartment on the 16th floor of this prestigious development. The property is beautifully finished and furnished to a high standard. Residents benefit from 24 hour concierge, private members lounge, cinema room, gym and roof terrace.

CHESTERTONS



Moor Lane

London, EC2Y

- Studio apartment
- Prestigious development
- 16th floor apartment
- 24 hour concierge
- Private members lounge
- Cinema room
- Gymnasium
- Furnished



A stunning studio apartment on the 16th floor of this prestigious development. The property is beautifully finished and furnished to a high standard. Residents benefit from 24 hour concierge, private members lounge, cinema room, gym and roof terrace.

Minimum Term: 12 months
Deposit Required: £3,230.77
Local Authority: (3052) City of London
Council Tax Band: E
EPC Rating: B
Furnished

Energy Efficiency Rating		Current	Potential
Very energy efficient - lower running costs			
(92-100) A			
(81-91) B		82	82
(69-80) C			
(55-68) D			
(39-54) E			
(21-38) F			
(1-20) G			
Not energy efficient - higher running costs			
England, Scotland & Wales		EU Directive 2002/91/EC	

Chestertons Tower Bridge Lettings

220 Tower Bridge Road
 Tower Bridge
 London
 SE1 2UP
 towerbridgelettingsusers@chestertons.co.uk
 02073576911
 chestertons.co.uk

Additional tenant charges apply (fees apply to non-AST tenancies only)
 Tenancy Agreement Fee: £300
 References per Tenant/Guarantor: £60
 Inventory check (approx. £100 – £250 inc. VAT)
 chestertons.co.uk/property-to-rent/applicable-fees

The Heron, EC2Y

Approx. Gross Internal Area 410 Sq Ft - 38.09 Sq M
Approx. Gross Balcony Area 82 Sq Ft - 7.62 Sq M

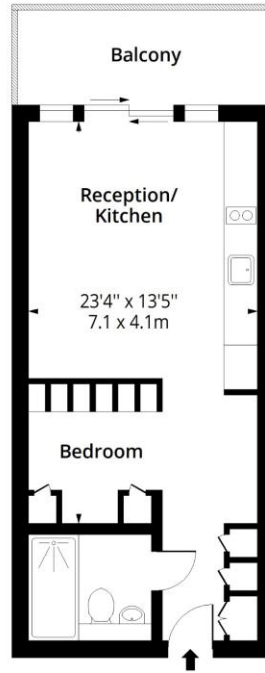

Sixteenth Floor

Floor Area 410 Sq Ft - 38.09 Sq M



Measured according to RICS IPMS2. Floor plan is for illustrative purposes only and is not to scale. Every attempt has been made to ensure the accuracy of the floor plan shown, however all measurements, fixtures, fittings and data shown are an approximate interpretation for illustrative purposes only. 1 sq m = 10.76 sq feet.

lpaplus.com

Date: 3/7/2024

