

KIT JOHNSON

residential



Weston, Bath

£425,000

A 1960's Two Bedroom Detached Bungalow, Popular Location with Views. EPC Grade D



91 Napier Road

Bath

BA1 4LW

PRICE: £425,000

Rarely available and in need of some updating, a solid 1960's detached bungalow with stunning rural views towards Dean Hill and Kelston Roundhill. The level accommodation includes porch, hall, living room, two bedrooms, bathroom, kitchen, Conservatory and lean-to. There is scope to extend (subject to consents). Outside, driveway leading to a good size single garage, gardens and steps up to the front. Extensive rear gardens that take in the wonderful views. Napier Road is ideally situated for all the local amenities in Weston Village, M4 via Lansdown and on a bus route to the City Centre. Offered with vacant possession. Executor's Sale.

1960's Detached Bungalow

Two Bedrooms

Living Room

Kitchen & Conservatory

Bathroom Suite

Detached Garage

Gas Central Heating

Stunning Rural Views

Large Established Gardens

Council Tax Band D £2266

924 Sq Ft (85.8 Sq Mt)

Updating Required

Executor's Sale



Total Area: 85.8 m² ... 924 ft² (excluding garage)

Whilst every attempt has been made to ensure the accuracy of the floorplan contained here, measurements of doors, windows, rooms and any other items are approximate and no responsibility is taken for any error, omission or mis-statement.
This plan is purely for illustrative purposes only and should be used as such by any prospective purchaser.
www.epcassessments.co.uk

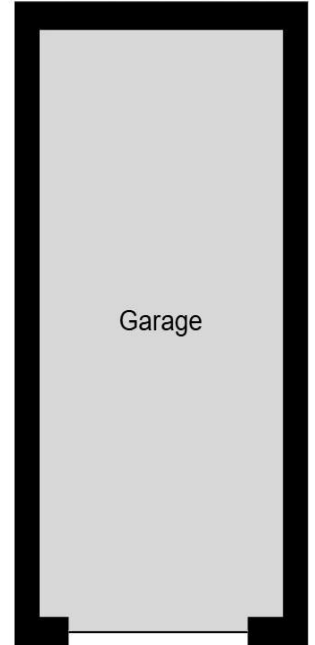
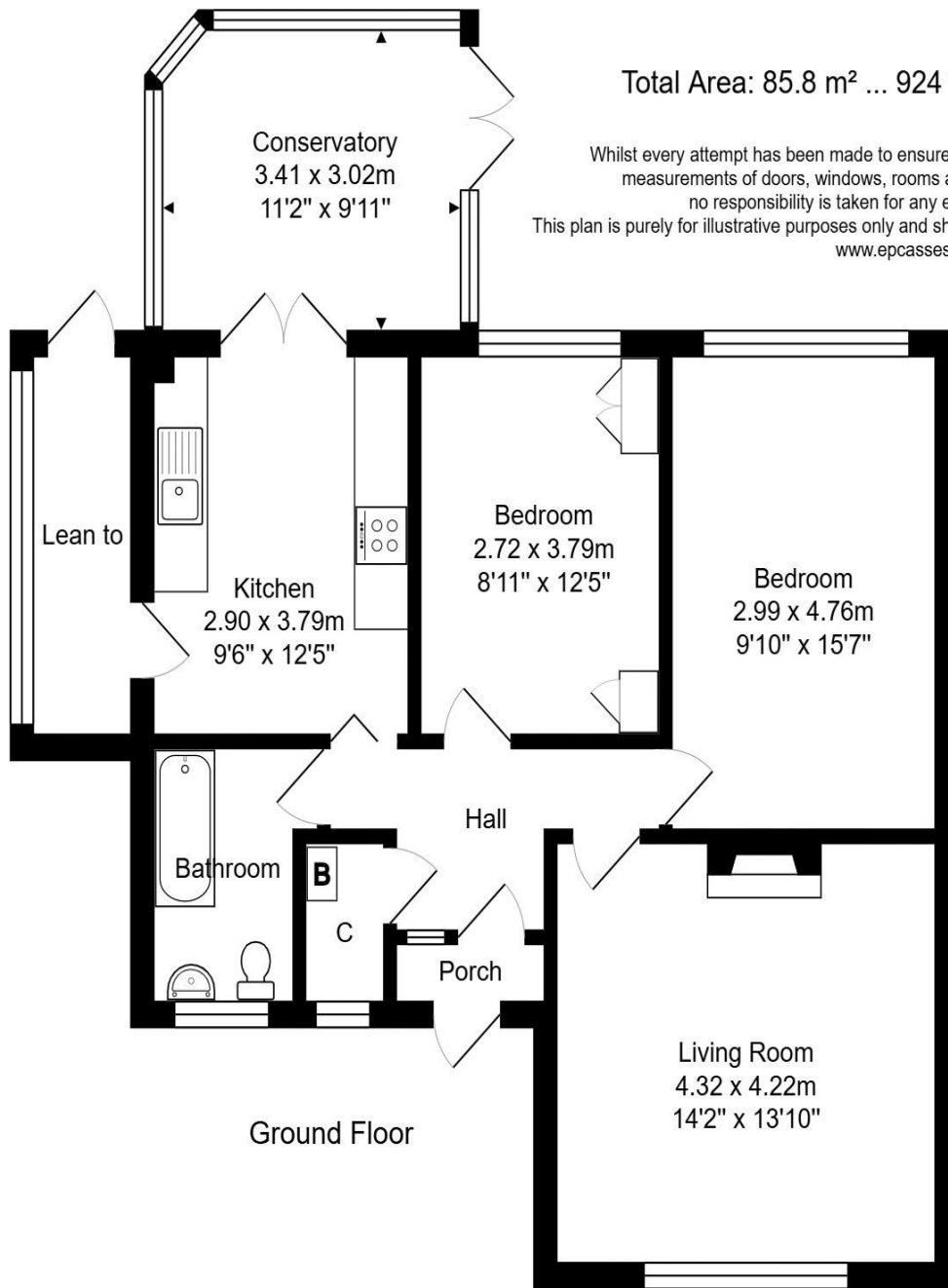

Garage (not in exact location)

Kit Johnson Residential
26-33 High St
Weston
Bath
BA1 4BX
01225 444447
sales@kitjohnson.co.uk
www.kitjohnson.co.uk