



## Dolphin Close

Surbiton, KT6 4DZ

Guide Price £440,000

A wonderful two double bedroom first floor maisonette in a great central location. Located in a quiet development moments from Surbiton High street the property offers spacious accommodation arranged with a separate kitchen to the front with a well proportioned reception to the rear. Off from this is the family bathroom and the two double bedrooms. Further benefits include the loft being demised to the property, engineered wood flooring throughout, residents parking, communal gardens, service charge £1,100 pa and offered to market chain free. Surbiton Mainline station is only a few minutes walk away whilst also being conveniently located close to the local amenities on Maple Road and the River Thames.

Material Information: Brick Walls Roof Clay Tiles. Water / Electricity / Sewerage: Mains. Heating: Gas: Mains. Mobile Indoor Good and Outdoor Good. Council Tax: Kingston Band D

- Top Floor Maisonette
- Spacious Reception Room
- Long lease in excess of 900 years
- Loft Storage
- Residents Parking
- Two Double Bedrooms
- Separate Kitchen
- Low Service approx. £1,100 per annum
- Surbiton Station and Town a few minutes walk away
- Chain Free

# Floor Plan

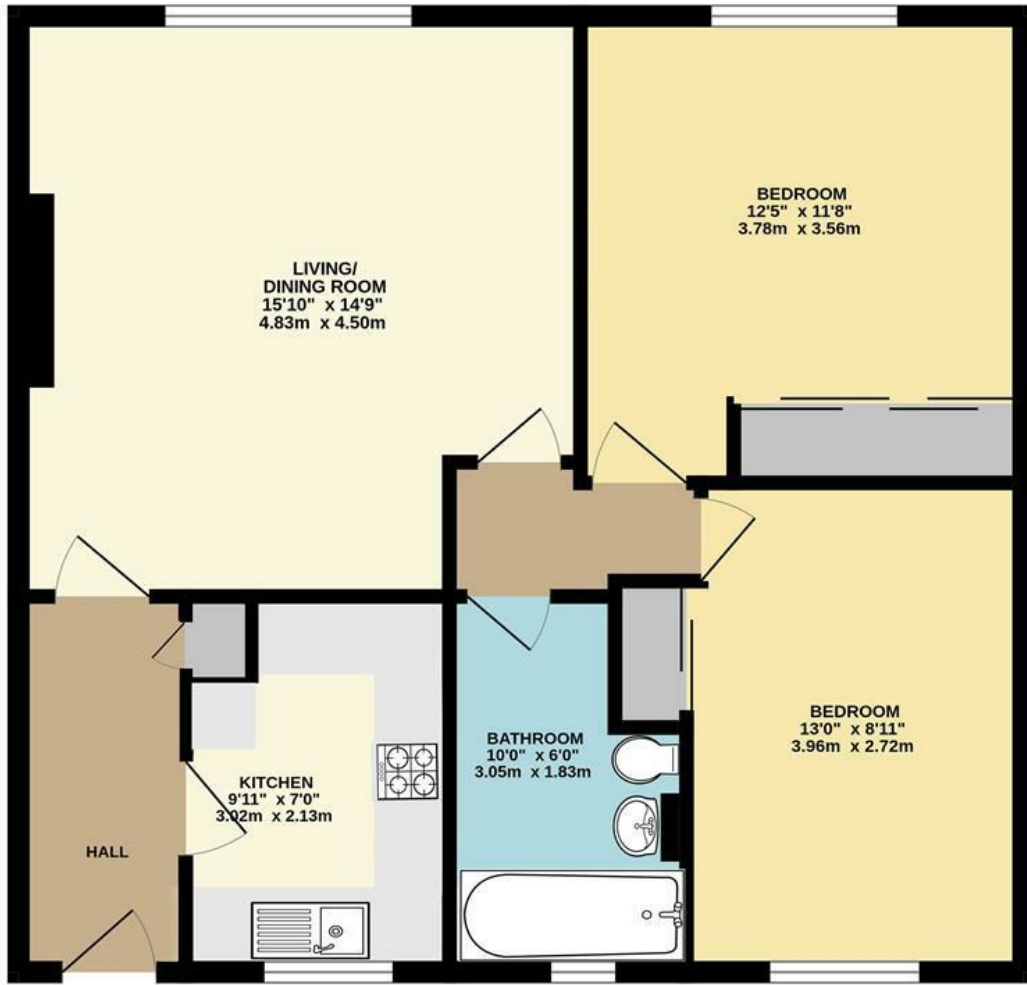

FIRST FLOOR FLAT



DOLPHIN CLOSE, SURBITON  
 INTERNAL FLOOR AREA (APPROX.) 680 sq ft/ 63.2 sq m

Whilst every attempt has been made to ensure the accuracy of this floor plan, measurement of doors, windows, rooms and any other items are approximate and no responsibility is taken for any error, omission or mis-statement. Made with Metropix © 2026.

## Energy Efficiency Graph

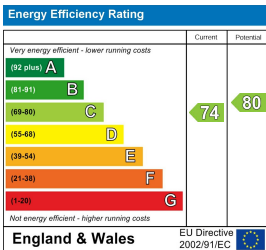

These particulars, whilst believed to be accurate are set out as a general outline only for guidance and do not constitute any part of an offer or contract. Intending purchasers should not rely on them as statements of representation of fact, but must satisfy themselves by inspection or otherwise as to their accuracy. No person in this firm's employment has the authority to make or give any representation or warranty in respect of the property.