

These particulars are believed to be accurate but they are not guaranteed and do not form a contract. Neither Jordan Fishwick nor the vendor or lessor accept any responsibility in respect of these particulars, which are not intended to be statements or representations of fact and any intending purchaser or lessee must satisfy himself by inspection or otherwise as to the correctness of each of the statements contained in these particulars. Any floorplans on this brochure are for illustrative purposes only and are not necessarily to scale.

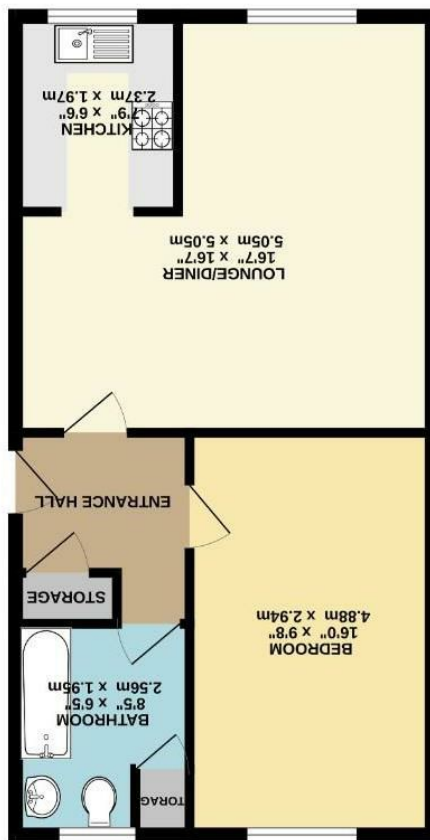

TOTAL FLOOR AREA: 540 sq. ft. (50.1 sq.m.) approx.
Measurements are approximate. Not to scale. Suitable purposes only.
Marked with Metric (ISO) 2004



540 sq. ft. (50.1 sq.m.) approx.
GROUND FLOOR





Barlow Moor Road, Didsbury
M20 2QQ

£210,000



The Property

A SUPERB APARTMENT WITH SYLISH & SPACIOUS LIVING SPACE, ENJOYING A GROUND FLOOR POSITION WITHIN A PURPOSE BUILT DEVELOPMENT WITH RESIDENTS PARKING AND AN IDEAL LOCATION BEING JUST A SHORT STROLL FROM DIDSBURY VILLAGE. 540 sq ft. The apartment can be accessed from both the front and rear of the building via secure communal entrances, and comprises a private hallway with large storage cupboard, generous L-shaped lounge/dining area, recently refurbished fitted kitchen, generous double bedroom and THE bathroom with A modern three piece suite. uPVC double glazing windows are installed and further complemented by gas central heating. Externally, there are well tended communal gardens surrounding the property with a generous residents car park accessed via the side road.

Directions

M20 2QQ

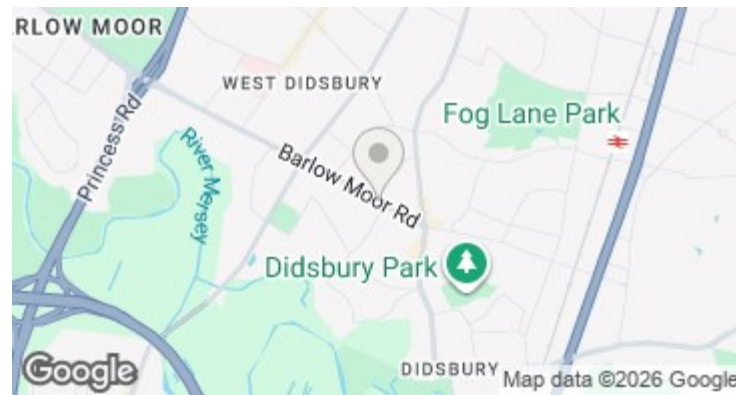

- Impressive apartment
- Stylish & spacious living space
- Modern kitchen & bathroom
- Generous L-shaped living room
- uPVC double glazing
- Gas central heating
- Ample residents parking
- Well tended communal grounds
- Didsbury Village location
- Close to the Metrolink

Postcode - M20 2QQ

EPC Rating - C

Floor Area - 540.00 sq ft

Local Authority - Manchester City Council

Council Tax - B

