



18 Elm Drive Cranbourne Hall Park, Winkfield, Windsor, Berkshire, SL4 4TT
£195,000

 **HORLER**

18 Elm Drive Cranbourne Hall Park, Winkfield, Windsor, Berkshire, SL4 4TT

Located within the charming Cranbourne Hall Park in Winkfield, Windsor, this beautifully presented and refurbished two bedroom mobile home offers a delightful living experience. The property is situated in a highly sought-after family-friendly development, making it an ideal choice for those seeking a peaceful yet vibrant community.



Property Summary

Located within the charming Cranbourne Hall Park in Winkfield, Windsor, this beautifully presented and refurbished two bedroom mobile home offers a delightful living experience. The property is situated in a highly sought-after family-friendly development, making it an ideal choice for those seeking a peaceful yet vibrant community.

As you step inside, you will be greeted by a spacious and light-filled open plan living area, designed with modern living in mind. This inviting space is perfect for both relaxation and entertaining, providing a warm atmosphere for family gatherings or quiet evenings at home. The home features two well-proportioned bedrooms, ensuring ample space for residents or guests.

The exterior of the property boasts an easy-to-maintain garden, allowing you to enjoy the outdoors without the burden of extensive upkeep. Additionally, off-road parking for two cars adds to the convenience of this lovely home, making it suitable for families or those with multiple vehicles.

Being a double unit in size and with no onward chain, this property presents a unique opportunity for prospective buyers to move in swiftly and start enjoying their new home. Imagine spending the remainder of summer in the tranquil village of Winkfield, surrounded by picturesque scenery and a welcoming community.

This mobile home is not just a property; it is a chance to embrace a lifestyle of comfort and ease in a delightful setting. Do not miss the opportunity to make this charming residence your own.

Council Tax:

Council Tax Band 'A'

Site fees.





Elm Drive SL4

Approximate Gross Internal Floor Area = 63.7 sq m / 686 sq ft

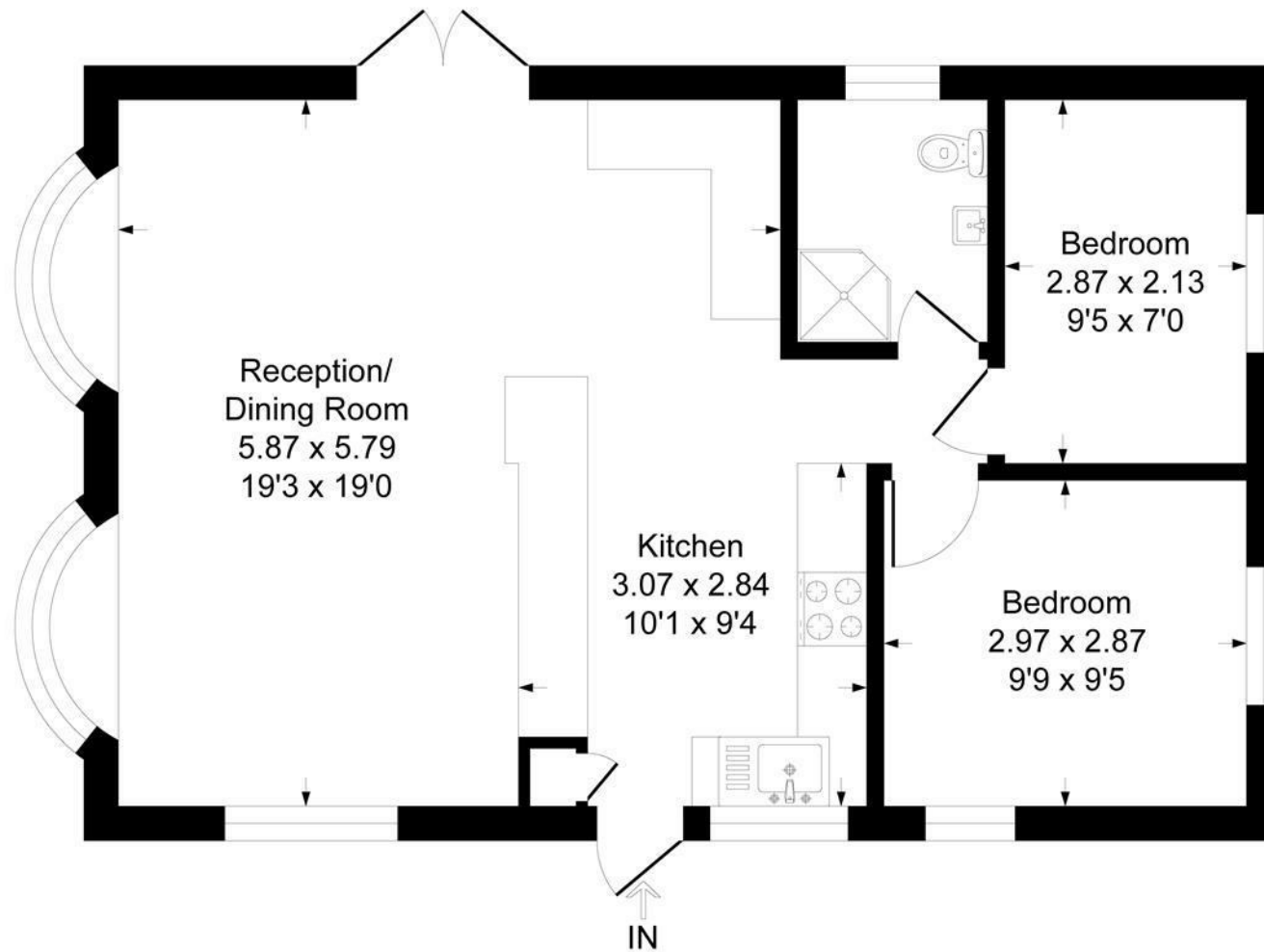

Illustration for identification purposes only, measurements are approximate, not to scale.
Produced By Esjay Property Marketing