



## Maida Avenue, W2

£650,000

A spacious two double bedroom apartment in a red brick Edwardian mansion block with communal gardens, next to the canal in Little Venice. With a separate kitchen, large reception room, utility room and separate WC, this is an ideal property for anyone looking for a spacious home.

Maida Avenue is next to the Grand Union Canal in the heart of Little Venice. Near Paddington Basin with its numerous facilities including the Heathrow Express and National Rail Station. Nearest underground stations include Royal Oak and Warwick Avenue.

### Features

- Two Double Bedrooms
- Large Reception Room
- Separate Kitchen
- Pretty Communal Garden
- Mansion Block
- Little Venice

# Maida Avenue, London, W2

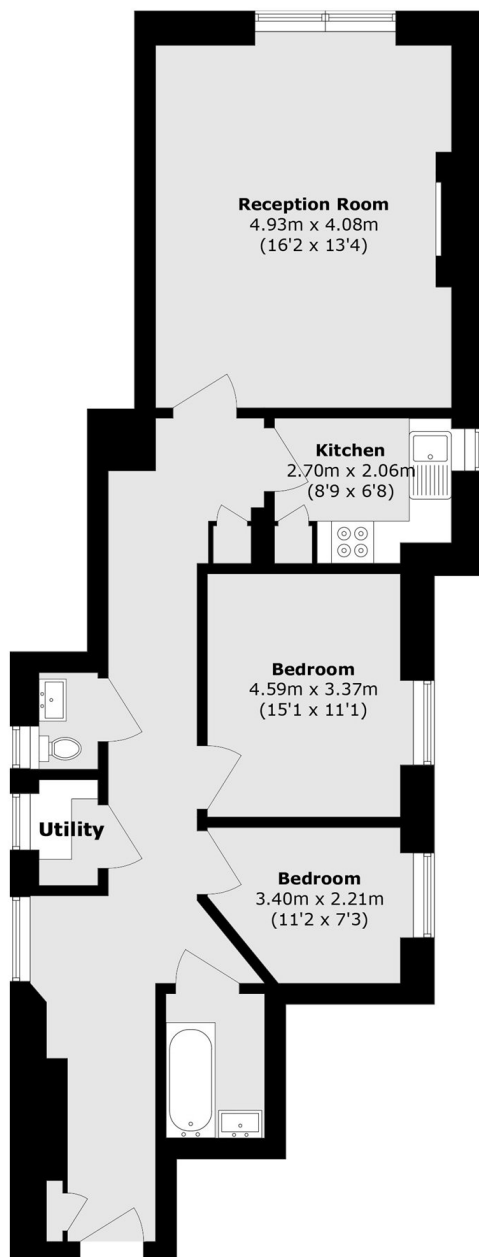

Total area (approx.): 75.1 sq. m (808.4 sq. ft)

## Dexters

Hyde Park and Bayswater  
4-5 Spring Street  
London  
W2 3RA  
Sales  
020 7298 1550

Energy Rating: D. We aim to make our particulars both accurate and reliable. However they are not guaranteed; nor do they form part of an offer or contract. If you require clarification on any points then please contact us, especially if you're traveling some distance to view. Please note that appliances and heating systems have not been tested and therefore no warranties can be given as to their good working order.

 **RICS** | Regulated  
Estate Agent  
and Letting Agent

[dexters.co.uk](https://www.dexters.co.uk)