

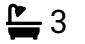

## Church Hill, Banham, NR16

Offers In Region Of £625,000

 3  3  3



Moneyproperties are delighted to bring to market this idyllic Grade II listed Georgian home located in the heart of Banham offering over 1700 sq ft of living space and within a short walk of the beautiful Norfolk countryside. Having been meticulously extended and boasting character and charm throughout this property offers everything you would look for in village living. The accommodation comprises of three versatile reception rooms, kitchen/diner, utility room with pantry and a downstairs shower room. To the upstairs comes three double bedrooms with an ensuite to one bedroom and a jack and jill bathroom to the main bedroom.

**Tenure: Freeholds EPC: E Council Tax: E**

## Key Features

- Idyllic Georgian, Grade II listed family home
- Boasting a wealth of character and charm throughout
- Generous living accommodation with three reception rooms and three double bedrooms
- Stylish open plan kitchen/diner with a separate utility room and pantry
- Popular village location surrounded by the attractive Norfolk countryside
- Well established and mature gardens
- 19ft garden room perfect for entertaining with a generous patio for alfresco dining
- Ample off-road parking complete with a double garage
- Air source heating with a mixture of underfloor heating and radiators throughout
- See our full online listing for further details including flood risk, broadband speed and other material information

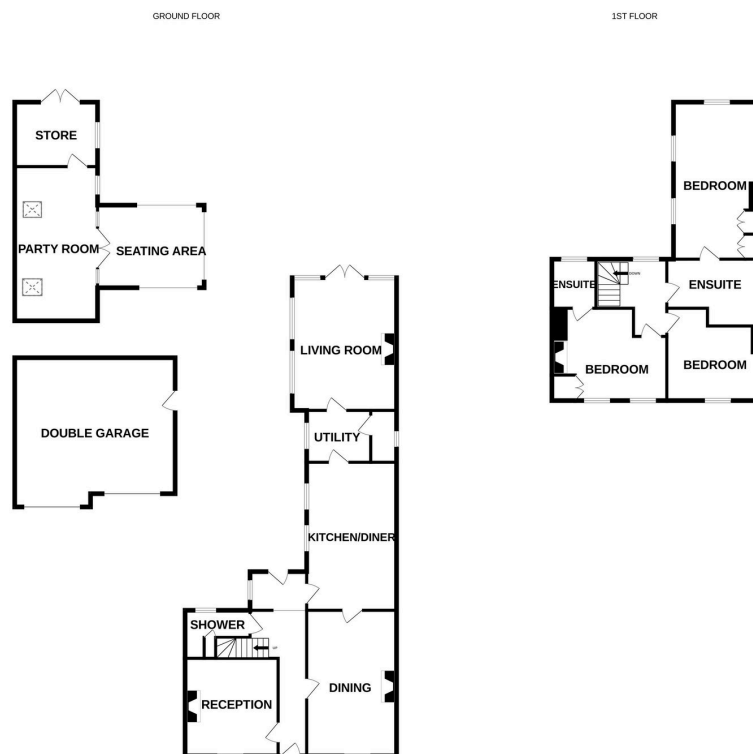

Whilst every attempt has been made to ensure the accuracy of the floorplan contained here, measurements of doors, windows, rooms and any other items are approximate and no responsibility is taken for any error, omission or mis-statement. This plan is for illustrative purposes only and should be used as such by any prospective purchaser. The services, systems and appliances shown have not been tested and no guarantee as to their operability or efficiency can be given.  
Made with Metropix ©2025