



2 Greenfinch Road

Didcot, OX11 6BG

50% Shared Ownership £ 195,000

Modern Three Bedroom End Terrace House in Sought After Didcot Location

We are pleased to offer this stylish and spacious three-bedroom end-of-terrace family home, perfectly positioned in a popular residential area of Didcot. Extending over three floors, this contemporary property offers a versatile living space.

2 Greenfinch Road comprises of entrance hall, living room, kitchen/diner, cloakroom and rear lobby on the ground floor, two double bedrooms and family bathroom on the first floor and a double bedroom with eaves storage on the second floor. Externally, there are two allocated parking spaces to the front of the property and garden measuring 9.8 x 5.2m to the rear.

Didcot town has excellent shopping and leisure facilities and fantastic transport links including Didcot Parkway railway offering access to London Paddington, Oxford and Bristol Temple Meads. The A34 not too far away providing easy access to Oxford, Newbury and the M40.

- Full market price £ 390,000
- Rent £ 543.43 pcm approximately
- Service charge £ 16.17 pcm approximately
- Three double bedrooms
- Allocated off street parking for two cars
- Private fully enclosed garden measuring 9.8 x 5.2m
- Gas central heating
- Downstairs cloakroom
- Double glazed windows
- Popular location



Floor Plan

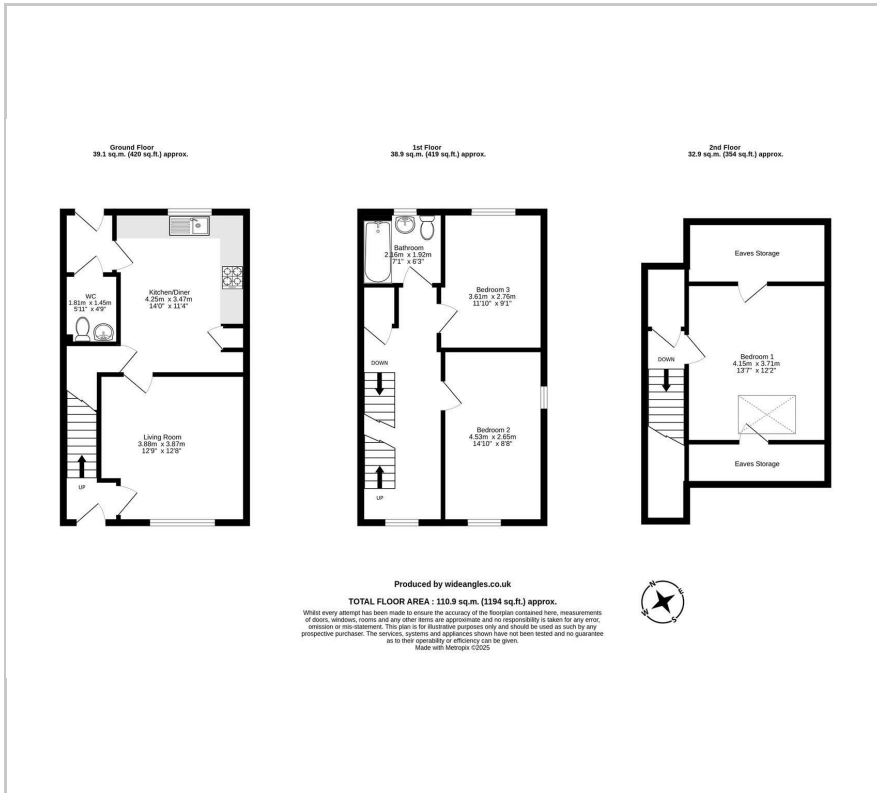

Area Map



Energy Efficiency Graph

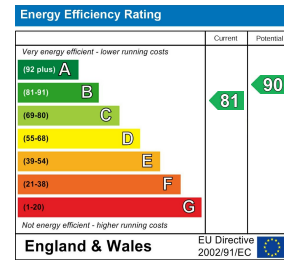

These particulars, whilst believed to be accurate are set out as a general outline only for guidance and do not constitute any part of an offer or contract. Intending purchasers should not rely on them as statements of representation of fact, but must satisfy themselves by inspection or otherwise as to their accuracy. No person in this firm's employment has the authority to make or give any representation or warranty in respect of the property.