



W  
WHITES

8 Wyndham Park, Salisbury, Wiltshire, SP1 3BA

£250,000 Leasehold

## About The Property

This attractive two bedroom end of terrace house forms one of 12 Grade II listed townhouses which were converted approximately 30 years ago from the former Wyndham Park School and the development enjoys a quiet and convenient position within the city centre. It is offered to the market with NO CHAIN.

The property occupies a pleasant location to the rear of Wyndham Park, set around neighbouring courtyard gardens and it also benefits from gas central heating, a single garage, parking and additional guest parking.

The accommodation comprises an entrance hallway which has a useful storage cupboard and leads to a stylish cloakroom.

The sitting/dining room has four attractive feature ceiling height arched windows which enjoy an easterly aspect and have fitted plantation shutters. There is space for a table and chairs, stairs to the first floor with a cupboard under and attractive engineered wood flooring. A door leads in to the kitchen which has base and wall units with an integrated electric oven, hob and extractor. Again there engineered wood flooring and both space for a fridge/freezer and washing machine with a sink under a rear window.

On the first floor there is a galleried landing and the main double bedroom has extensive fitted wardrobes, inset spotlights and enjoys a double aspect. There is a further second bedroom and the bathroom has a bath with a shower over and shower screen and has a tiled floor. All first floor rooms have velux windows.

Gardens lie on three sides of the property and there is a further communal garden area at the rear of the development. There is a large single garage (6.09m x 2.70m) with an up and over door and a parking space in front. Additionally there are visitor spaces and a clothes drying area.

The Wyndham Park development lies just inside the ring road with easy access to the city centre which lies approximately one-quarter of a mile away. It is near to pleasant open parkland and within convenient distance of the Waitrose superstore, It is located towards the northern end of Wyndham Road, which then becomes a no-through road. The property is offered to the market with no onward chain.



- Character two bedroom house
- Converted from former school
- Sitting/dining room
- Kitchen
- Cloakroom
- FF bathroom
- Gardens
- Garage and parking plus visitor spaces
- Communal garden
- No chain





## Further Information

Local authority: Wiltshire Council

Council Tax: C - £2468.97 (2026/2027)

Tenure: Leasehold. Held on a 999 year lease from 1987. There is a service charge of £95 per month.

Services: Mains gas, electricity, water and drainage.

Heating: Gas central heating

Directions: Leave our office in Castle Street and proceed in a northerly direction before turning right into Wyndham Road. As the road bends to the right into Queens Road, the property can be found on the left hand side.

What3words: ///modern.supply.tops

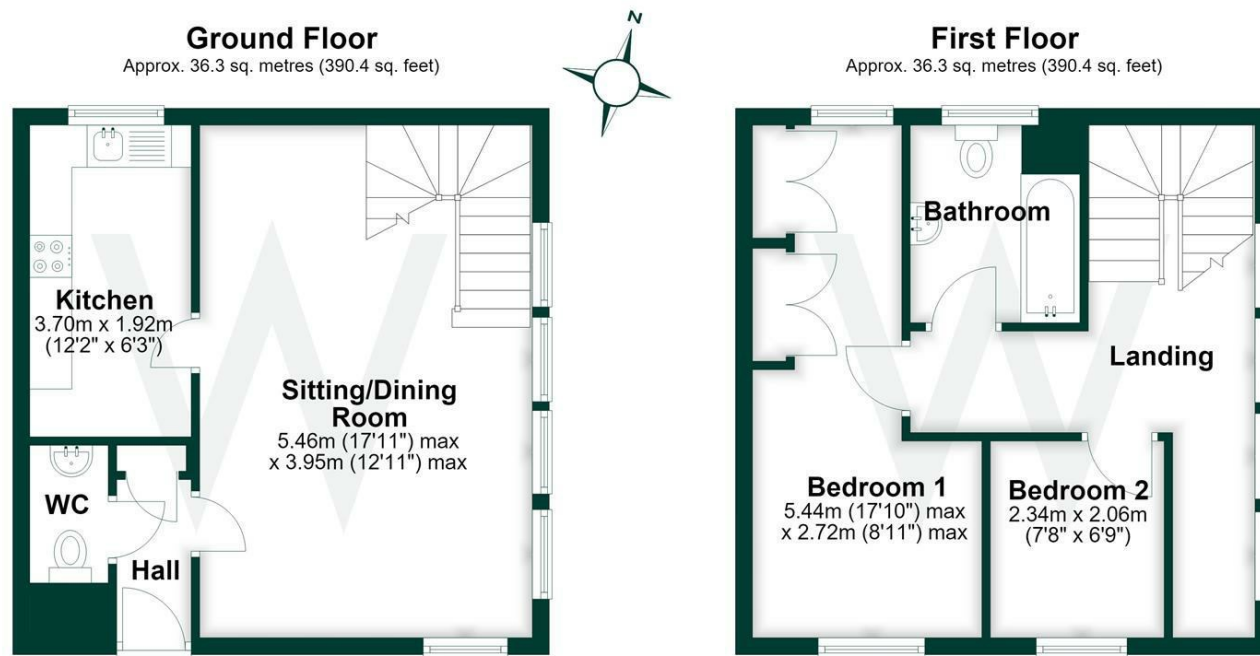

Total area: approx. 72.5 sq. metres (780.9 sq. feet)

Energy Efficiency Rating		Current	Potential
Very energy efficient - lower running costs			
(92 plus) A			91
(81-91) B			
(69-80) C			
(55-68) D		56	
(39-54) E			
(21-38) F			
(1-20) G			
Not energy efficient - higher running costs			
<b>England &amp; Wales</b>		EU Directive 2002/91/EC	