



Windsor Crescent

Duston, Northampton

oriordanbond
SALES & LETTINGS



GROUND FLOOR
784 sq ft (72.9 sq m) approx.

1ST FLOOR
144 sq ft (13.4 sq m) approx.

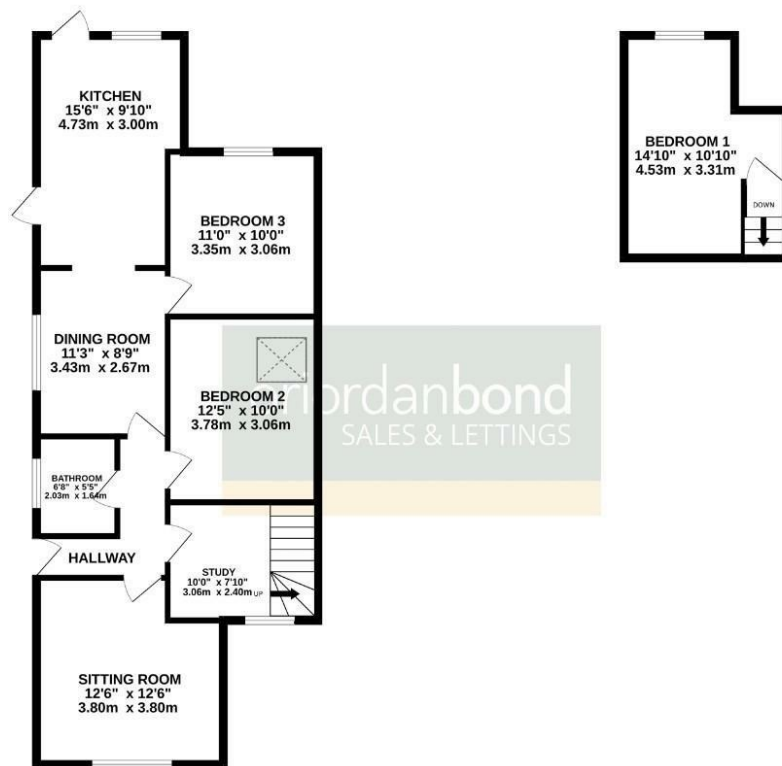

TOTAL FLOOR AREA: 928 sq ft (86.2 sq m) approx.

Whilst every attempt has been made to ensure the accuracy of the floorplan contained here, measurements of doors, windows, rooms and any other items are approximate and no responsibility is taken for any error, omission or misstatement. This plan is for illustrative purposes only and should be used as such by any prospective purchaser. The services, systems and appliances shown have not been tested and no guarantee as to their operability or efficiency can be given.
Made with Metaplan ©2025

Windsor Crescent

Duston

NN5 5AW

PRICE £275,000

Located within the popular area of Duston, set within close proximity to local schools and shops, is this versatile three bedroom semi-detached dormer bungalow. Offering generous living space having been extended by the current owners, the property would make an ideal family home and is presented to a high standard throughout.

Accommodation comprises entrance hall, sitting room, dining room, re-fitted kitchen, study with stairs to first floor bedroom, two ground floor double bedrooms and a ground floor bathroom. Upstairs you will find the third double bedroom. The property also benefits from gas central heating, uPVC double glazing, rear garden being mainly laid to lawn and with patio area and a single garage with ample off road parking to the front and side. (B/928/M)

Additional information

- Council Tax Band: B
- Energy Efficiency Rating: D

Viewing

Viewing strictly by appointment – details below

Disclaimer

O'Riordan Bond Estate Agents Limited has not tested apparatus, equipment, fittings or services and so cannot verify they are in working order. The buyer is advised to obtain verification from their solicitor or surveyor.

O'Riordan Bond Duston Sales

01604 589007

duston@oriordanbond.co.uk

