



Key Features

- ◆ Two-bedroom, two-bathroom, first-floor apartment
- ◆ Magnificent Period property in the highly sought-after Meads area of Eastbourne
- ◆ Close to local shops and amenities
- ◆ Beautiful communal grounds
- ◆ Allocated Parking space
- ◆ EPC rating D



22 Darley Road, Meads, Eastbourne

£1,495 PCM



Northwood are delighted to welcome to market this stunning two-bedroom, two-bathroom, first-floor apartment in the highly-sought after Grade 11 listed All Saints development in the Meads area of Eastbourne.

Accommodation is arranged over two floors and comprises: living room, modern fitted kitchen with integrated fridge-freezer, washer-dryer and dishwasher, downstairs cloakroom, two double bedrooms, en suite shower room and separate family bathroom.

Further benefits include allocated parking space, underfloor heating, lift access, secure entry phone and use of private gym and reading room.



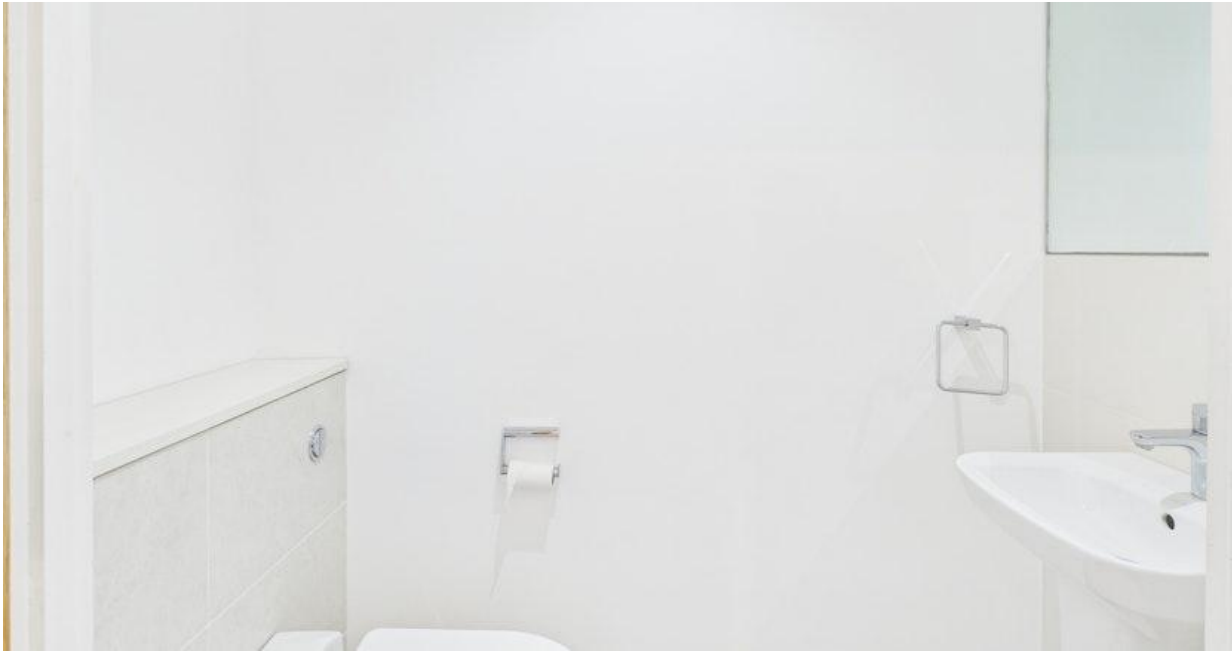

Located in the architecturally stunning All Saints development just off Meads Village high street, behind a secure gate and surrounded by manicured communal grounds and cloisters, this incredible Grade II listed building is home to some of the best apartments in Eastbourne. Packed with quirky historical features including mullioned windows, turrets and a spiral staircase, this elegant apartment has been finished to a high standard and is minutes from the Holywell end of Eastbourne's fabulous Victorian seafront.

Please view our immersive virtual tour to fully appreciate this fantastic property:
<https://tour.giraffe360.com/9fc1d6ec58ad4a75a8cf46bb4f765b8b>

Mobile Phone Coverage and Broadband speeds can be checked on the Ofcom website:
<https://checker.ofcom.org.uk/>

Council Tax Band E: £3245

Holding Deposit: £345.00 (equivalent to one week's rent)
Full Deposit: £1725.00 (holding deposit + equivalent of four weeks' rent)
1st month's rent + Full Deposit: £3,335.00

Total household income must exceed £44,850.00 to be considered for this property.

This property is managed by Northwood, should a maintenance issue arise, it can be reported 24 hours a day via our website.







Imagery ©2025 Earthstar Imagery ©2025 Airbus Maxar Telesp

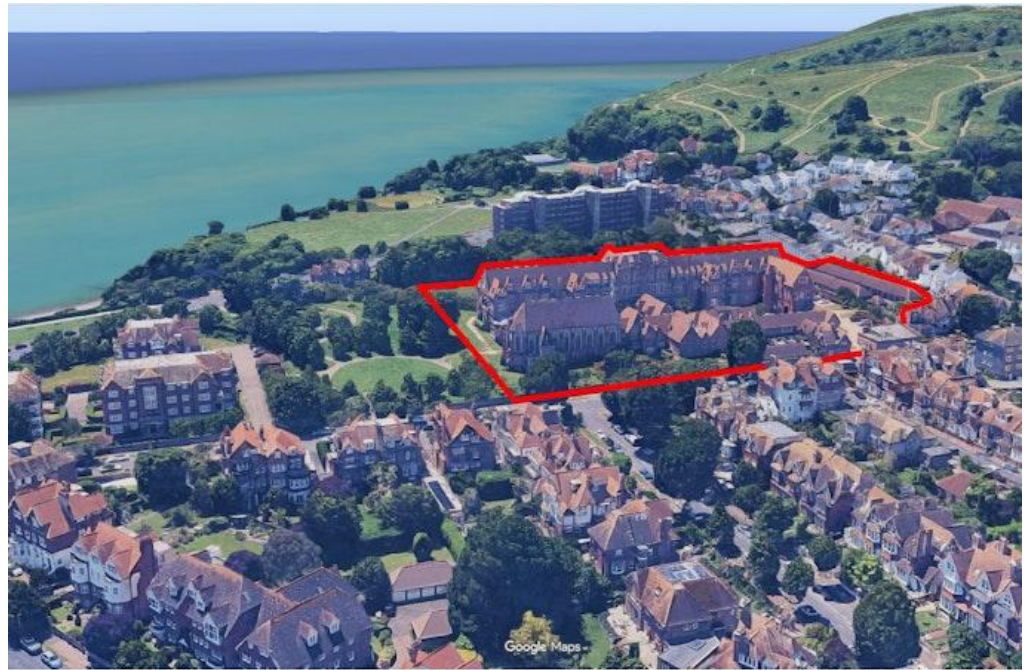

Imagery ©2025 Google, Data SRT NOAA, U.S. Navy, NGA, GEBCO, Airbus, Garmin / Copernicus, Imagery ©2025 Airbus, Maxar

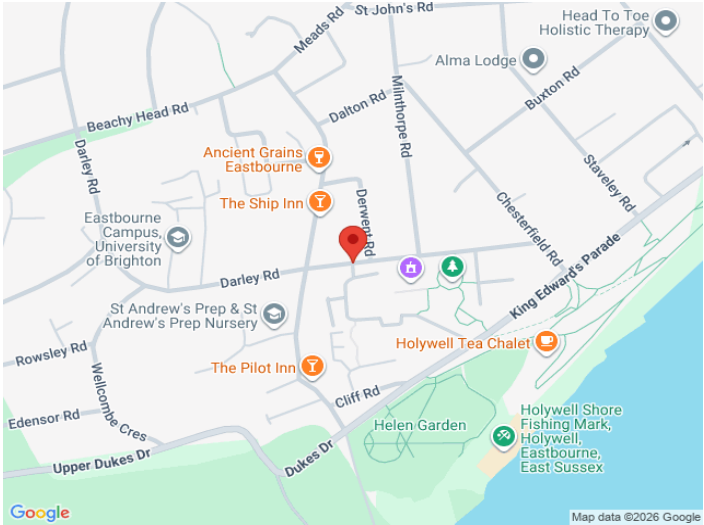

Northwood
81-83 South Street
Eastbourne
BN21 4LR
01323 744544
eastbourne@northwooduk.com

northwood
Local knowledge, national reach