



End Of Terrace Home

This mid-terraced 2 bedroom home in Cranbrook is definitely worth a look. Benefitting from NO ONWARD CHAIN, a kitchen dining room, spacious lounge, off road parking spaces and easy access to both the local town centre and the Country Park.

24 Yarlinton Mill | Exeter | EX5 7FJ





PROPERTY TYPE

2 Bedroom End Of Terrace



SIZE

613 sq ft



LOCATION
Cranbrook



AGE
Modern



BEDROOMS

2



RECEPTION ROOMS

1



BATHROOMS

1



WARMTH

EON District Heating
System



PARKING

Off Road Parking



OUTSIDE SPACE

Garden



EPC RATING

71 C



COUNCIL TAX BAND

C



in a nutshell...

- No Onward Chain
- 2 Off Road Parking Spaces
- Kitchen/Dining Room
- Enclosed Rear Garden
- Family Bathroom And Downstairs WC
- Freehold
- Easy access to M5 and A30
- Local Town Centre & Supermarket
- Excellent Transport Links





the details...

Welcome to the market this well-presented two-bedroom end-of-terrace property, ideally located in close proximity to the country park and benefiting from two allocated parking spaces.

Upon entering the property, you are welcomed into a neutral and inviting entrance hall with wood-effect laminate flooring. To your immediate left is the downstairs WC, fitted with a toilet and hand wash basin, finished to match the hallway flooring.

Continuing through, you will find the spacious living room, positioned at the front of the property and filled with natural light from the large window. This generously sized room offers ample space for a full range of living furniture, making it ideal for both relaxing and entertaining.

To the rear of the property, accessible via the lounge, is the kitchen/dining area. This space comfortably accommodates a dining table and chairs and is fitted with an integrated oven and electric hob, with additional space for a fridge freezer and washing machine. Patio doors from the kitchen open directly onto the garden, creating a seamless connection to the outdoor space, perfect for alfresco dining during the warmer months.



what the owner loves most...

The location is perfect for walking to all local amenities

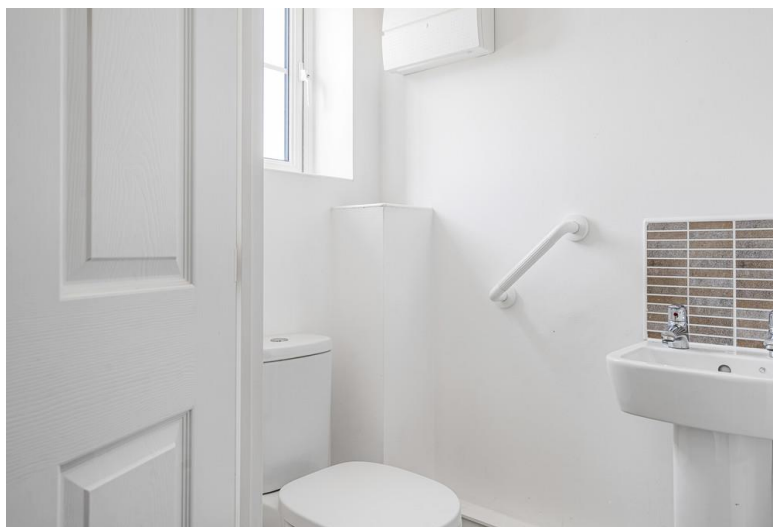

the floorplan...

Approximate Gross Internal Area 613 sq ft - 57 sq m

Ground Floor Area 315 sq ft – 29 sq m

First Floor Area 298 sq ft – 28 sq m

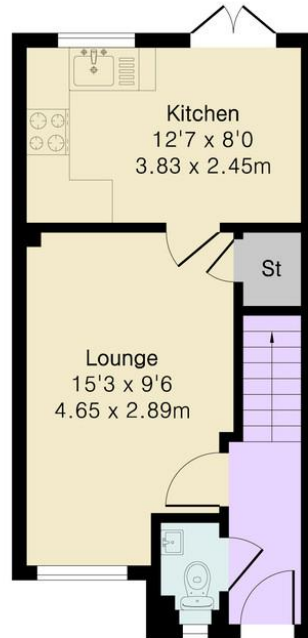

Ground Floor

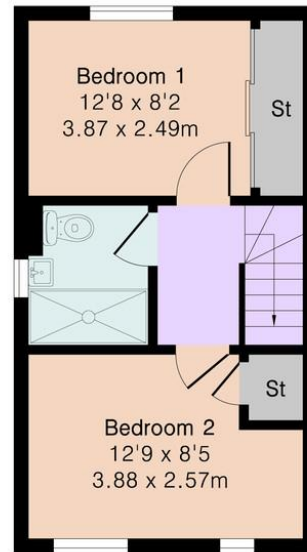

First Floor



Floor plan produced in accordance with RICS Property Measurement 2nd Edition. Although Pink Plan Ltd ensures the highest level of accuracy, measurements of doors, windows and rooms are approximate and no responsibility is taken for error, omission or misstatement. These plans are for representation purposes only and no guarantee is given on the total square footage of the property within this plan. The figure icon is for initial guidance only and should not be relied on as a basis of valuation.

complete.

Our note. For clarification we have prepared these sales particulars as a general guide and have not carried out a detailed survey nor tested the services, appliances or fittings. Room sizes should not be relied upon for carpets or furnishings. If there are any important matters which are likely to affect your decision to buy, please contact us before viewing this property. These particulars, whilst believed to be accurate, are set out as a general outline only for guidance and do not constitute any part of an offer or contract. Intending purchasers should not rely on them as statements of representation of fact, but must satisfy themselves by inspection or otherwise as to their accuracy. No person in the employment of Complete Property Services has the authority to make or give any representation or warranty in respect of the property.

SKETCH PLAN FOR ILLUSTRATIVE PURPOSES ONLY. All measurements and sizes and locations of walls, doors, window fittings and appliances are shown conventionally and are approximate only and cannot be regarded as being a representation either by the Seller or his Agent. We hope that these plans will assist you by providing you with a general impression of the layout of the accommodation. The plans are not to scale nor accurate in detail. © Unauthorised reproduction prohibited.

As part of the service we offer we may recommend ancillary services to you which we believe will help with your property transaction. We wish to make you aware that should you decide to proceed we will receive a referral fee. This could be a fee, commission, payment or other reward. We will not refer your details unless you have provided consent for us to do so. You are not under any obligation to provide us with your consent or to use any of these services, but where you do you should be aware of the following referral fee information. You are also free to choose an alternative provider. To find out more about this, please speak to a member of the team.



bear in mind...

This property is offered to the market with no onward chain!



Returning to the entrance hall, stairs lead to the first floor where you will find two double bedrooms, both offering good proportions and storage potential. The principal bedroom benefits from an integrated wardrobe, which can be included with the property, while the second bedroom is currently presented unfurnished, providing a blank canvas for buyers.

Externally, the rear garden is arranged over two levels. The lower level features patio slabs, with steps leading up to an astro-turfed area and a raised decking section-ideal for enjoying the sun and outdoor entertaining.

Further benefits include two allocated parking spaces to the front of the property and the advantage of being offered with no onward chain.

Tenure: Freehold
Council Tax Band: C





Need a more complete picture? Get in touch with your local branch...

Tel **01392 422500**
Email exeter@completeproperty.co.uk
Web completeproperty.co.uk

Complete
141 Younghayes Rd
Cranbrook
EX5 7DR

Are you selling a property too? Call us to get a set of property details like these...

selling

letting

land &
new homes

signature
homes

complete.