



Bernard Avenue, W13

£950,000

An Edwardian three bedroom house with a large South facing garden.

Ideal for new owners looking to renovate to their own taste.

Also comprises entrance hall, two interconnecting receptions, kitchen, garden room and bathroom.

Many neighbouring houses have been extended into the loft.

Located in arguably the best spot in Northfields close to the shops, Lamma Park and outstanding schools including Fielding and Mount Carmel Primaries.

Features

- Edwardian House
- Three Bedrooms
- South Facing Garden
- Renovation Opportunity
- Excellent Schools
- No Onward Chain

Bernard Avenue, London, W13

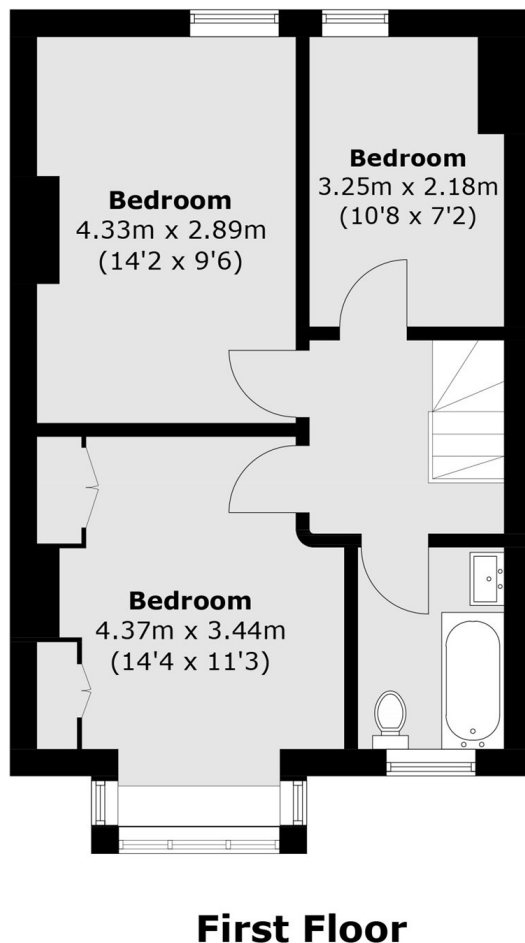
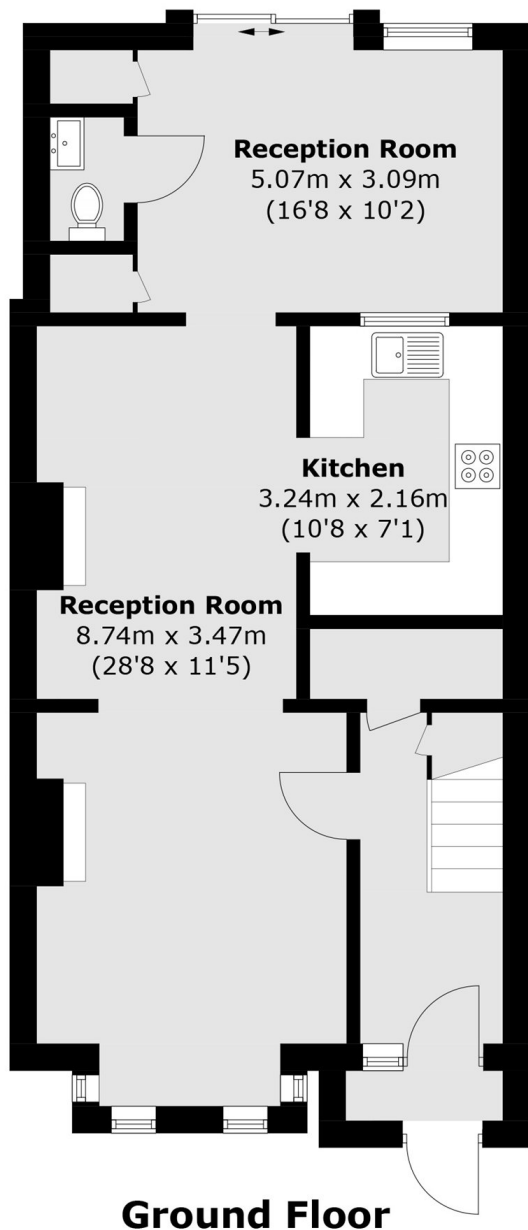

Total area (approx.): 104.5 sq. m (1124 .8 sq. ft)