



## Brockley Road, SE4

£2,000 Per calendar month

A well presented first floor flat comprising an open plan kitchen/reception that leads to a private balcony, two double bedrooms and a modern bathroom with a walk-in shower.

Conveniently located for Crofton Park, Brockley and Ladywell train stations and the open spaces of Blythe Hill, Hilly Fields and Brockwell. The great independent cafés and shops of Crofton Park are located on your door step.

### Features

- Second Floor Flat
- Open Plan Kitchen/Reception
- Private Balcony
- Two Double Bedrooms
- Modern Bathroom
- Excellent Location

Brockley Road,  
London, SE4

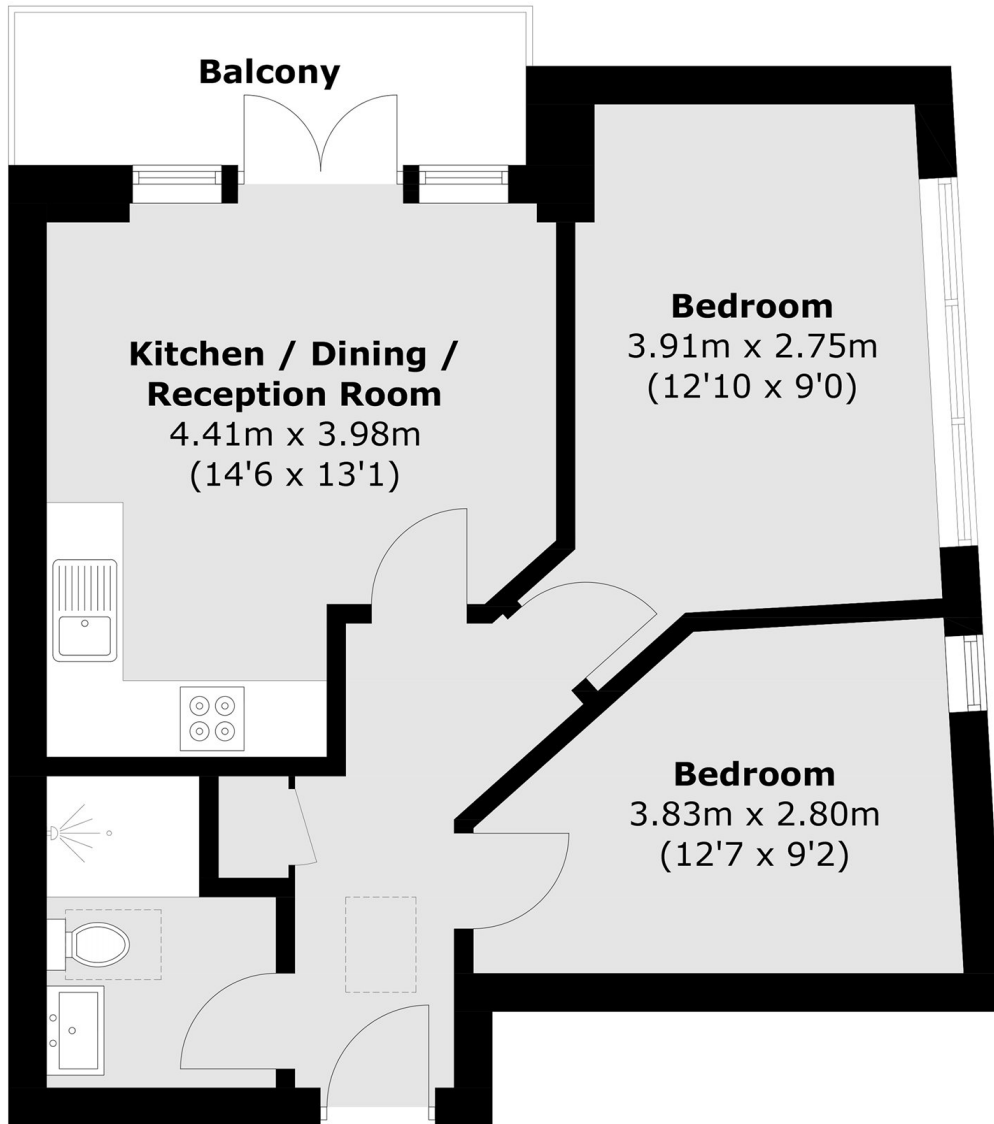

Total area (approx.): 47.8 sq. m (514.5 sq. ft)  
Balcony area (approx.): 4.8 sq. m (51.7 sq. ft)

**Dexters**

Lewisham  
228 Algernon Road  
London  
SE13 7AG

Lettings  
0208 690 8020

Energy Rating: B. We aim to make our particulars both accurate and reliable. However they are not guaranteed; nor do they form part of an offer or contract. If you require clarification on any points then please contact us, especially if you're traveling some distance to view. Please note that appliances and heating systems have not been tested and therefore no warranties can be given as to their good working order.

 **RICS** | Regulated  
Estate Agent  
and Letting Agent

[dexters.co.uk](http://dexters.co.uk)