



Bridge Avenue | Walsall | WS6 7EP

£1,100 PCM

 **Webbs**
estate agents

Summary

Webbs Estate Agents are delighted to offer to let this immaculately presented semi-detached house, situated in a popular and sought-after location, being within in close proximity to shops, schools, and local amenities.

In brief, this stunning property comprises of; an entrance porch, lounge, contemporary kitchen, three generous bedrooms, and a family bathroom.

Externally the property benefits from a driveway, garage, and enclosed garden to the rear.

Key Features

Rooms and Dimensions

PROPERTY DETAILS:

Entrance Hallway

Lounge

15'8" x 9'10" (4.78 x 3.02)

Dining Room

10'7" x 7'8" (3.25 x 2.34)

Kitchen

7'4" x 7'8" (2.24 x 2.34)

Landing

Bedroom One

12'0" x 10'7" (3.68 x 3.25)

Bedroom Two

10'7" x 10'7" (3.23 x 3.23)

Bedroom Three

8'11" x 7'8" (2.72 x 2.36)

Garden

Garage

TENANCY INFORMATION & IMPORTANT NOTES





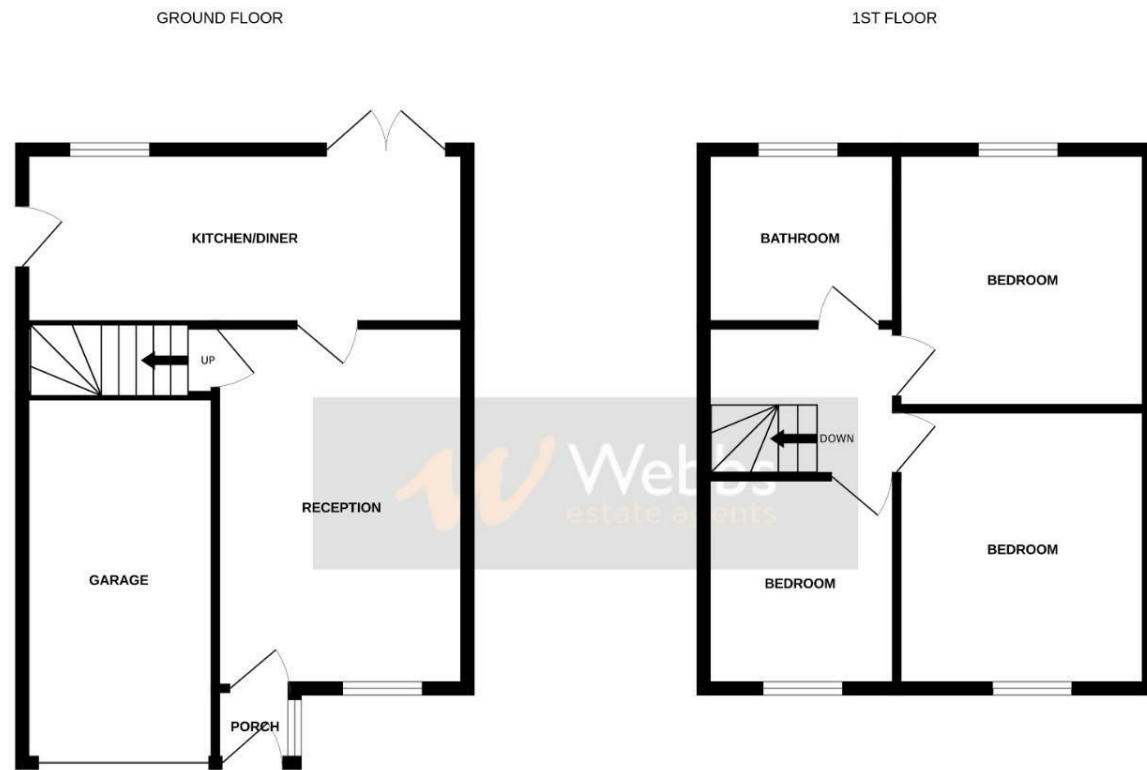

Whilst every attempt has been made to ensure the accuracy of the floorplan contained here, measurements of doors, windows, rooms and any other items are approximate and no responsibility is taken for any error, omission or mis-statement. This plan is for illustrative purposes only and should be used as such by any prospective purchaser. The services, systems and appliances shown have not been tested and no guarantee as to their operability or efficiency can be given.
Made with Metropix ©2023

Webbs Estate Agents - endeavour to maintain accurate depictions of properties in Virtual Tours, Floor Plans and descriptions, however, these are intended only as a guide and purchasers must satisfy themselves by personal inspection.

Energy Efficiency Rating		Environmental Impact (CO ₂) Rating	
Current	Potential	Current	Potential
<p>Key Average Annual Total Energy Costs</p> <p>14,000 A</p> <p>15,000 B</p> <p>16,000 C</p> <p>17,000 D</p> <p>18,000 E</p> <p>19,000 F</p> <p>20,000 G</p>	<p>71</p> <p>77</p>	<p>Key Annual CO₂ Emissions</p> <p>10,000 A</p> <p>11,000 B</p> <p>12,000 C</p> <p>13,000 D</p> <p>14,000 E</p> <p>15,000 F</p> <p>16,000 G</p>	
<p>England & Wales EU Directive 2002/91/EC</p>		<p>England & Wales EU Directive 2002/91/EC</p>	

153 Avon Road, Cannock, WS11 1LF

Tel: 01543 468846 | Email: sales@webbestateagents.co.uk | www.webbestateagents.co.uk

