

Vicarage House, Cambridge Road, Kingston Upon Thames, KT1

Offers Over £350,000

2 1

A spacious and well-presented two double bedroom apartment located in a highly convenient position in Kingston upon Thames. The property offers a bright reception room, separate kitchen, two genuine double bedrooms and a family bathroom with separate WC. Ideally situated within easy reach of Kingston town centre, mainline stations and excellent local amenities.

<p>Floor Area 710 sq. ft.</p> <p>Tenure Share Of Freehold</p> <p>Service Charge £1140 per annum</p> <p>Ground Rent £10 per annum</p>
--

- Two Genuine Double Bedrooms
- Bright and Spacious Reception Room
- Separate Kitchen with Good Storage and Worktop
- Bathroom with Separate WC
- Prime Kingston upon Thames location
- Easy Access to Kingston Station and Town Centre
- Off-street Parking
- Private Balcony providing Outdoor Space
- Multiple Storage Areas Throughout
- USE REFERENCE CODE - MC1212



Age	Energy Rating	Current	Desired
92+	A		
81-91	B		
69-80	C	75 C	80 C
55-68	D		
39-54	E		
21-38	F		
1-20	G		

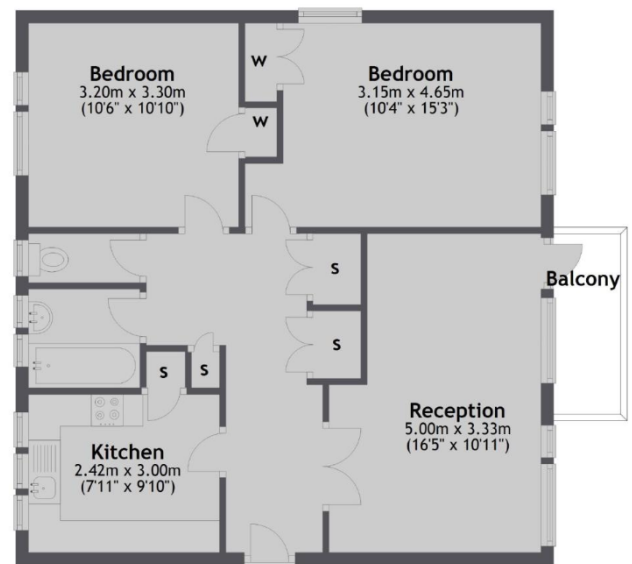

Total area: approx. 66.7 sq. metres (718.3 sq. feet)