

BRENNAN

BESPOKE

£350,000

The Drive

Northampton, NN1 4SP

PROPERTY SUMMARY

A lovely 1930s three bedroom semi detached home, ideally located on The Drive in Northampton, offering a fantastic blend of character features, practical family space and a beautifully mature private garden. With a garage and driveway parking, this is a home that has been cared for and offers a warm, welcoming feel throughout.

The ground floor begins with an entrance hall leading through to the main lounge, where a bay fronted window and a log burner create a cosy focal point and a great space to relax. To the rear, the kitchen diner provides plenty of room for everyday meals and entertaining, and flows through into a sun room which offers a versatile additional living area with access out to the garden. Upstairs, there are two double bedrooms and a further single bedroom, along with the family bathroom. The master bedroom also benefits from a bay fronted window, adding to the period charm and sense of space. Outside, the property continues to impress with a driveway, garage and a private rear garden that is wonderfully established, filled with mature trees and an abundance of flowers, creating a peaceful setting to enjoy throughout the seasons.

3



1



2





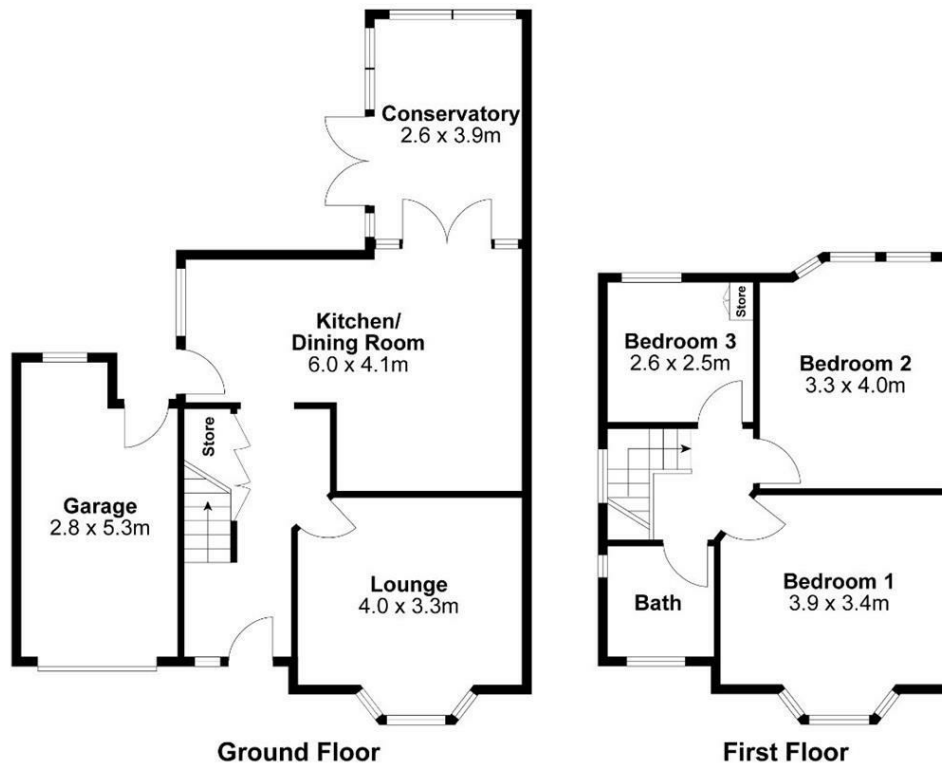

Internal Area Approx. : 1248 ft²

For identification only not to scale

BRENNAN
BESPOKE

BRENNAN
BESPOKE

OFFICE ADDRESS
BRENNAN BESPOKE
2 The Tithe Barn Glendon Lodge Farm
Glendon
Kettering
Northamptonshire
NN14 1QF

OFFICE DETAILS
01536 904400
info@brennanbespoke.co.uk
https://www.brennanbespoke.co.uk

LOCAL AUTHORITY
North Northamptonshire

TENURE
Freehold

COUNCIL TAX BAND
C

VIEWINGS
By prior appointment only

Energy Efficiency Rating		
	Current	Potential
<i>Very energy efficient - lower running costs</i>		
(92 plus) A		
(81-91) B		
(69-80) C		
(55-68) D		
(39-54) E		
(21-38) F		
(1-20) G		
<i>Not energy efficient - higher running costs</i>		
England & Wales	EU Directive 2002/91/EC	

Agents Note: Whilst every care has been taken to prepare these particulars, they are for guidance purposes only. All measurements are approximate and are for general guidance purposes only and whilst every care has been taken to ensure their accuracy, they should not be relied upon and potential buyers/tenants are advised to recheck the measurements