

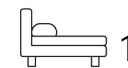

Living
made
better

Westgate Apartments
Canning Town, E16 1BN



Asking Price £275,000

Westgate Apartments, Canning Town, E16 1BN

Madison Brook

Property Summary

A well-presented one-bedroom apartment located on the 10th floor of the sought-after Westgate Apartments, ideally positioned close to the Elizabeth Line and DLR offering approximately 502 sq. ft., the property comprises a bright reception/dining room, separate fitted kitchen, generous double bedroom, modern bathroom and useful storage. Residents benefit from a 24-hour concierge, gymnasium, and communal gardens, making this an excellent home or investment opportunity. Conveniently located for Canary Wharf, the City and London City Airport, the apartment is offered in excellent condition with a 173-year lease remaining.

Lease Remaining: 173 years | Ground Rent: £350.00 | Service Charge: £1,033.84

Floorplan

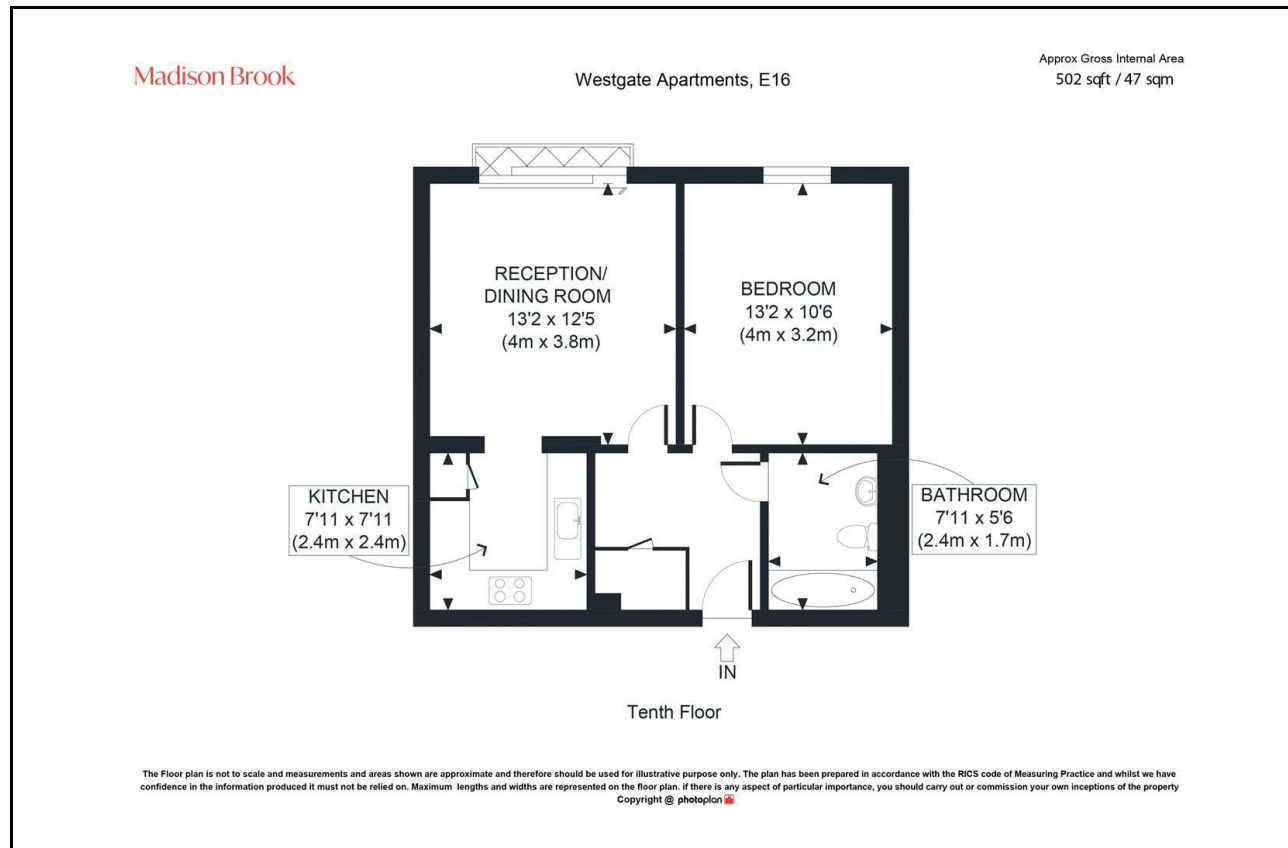

Area Map

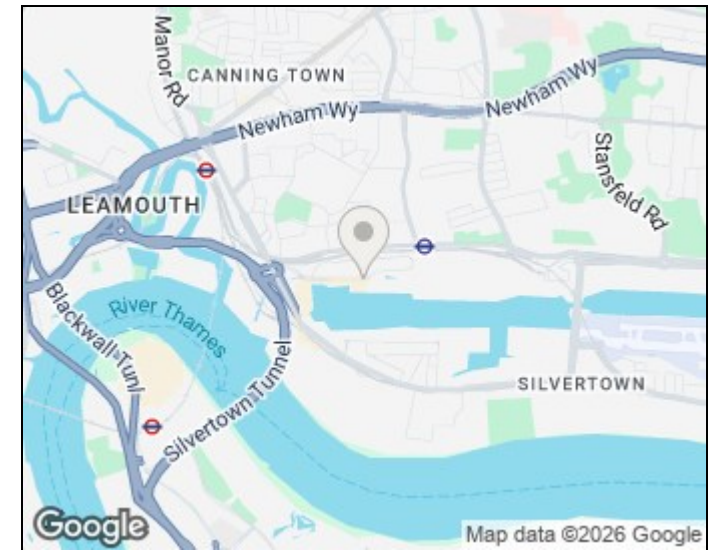

Energy Efficiency Graph

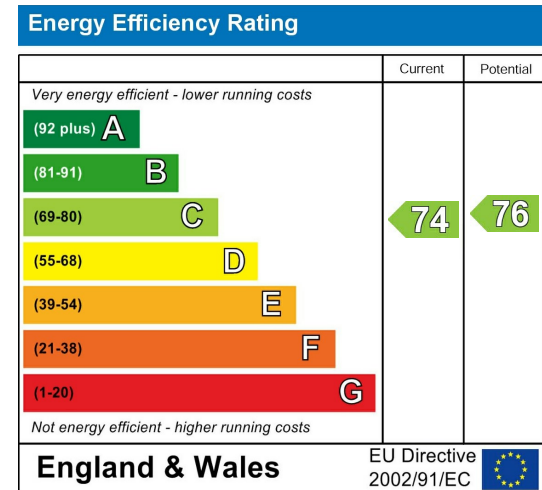

These particulars, whilst believed to be accurate are set out as a general outline only for guidance and do not constitute any part of an offer or contract. Intending purchasers should not rely on them as statements of representation of fact, but must satisfy themselves by inspection or otherwise as to their accuracy. No person in this firm's employment has the authority to make or give any representation or warranty in respect of the property.

Unit B 20 Western Gateway, Royal Victoria
Dock, London, E16 1BS
Tel: 020 3946 6000 Email:
docklands@madisonbrook.com
<https://madisonbrook.com/>