



**Aspley Lane, Nottingham NG8 5RX**

**welcome to**

**Aspley Lane, Nottingham**

**\*\*IDEAL FOR A RANGE OF BUYERS\*\* WELL-PRESENTED THREE BEDROOM MID-TERRACED property located on Aspley Lane with GROUND FLOOR SHOWER ROOM and ENCLOSED REAR GARDEN. CLOSE PROXIMITY TO KING GEORGE V PLAYING FIELDS and SHORT JOURNEY TO ASDA SUPERMARKET.**





**Ground Floor**

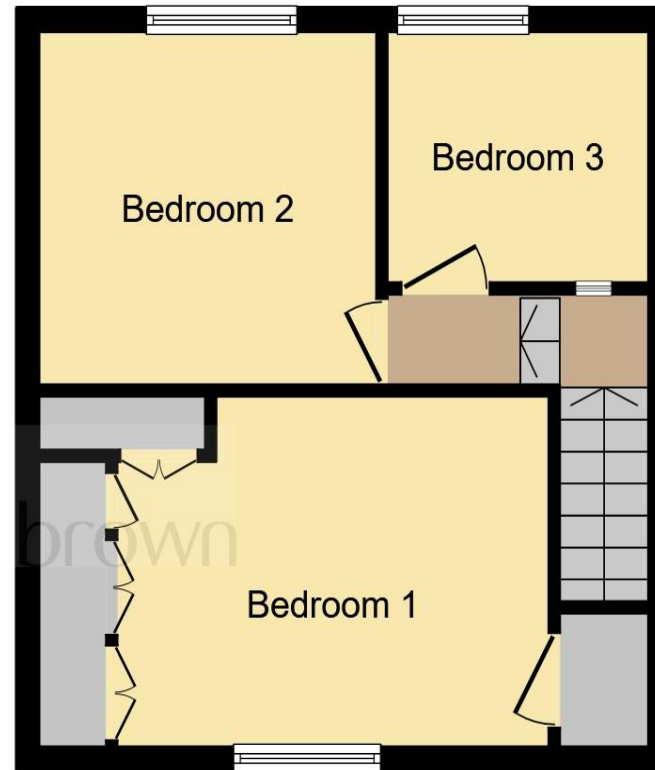

**First Floor**

**Living Room**

14' 4" MAX x 11' MAX ( 4.37m MAX x 3.35m MAX )

**Kitchen**

11' 2" MAX x 8' 3" MAX ( 3.40m MAX x 2.51m MAX )

**Bedroom One**

14' 7" MAX x 9' 8" MAX ( 4.45m MAX x 2.95m MAX )

**Bedroom Two**

10' MAX x 9' 9" MAX ( 3.05m MAX x 2.97m MAX )

**Bedroom Three**

6' 11" MAX x 7' 10" MAX ( 2.11m MAX x 2.39m MAX )

This floor plan is for illustrative purposes only. It is not drawn to scale. Any measurements, floor areas (including any total floor area), openings and orientation are approximate. No details are guaranteed, they cannot be relied upon for any purpose and they do not form part of any agreement. No liability is taken for any error, omission or misstatement. A party must rely upon its own inspection(s). Powered by [www.focalagent.com](http://www.focalagent.com)

welcome to

## Aspley Lane, Nottingham

- Council Tax Band: A
- \*\*\* GUIDE PRICE £190,000 - £200,000 \*\*\*
- THREE BEDROOM MID-TERRACED PROPERTY
- DRIVEWAY TO FRONT WITH NO DROPPED KERB ACCESS
- GROUND FLOOR SHOWER ROOM

Tenure: Freehold EPC Rating: C

Council Tax Band: A

guide price

**£190,000**



Please note the marker reflects the postcode not the actual property

**view this property online** [williamhbrown.co.uk/Property/NVS119377](https://williamhbrown.co.uk/Property/NVS119377)



Property Ref:  
NVS119377 - 0003

1. MONEY LAUNDERING REGULATIONS Intending purchasers will be asked to produce identification documentation at a later stage and we would ask for your co-operation in order that there is no delay in agreeing the sale. 2. These particulars do not constitute part or all of an offer or contract. 3. The measurements indicated are supplied for guidance only and as such must be considered incorrect. Potential buyers are advised to recheck measurements before committing to any expense. 4. We have not tested any apparatus, equipment, fixtures or services and it is in the buyers interest to check the working condition of any appliances. 5. Where an EPC, or a Home Report (Scotland only) is held for this property, it is available for inspection at the branch by appointment. If you require a printed version of a Home Report, you will need to pay a reasonable production charge reflecting printing and other costs. 6. We are not able to offer an opinion either written or verbal on the content of these reports and this must be obtained from your legal representative. 7. Whilst we take care in preparing these reports, a buyer should ensure that his/her legal representative confirms as soon as possible all matters relating to title including the extent and boundaries of the property and other important matters before exchange of contracts.

William H Brown is a trading name of Sequence (UK) Limited which is registered in England and Wales under company number 4268443, Registered Office is Cumbria House, 16-20 Hockliffe Street, Leighton Buzzard, Bedfordshire, LU7 1GN. VAT Registration Number is 500 2481 05.



william h brown



**01159 587766**



[nottingham@williamhbrown.co.uk](mailto:nottingham@williamhbrown.co.uk)



20 Upper Parliament Street, NOTTINGHAM,  
Nottinghamshire, NG1 2AD



**[williamhbrown.co.uk](https://williamhbrown.co.uk)**