

Kesworth Drive, Priorslee, Telford, TF2 9TE

£194,995

Council Tax Band: B



Nestled in the sought-after area of Priorslee, this charming two-bedroom mid-terrace house on Kesworth Drive offers a delightful blend of comfort and convenience. Situated at the end of a peaceful cul-de-sac, this property is perfect for those seeking a tranquil living environment while still being close to local amenities.

Upon entering, you are welcomed into a spacious reception room that provides a warm and inviting atmosphere, ideal for both relaxation and entertaining. The well-appointed kitchen is designed for practicality, making meal preparation a pleasure. The two bedrooms are generously sized, providing ample space for rest and personalisation, while the bathroom is conveniently located to serve both rooms.

One of the standout features of this property is the parking arrangement, which includes a single garage and an allocated parking space.

For those who commute, the nearby Wolverhampton - Shrewsbury Line, with the closest station being Oakengates, offers excellent transport links, making it easy to travel to surrounding areas. The vibrant community of Priorslee is known for its friendly atmosphere and access to local parks, shops, and schools, making it an ideal choice for families and professionals alike.

In summary, this mid-terrace house on Kesworth Drive presents a wonderful opportunity to own a home in a popular location, combining modern living with the charm of a close-knit community. Don't miss your chance to make this delightful property your own.



Open House Whitchurch

Ground Floor

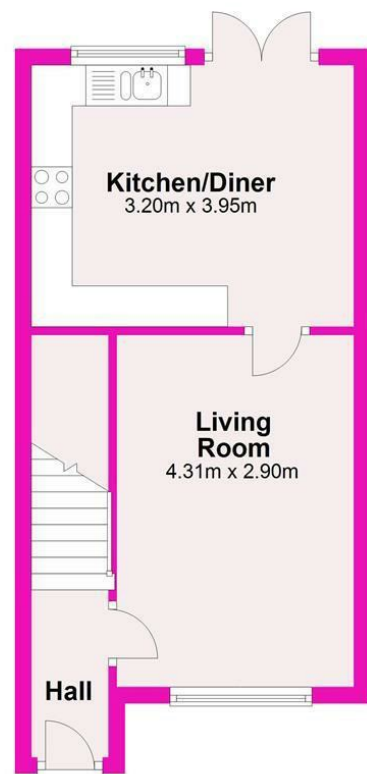

All sizes are approximate and are not to be taken literally.
Plan produced using PlanUp.



Energy Efficiency Rating		Current	Potential
Very energy efficient - lower running costs			
(92 plus) A			
(81-91) B			
(69-80) C		75	80
(55-68) D			
(39-54) E			
(21-38) F			
(1-20) G			
Not energy efficient - higher running costs			
England & Wales		EU Directive 2002/91/EC	