

Whilst every attempt has been made to ensure the accuracy of the floor plan and details contained here, measurements of doors, windows, rooms and any other items are approximate and no responsibility is taken for any error, omission, or mis-statement. This plan is for illustrative purposes only and should be used as such by any prospective purchaser. The services, systems and appliances shown have not been tested and have no guarantee as to their operability or efficiency can be given. Floor plan made with Metropix 2014. Fixtures and fittings may vary at point of sale.

Whilst every attempt has been made to ensure the accuracy of the floor plan and details contained here, measurements of doors, windows, rooms and any other items are approximate and no responsibility is taken for any error, omission, or mis-statement. This plan is for illustrative purposes only and should be used as such by any prospective purchaser. The services, systems and appliances shown have not been tested and have no guarantee as to their operability or efficiency can be given. Floor plan made with Metropix 2014.

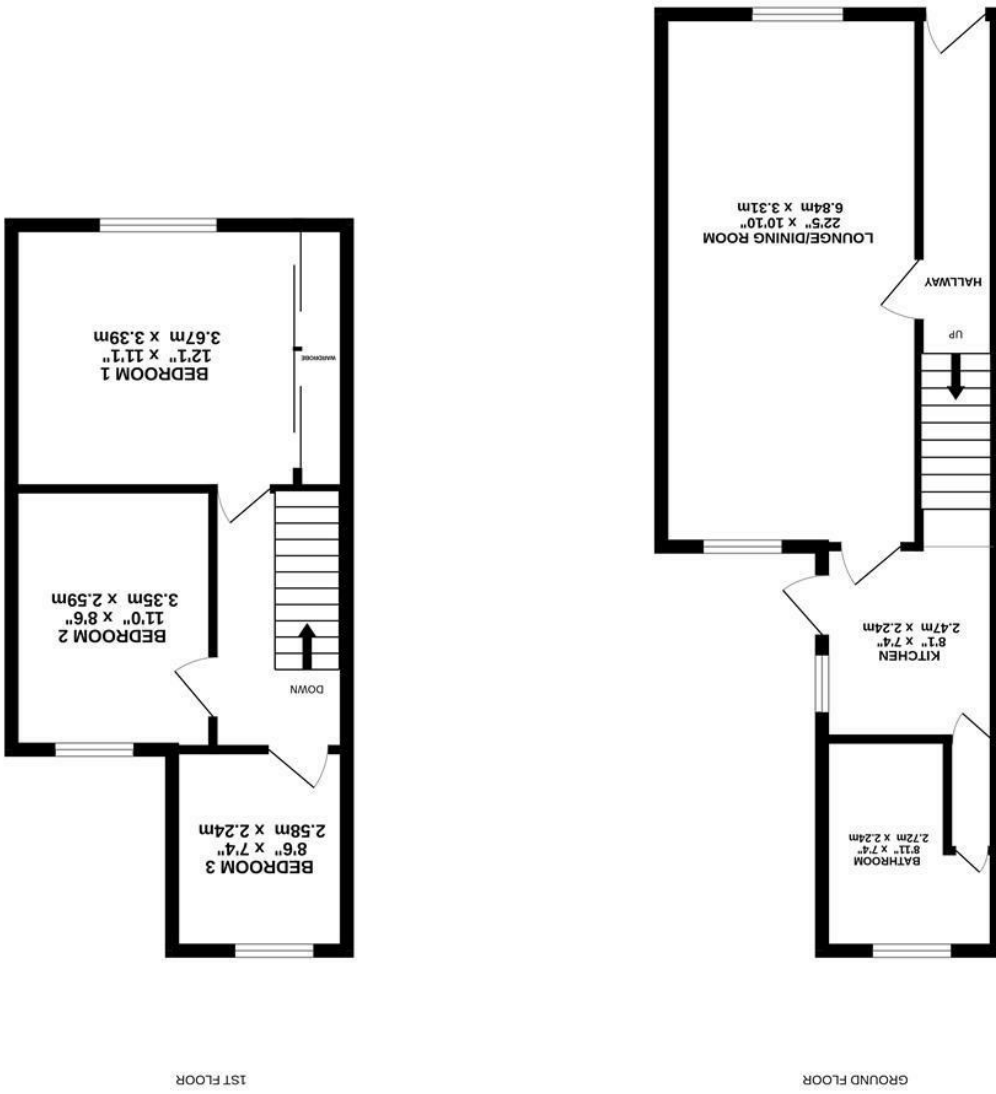

Corby
1A SPENCER COURT
CORBY
NORTHAMPTONSHIRE
NN17 1BH

Thrapston
22 HIGH STREET
THRAPSTON
NORTHAMPTONSHIRE
NN14 4JH

Rothwell
30 HIGH STREET
ROTHWELL
NORTHAMPTONSHIRE
NN14 6BQ

Kettering
12B HORSEMARKET
KETTERING
NORTHAMPTONSHIRE
NN16 0DQ



22 Cambridge Street, Kettering, NN16 8NY
Offers over £185,000



Offered to the market is this three bedroom terraced home, ideally situated on Cambridge Street in the heart of Kettering. The accommodation comprises a spacious open-plan living and dining area, a fitted kitchen, three bedrooms, and a family bathroom. Externally, the property benefits from an enclosed rear garden, with lawn, a patio seating area and a useful concrete storage shed.

Upon entering the property, the entrance hall provides access to the ground floor accommodation, along with stairs rising to the first floor. The living/dining room extends over six metres in length, offering ample space for both lounge and dining furniture, and is enhanced by an exposed brick fireplace serving as an attractive focal point. The kitchen is fitted with a range of eye- and base-level units, along with an integral gas hob and oven. There is also space for additional appliances, including a washing machine and fridge freezer. The family bathroom is located to the rear and is fitted with a bath with shower over, low-level WC, and wash hand basin. To the first floor, the landing provides access to all three bedrooms, two of which are generous doubles. The master bedroom spans the full width of the property and benefits from built-in wardrobes.

