

Whitbarrow Road, Lymm, Cheshire, WA13 9AW

£1,750,000

6

4

3



An exceptional individually designed six-bedroom detached family residence occupying a generous private plot within walking distance of Lymm village and enjoying an enviable position opposite Lymm Fisheries and Golf Club. Finished to an impressive standard throughout, the property offers three floors of beautifully appointed accommodation, including a spectacular open-plan living kitchen with vaulted ceilings and bi-fold doors, multiple reception rooms, a luxurious principal suite with dressing area and ensuite, three further bath/shower rooms, integrated AV and security systems, and a detached double garage. Externally, electrically operated wrought iron gates open onto extensive parking, whilst beautifully landscaped South-

facing gardens provide superb outdoor entertaining and family space. Internal viewing is essential to fully appreciate the size, quality and lifestyle this outstanding home has to offer.

Key Features

- Individually designed detached residence
- Walking distance to Lymm village
- Principal suite with dressing room and luxury ensuite
- Detached double garage
- South-facing landscaped gardens
- Six bedrooms and four bathrooms
- Spectacular open-plan living kitchen
- Multiple reception rooms
- Gated plot with extensive parking
- Integrated AV system, CCTV and solar panels

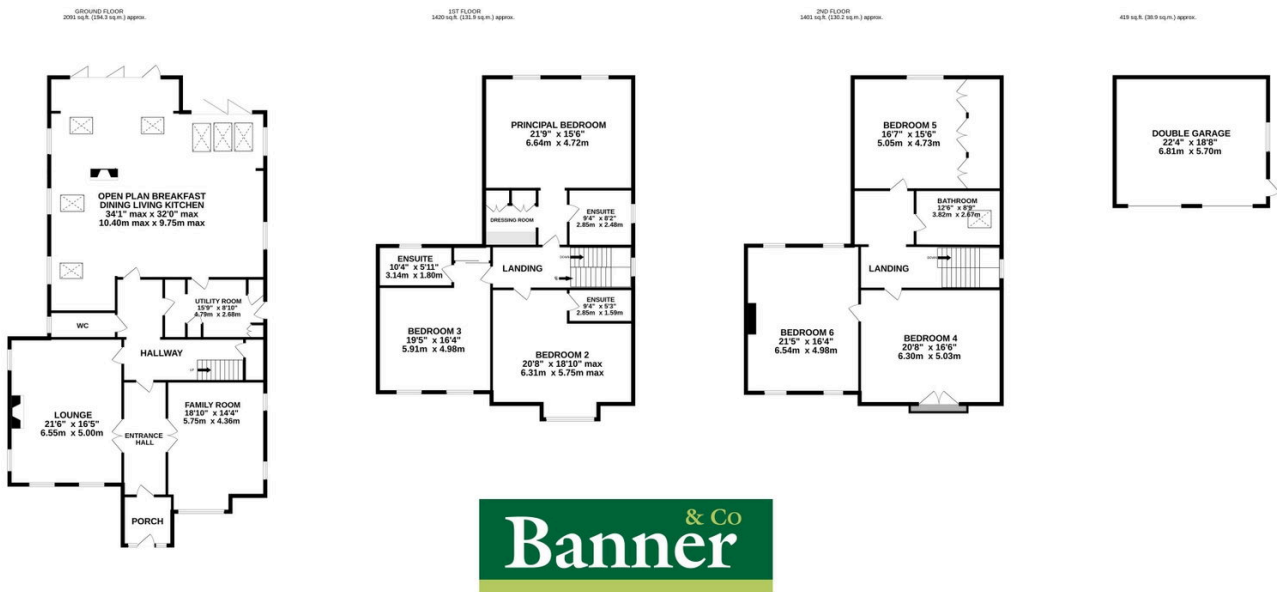

TOTAL FLOOR AREA: 5332 sq.ft. (495.3 sq.m.) approx.

Whilst every attempt has been made to ensure the accuracy of the floorplan contained here, measurements of doors, windows, rooms and any other items are approximate and no responsibility is taken for any error, omission or mis-statement. This plan is for illustrative purposes only and should be used as such by any prospective purchaser. The services, systems and appliances shown have not been tested and no guarantee as to their operability or efficiency can be given.

Made with Metropix ©2026