



Goldhurst Terrace, South Hampstead, NW6
£1,300 pcm

Goldhurst Terrace, South Hampstead, NW6

*****HEATING AND HOT WATER INCLUDED*****

This is a fantastic apartment set on the second floor of well maintained period house in the heart of West Hampstead. The property has been redecorated throughout and offers full size kitchen, high ceiling and large windows.

The property is located in West/South Hampstead area a short walk from both West Hampstead and Finchley Road. Both areas have fantastic transport links and local amenities and a wide range of bars and restaurants to suit all tastes. We now have the farmers market on a Saturday on the plaza at the new Thameslink station which provides a wide range of fresh produce.

In terms of transport West Hampstead boasts some of the best connectivity in London with the Jubilee Line, Overground and Thameslink stations allowing quick access in and out of London. You also have the Metropolitan and Jubilee Line from Finchley Road. The North Circular A406 and M1 motorway are also within easy reach.





Goldhurst Terrace, NW6 3HR

Approx Gross Internal Area = 20.49 sq m / 221 sq ft

Shared Shower Room = 6.64 sq m / 71 sq ft

Shared W.C. = 1.76 sq m / 19 sq ft

Total = 28.89 sq m / 311 sq ft

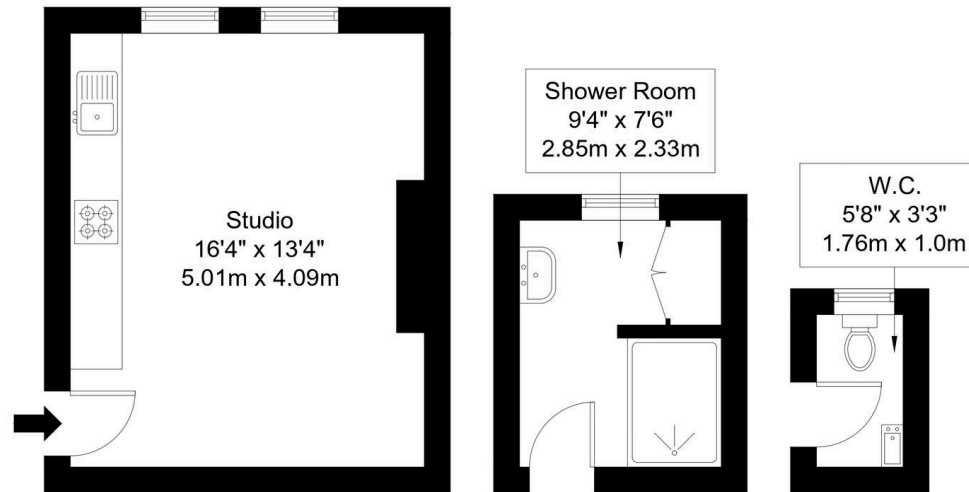
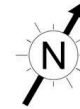

Second Floor

Ref :

Copyright **BLEU
PLAN**

The Floor plan is not to scale and measurements and areas shown are approximate and therefore should be used for illustrative purposes only. The plan has been prepared in accordance with the RICS code of Measuring Practice and whilst we have confidence in the information produced it must not be relied on. Maximum lengths and widths are represented on the floor plan. If there is any aspect of particular importance, you should carry out or commission your own inspection of the property.

Copyright @ BLEUPLAN



Black Katz

22 West Hampstead Mews, London - NW6 3BB

02073285000 • Thomas@blackkatz.com • blackkatz.com/