



Price
£125,000

Leasehold

1x  1x  1x 

**Woodlands Court,
Walderslade Road,
Walderslade, Chatham,
Kent, ME5**

OVER 60?

Secure this property
for up to **59% less!**

Wards
Helping you move forwards



Main features

- Retirement apartment for over 60's, central Walderslade Village location
- Residential communal lounge area
- Direct access to communal garden
- Residents parking available
- No chain

Accommodation

GROUND FLOOR

Communal Entrance

SECOND FLOOR

Entrance Hall

Shower Room : 6'10 x 5'5 (2.08m x 1.65m)

Lounge/Diner: 24'10 x 10'8 (7.57m x 3.25m)

Bedroom : 15'0 x 9'1 (4.58m x 2.77m)

Kitchen : 8'2 x 7'7 (2.49m x 2.31m)

OUTSIDE

Communal Garden

Communal Parking Area

Second Floor

Approx. 49.4 sq. metres (531.7 sq. feet)

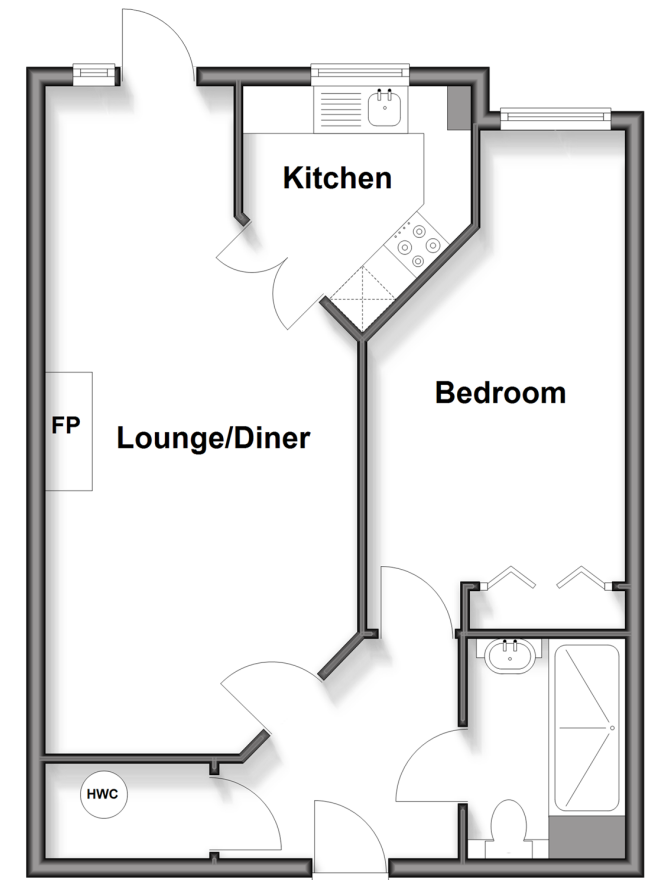

Call Walderslade - 01634 865661 ■ wardsofkent.co.uk

- Legal advice should be taken to verify fixtures/fittings, planning, alterations and/or lease details
- Appliances & services are untested, dimensions are approximate and floor plans are not to scale
- Through a Homewise Home For Life Plan people aged 60+ can secure this property for up to 50% less, by purchasing a Lifetime Lease.



12144649/20251009/ML/AJB