



Sands Lane, Lowestoft NR32 3HA

welcome to

Sands Lane, Lowestoft

A four bedroom semi-detached house in Lowestoft featuring a lounge with sliding doors to a conservatory, kitchen with access to the dining room, ground floor WC and a family bathroom, with all bedrooms accessed from the first floor landing. Please call on 01502 585998 to book your viewing!

Entrance Hall

Access to kitchen, ground floor Wc, lounge, and first floor. Wood effect flooring. Radiator. Power points.

Ground Floor Wc

Double glazed window to front. Carpet flooring. Wash hand basin. Wc.

Lounge

18' 3" x 11' 9" (5.56m x 3.58m)

Access to conservatory via double glazed sliding door. Carpet flooring. Radiator. Power points.

Conservatory

18' 3" x 7' 11" (5.56m x 2.41m)

Double glazed door to rear. Double glazed windows surround. Access to garden. Laminate flooring. Integrated storage cupboard.

Kitchen

10' 4" x 9' 7" (3.15m x 2.92m)

Double glazed window to side. Access to dining room. Wood effect flooring. Fitted units and worktops. Integrated electric oven and grill. Gas hobs with extractor fan. Plumbing for washing machine. Space for fridge. Boiler. Power points.

Dining Room

12' 9" x 9' 1" (3.89m x 2.77m)

Double glazed window to side. Carpet flooring. Radiator. Power points.

Landing

Access to all bedrooms, bathroom and storage cupboard. Carpet flooring. Power points.

Bedroom One

11' 8" x 10' 2" (3.56m x 3.10m)

Double glazed window to side. Carpet flooring.

Integrated wardrobe storage. Radiator. Power points.

Bedroom Two

11' 9" x 7' 10" (3.58m x 2.39m)

Double glazed window to side. Carpet flooring. Radiator. Power points.

Bedroom Three

10' 7" x 9' 1" (3.23m x 2.77m)

Double glazed window to side. Carpet flooring. Integrated wardrobes storage. Radiator. Power points.

Bedroom Four

9' 7" x 9' 1" (2.92m x 2.77m)

Double glazed window to side. Vinyl flooring. Storage shelves. Radiator. Power points.

Bathroom

Double glazed window to front. Loft access. Tiled flooring. Gas heated towel radiator. Wash hand basin. Wc. Vanity unit. Walk-in shower cubicle.

Front Garden

Grass plot with laid concrete path leading to entrance. Mix of fence surround and brick wall.

Rear Garden

Patio tiles covering whole plot. Access to garage. Fence surrounding. Outside tap.





view this property online williamhbrown.co.uk/Property/LOW109730



welcome to

Sands Lane, Lowestoft

- Four bedroom semi-detached house
- Entrance hallway
- Lounge with sliding doors to the conservatory
- Conservatory offering additional living space
- Kitchen with access to the dining room

Tenure: Freehold EPC Rating: Awaiting

Council Tax Band: B

£250,000

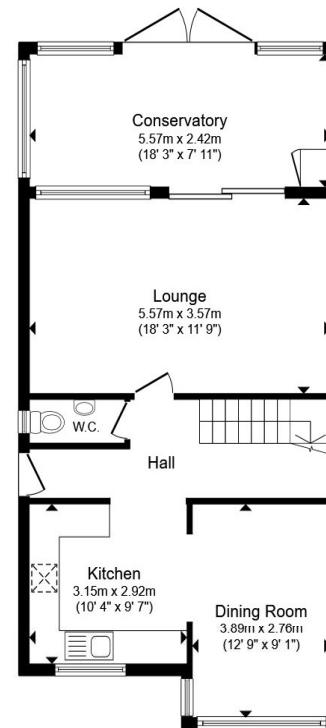

Ground Floor

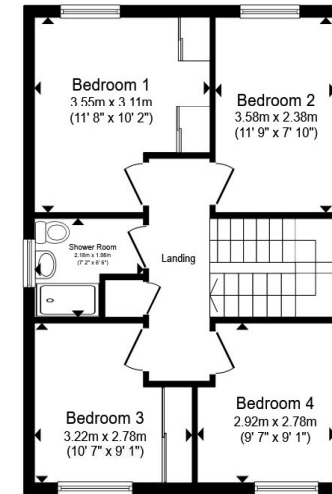

First Floor

Total floor area 120.5 m² (1,297 sq.ft.) approx

This floor plan is for illustrative purposes only. It is not drawn to scale. Any measurements, floor areas (including any total floor area), openings and orientation are approximate. No details are guaranteed, they cannot be relied upon for any purpose and they do not form part of any agreement. No liability is taken for any error, omission or misstatement. A party must rely upon its own inspection(s). Powered by www.propertybox.io



view this property online williamhbrown.co.uk/Property/LOW109730



Property Ref:
LOW109730 - 0004

1. MONEY LAUNDERING REGULATIONS Intending purchasers will be asked to produce identification documentation at a later stage and we would ask for your co-operation in order that there is no delay in agreeing the sale. 2. These particulars do not constitute part or all of an offer or contract. 3. The measurements indicated are supplied for guidance only and as such must be considered incorrect. Potential buyers are advised to recheck measurements before committing to any expense. 4. We have not tested any apparatus, equipment, fixtures or services and it is in the buyers interest to check the working condition of any appliances. 5. Where an EPC, or a Home Report (Scotland only) is held for this property, it is available for inspection at the branch by appointment. If you require a printed version of a Home Report, you will need to pay a reasonable production charge reflecting printing and other costs. 6. We are not able to offer an opinion either written or verbal on the content of these reports and this must be obtained from your legal representative. 7. Whilst we take care in preparing these reports, a buyer should ensure that his/her legal representative confirms as soon as possible all matters relating to title including the extent and boundaries of the property and other important matters before exchange of contracts.

William H Brown is a trading name of Sequence (UK) Limited which is registered in England and Wales under company number 4268443. Registered Office is Cumbria House, 16-20 Hockliffe Street, Leighton Buzzard, Bedfordshire, LU7 1GN. VAT Registration Number is 500 2481 05.

william h brown



01502 585998



Lowestoft@williamhbrown.co.uk



138 London Road North, LOWESTOFT, Suffolk,
NR32 1HB



williamhbrown.co.uk