



Lancaster Terrace, W2

£750,000



- Close Proximity to Hyde Park
- Excellent Transport Links
- Share of Freehold
- 24/7 Concierge
- Balcony
- Lift

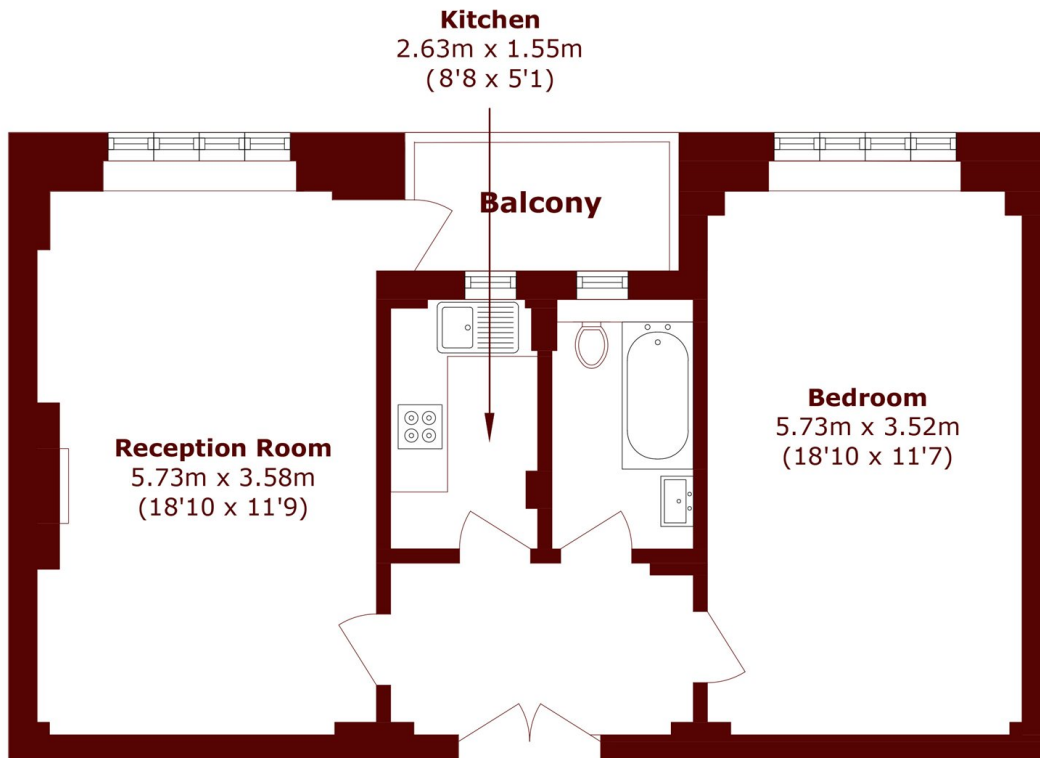

Total area (approx.): 57.6 sq. m (620.0 sq. ft)

Balcony area (approx.): 3.0 sq. m (32.2 sq. ft)

Marsh & Parsons Notting Hill

2-6 Kensington Park Road,
London, W11 3BU
020 7313 2890