



Keble Road, Moreton-In-Marsh

£475,000 Freehold

Sold With No Onward Chain. Spacious four-bed detached home in Moreton-in-Marsh. Extended, three bathrooms, two-tier garden, direct town access. Close to schools, amenities, and rail links to London.



Council Tax band: D

Tenure: Freehold



- Detached four-bedroom family home extending to approximately 1,565 sq ft
- Extended to the rear and first floor creating generous living accommodation
- Four bedrooms and three bathrooms including principal en-suite
- Two reception rooms including a 22ft snug/dining room
- Long kitchen arrangement with separate utility room
- East-facing two-tier rear garden with patio seating area
- Rear gate access onto a footpath leading towards the



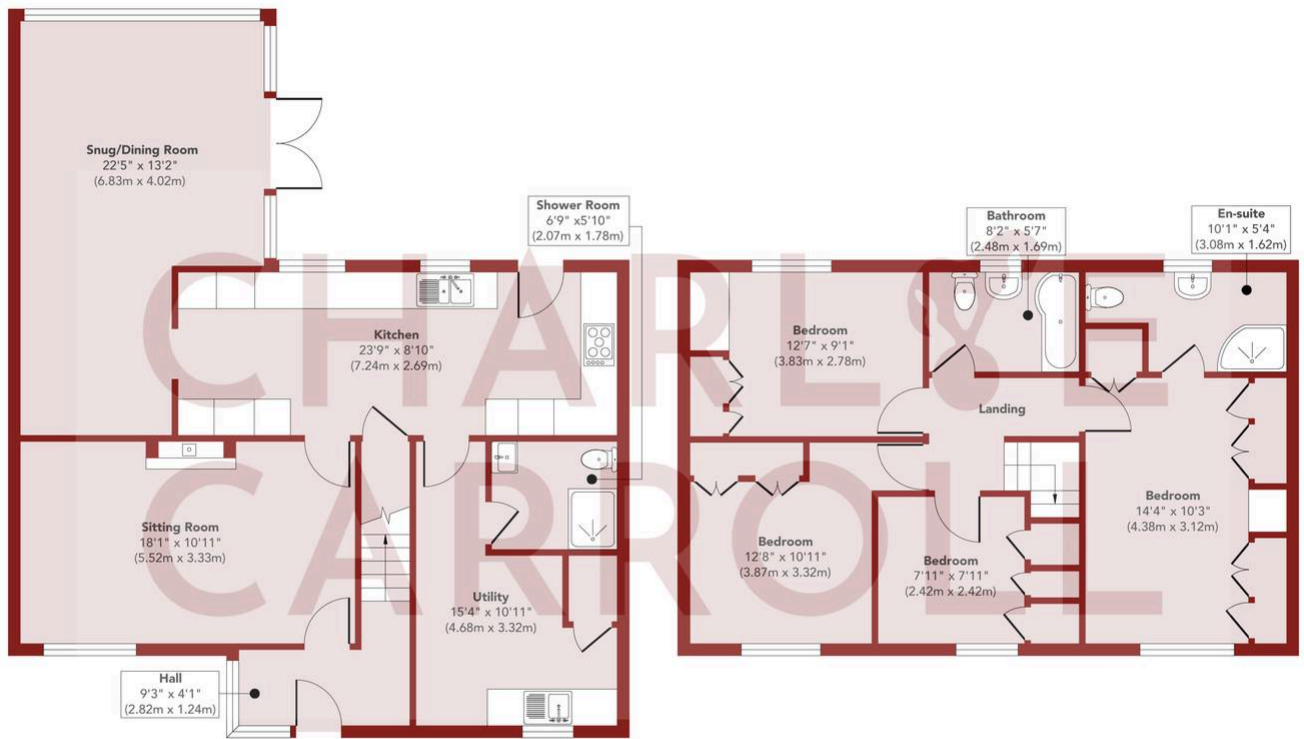

Ground Floor
 Approximate Floor Area
 917 sq. ft
 (85.28 sq. m)

First Floor
 Approximate Floor Area
 648 sq. ft
 (60.22 sq. m)

Approx. Gross Internal Floor Area 1565 sq. ft / 145.50 sq. m

Illustration for identification purposes only, measurements are approximate, not to scale

Produced by Elements Property