

FLETCHERS

ESTATE AGENTS



Wolseley Gardens, W4

£1,425,000

A beautifully presented four-bedroom family home, ideally located on a tree-lined residential road in the heart of Grove Park.



Finished to an exceptional standard throughout, this spacious property features a large through reception room with ample natural light, leading seamlessly into a stylish eat-in kitchen with bifolding doors opening onto a private and secluded garden perfect for family living and entertaining.

Wolseley Gardens is located in the popular Grove Park area of Chiswick and only a short walk to Gunnersbury Tube Station and from Chiswick Overground.

- Four Bedrooms • Bifolding Doors • Downstairs WC •
- Landscape Garden • South Facing Garden • No Onward Chain •



FLETCHERS

ESTATE AGENTS

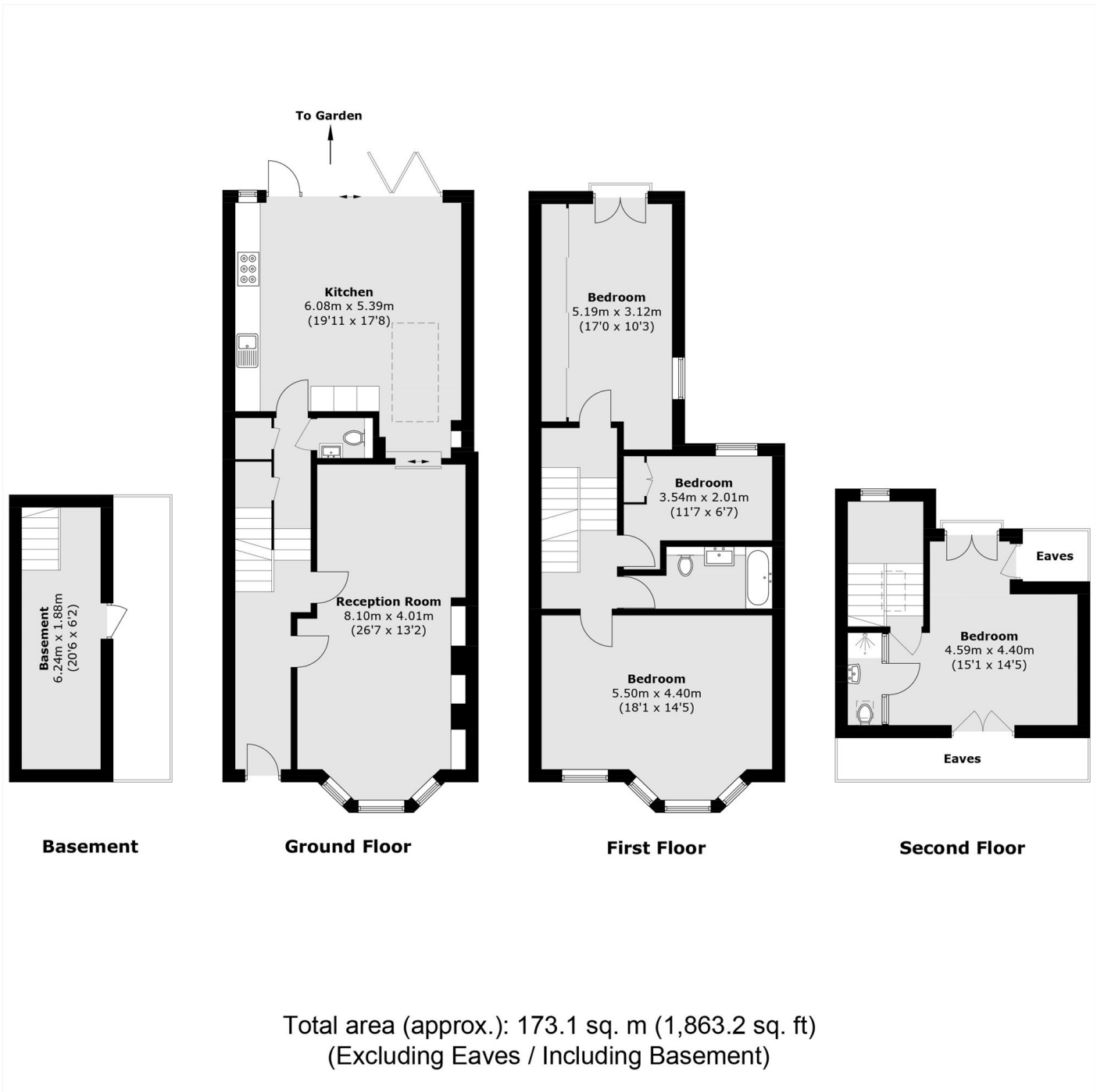

Fletchers Chiswick Turnham Green Sales
58 Turnham Green Terrace
London
W4 1QP
020 8987 3000
chiswicksales@fletcherestates.com

Energy Rating: C We aim to make our particulars both accurate and reliable. However they are not guaranteed; nor do they form part of an offer or contract. If you require clarification on any points then please contact us, especially if you're traveling some distance to view. Please note that appliances and heating systems have not been tested and therefore no warranties can be given as to their good working order