

ALLDAY
& MILLER



Hardy Avenue, Ruislip, HA4 6SU
£720,000

 4  2  1  D



Hardy Avenue, Ruislip, HA4 6SU

£720,000

- Four Bedrooms
- Off Street Parking
- Off Street Parking & Garage
- Great Size Garden
- Extended Semi-Detached Family Home
- Family Bathroom & Downstairs W/c
- Extended
- Desirable Location

Description

Step into this beautifully presented family home, offering a perfect blend of space, style, and comfort. The ground floor welcomes you with a bright and airy reception room, ideal for relaxing or entertaining, a modern fitted kitchen/ dining area and a convenient downstairs WC completes the ground floor.

Upstairs, you'll find four generously sized bedrooms, offering plenty of space for the whole family, as well as a well appointed bathroom.

Outside features a private rear garden, perfect for outdoor dining and entertainment.

Situation

Hardy Avenue is a quiet residential road enjoying its setting close to parks and amenities at South Ruislip, Ruislip Manor and Eastcote. Local transport links are available from nearby South Ruislip train station offering the Central Line into London along with the National Rail service into London Marylebone. South Ruislip station is a short walk away and is useful for the Metropolitan/Piccadilly line providing reliable links into the City and West End. For the motorist the A40/M25 is nearby whilst for families, there are a number of highly regarded schools that cater for children of all ages within close proximity including St Swithun Wells, Ruislip High, Deanesfield Primary School and Queensmead Secondary school. There is a development in South Ruislip which has both shops, restaurants and a cinema which is fantastic for families and couples alike.



Floor Plans

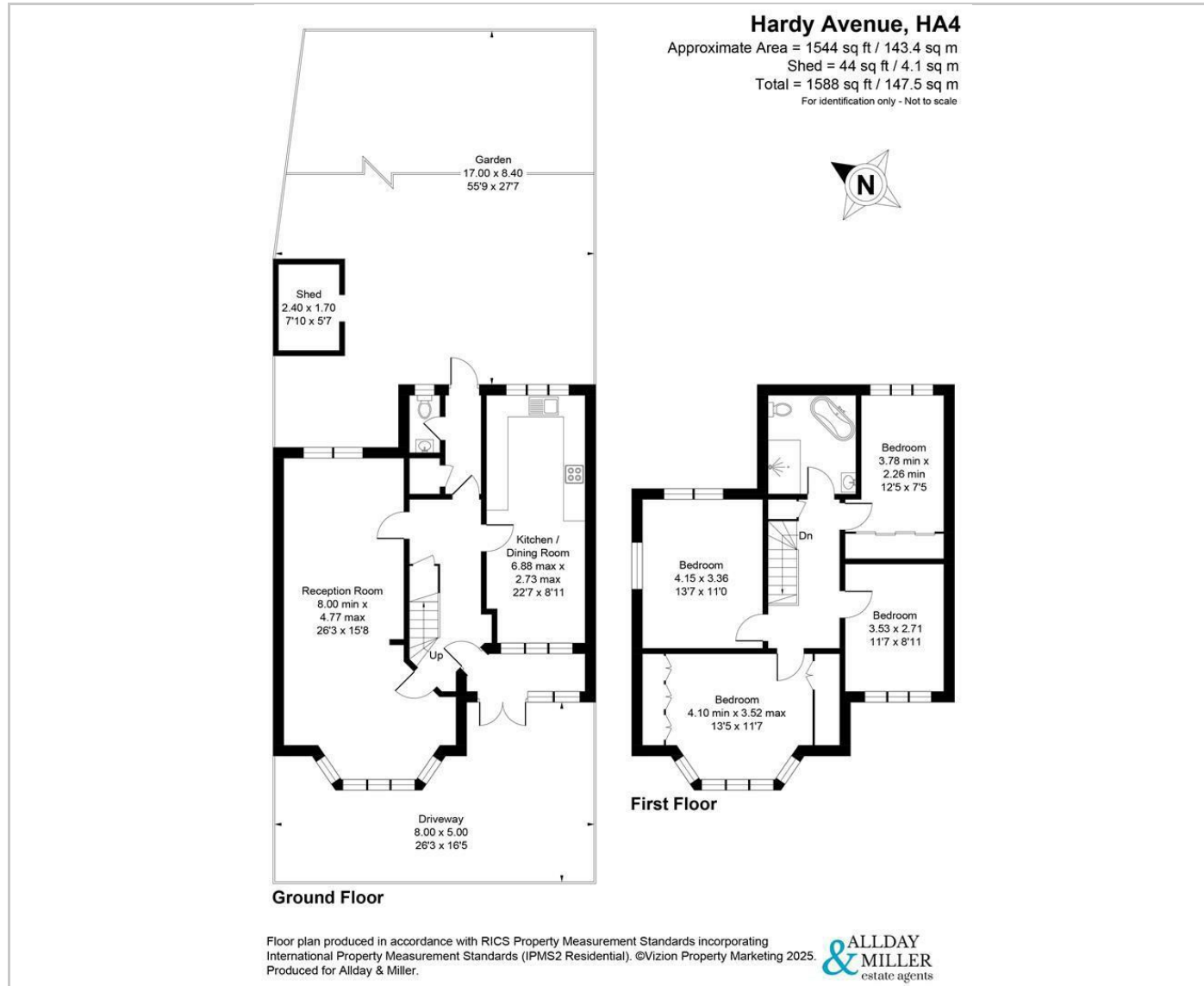

Area Map

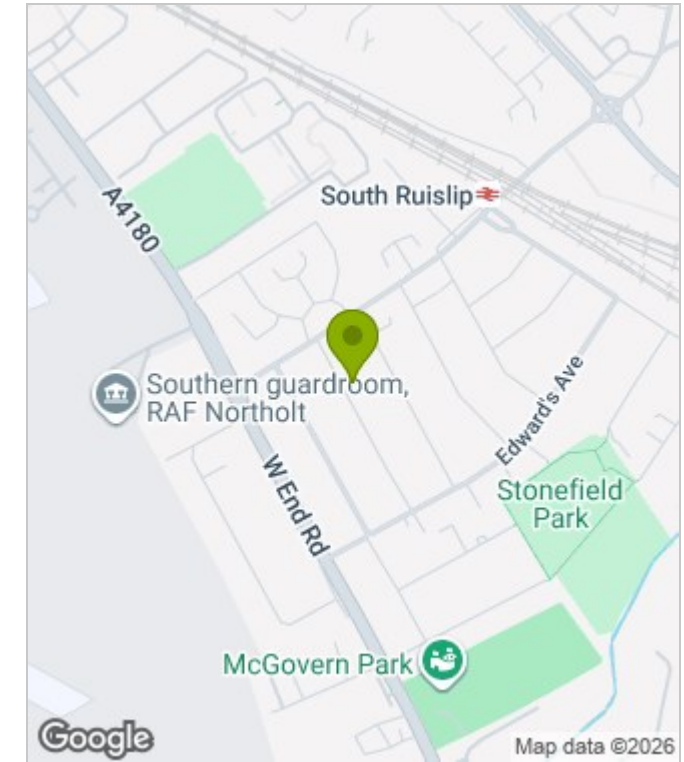

Energy Performance Graph

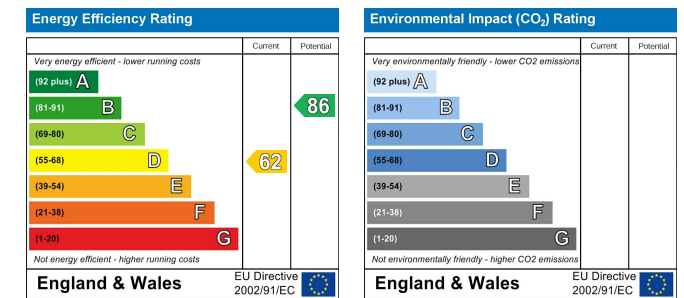

These particulars, whilst believed to be accurate are set out as a general outline only for guidance and do not constitute any part of an offer or contract. Intending purchasers should not rely on them as statements of representation of fact, but must satisfy themselves by inspection or otherwise as to their accuracy. No person in this firm's employment has the authority to make or give any representation or warranty in respect of the property.