



Osborne Court

Cowes

£465,000



Lancasters

A stunning Penthouse apartment with an even better VIEW!! - Beautifully appointed throughout. offered CHAIN FREE. With 2 spacious bright double bedrooms and 2 immaculate bathrooms -the property has plenty of reception space for entertaining - including a wonderful terrace with 360 degree views of Cowes town and the Solent.



2 Bedroom Penthouse Apartment

Sitting/Diner/Kitchen 34' 6" x 21' 1" (10.52m x 6.43m) max

A stunning open plan reception with picture windows and doors out on to the seaward facing sun terrace. Engineered oak flooring - modern fitted kitchen with integrated electrical appliances.

Roof Terrace 14' 6" x 10' 8" (4.42m x 3.24m)

Panoramic views of the Solent. Walled terrace, space for dining table and chairs or loungers.

Bedroom 1 14' 9" x 14' 2" (4.5m x 4.33m)

A super Master bedroom with ensuite shower room. Fitted wardrobes. Velux style windows to the rear.

En-suite

Complete with modern suite to include, panelled bath with shower over and screen, w/c and basin.

Bedroom 2 12' 4" x 10' 6" (3.76m x 3.2m)

A rear aspect double bedroom, with views west. Arranged currently as a twin.

Bathroom

Family bathroom with panelled bath and shower over with screen, w/c and basin.

Tenure

Share of FREEHOLD No Ground Rent Service charge circa £2,300 per year.

NB. This property is located on the 8th Floor, there is a lift to the 5th Floor, and stairs up from there.

PENTHOUSE
1092 sq.ft. (101.4 sq.m.) approx.

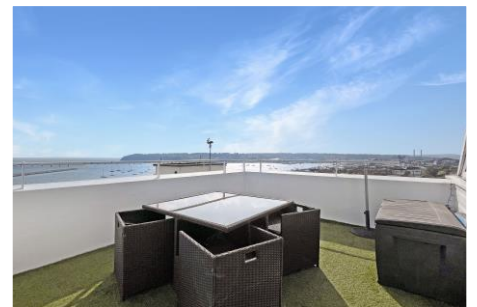
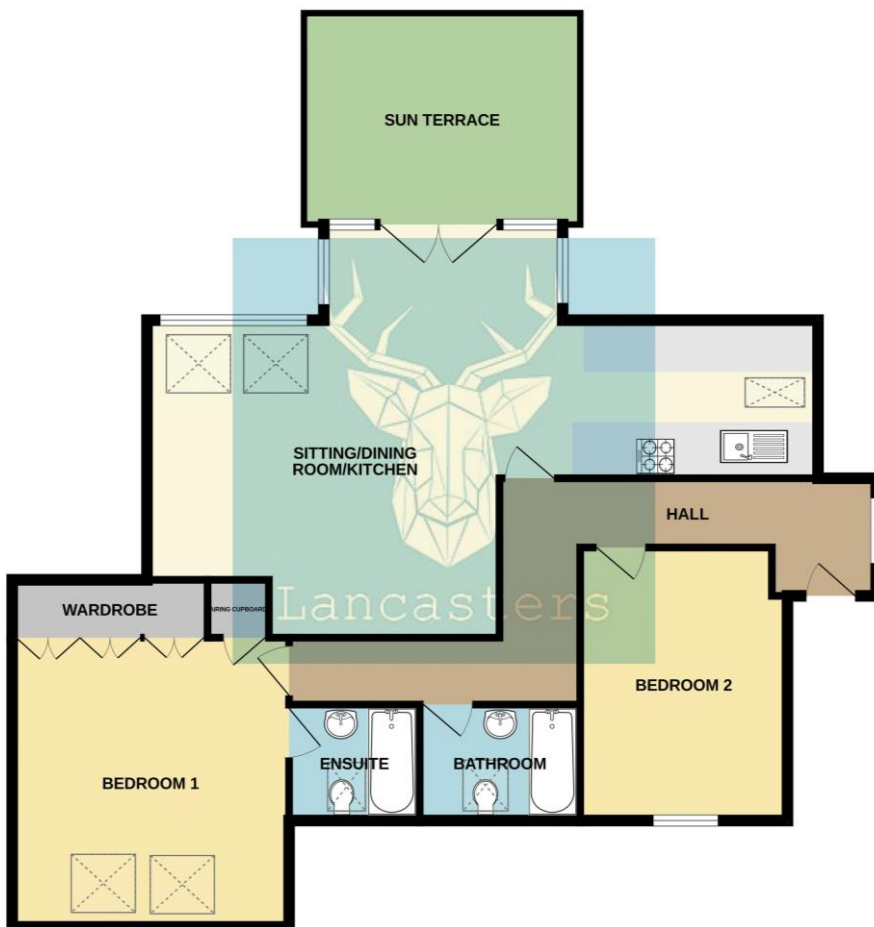

Want more photos and a video? Scan here

Lancasters Estate Agents
Osborne Court | The Parade | Cowes | Isle of Wight | PO31 7QS
01983 209020 Homes@Lancasters.org

Tenure: Share of Freehold
Council: E
EPC: D



These sales particulars do not form part of any contract. The agent has not undertaken any form of survey on the property and has not checked any services. If you decide to purchase this, or any other property, we advise you undertake your own enquiries via your separately appointed solicitor and surveyor.