

# Frank Harris & Co.



## Wandsworth Road, SW8

£3,650 pcm

A modern well-presented two double bedroom property located on the 24th floor of Sky Gardens development. The property offers an open plan living and a winter garden. The building also offers access to a communal garden on the 35th floor, 24hr concierge and residents gym.

Located on Wandsworth Road directly opposite Nine Elms Tube station which has Northern Line services into Central London. Vauxhall Station is a 5-minute walk away with access to the Victoria line and National rail services into Waterloo.

- Two Bedrooms • Two Bathrooms • Winter Garden •
- Furnished • Roof Terrace • Resident's Gym •

# Frank Harris & Co.

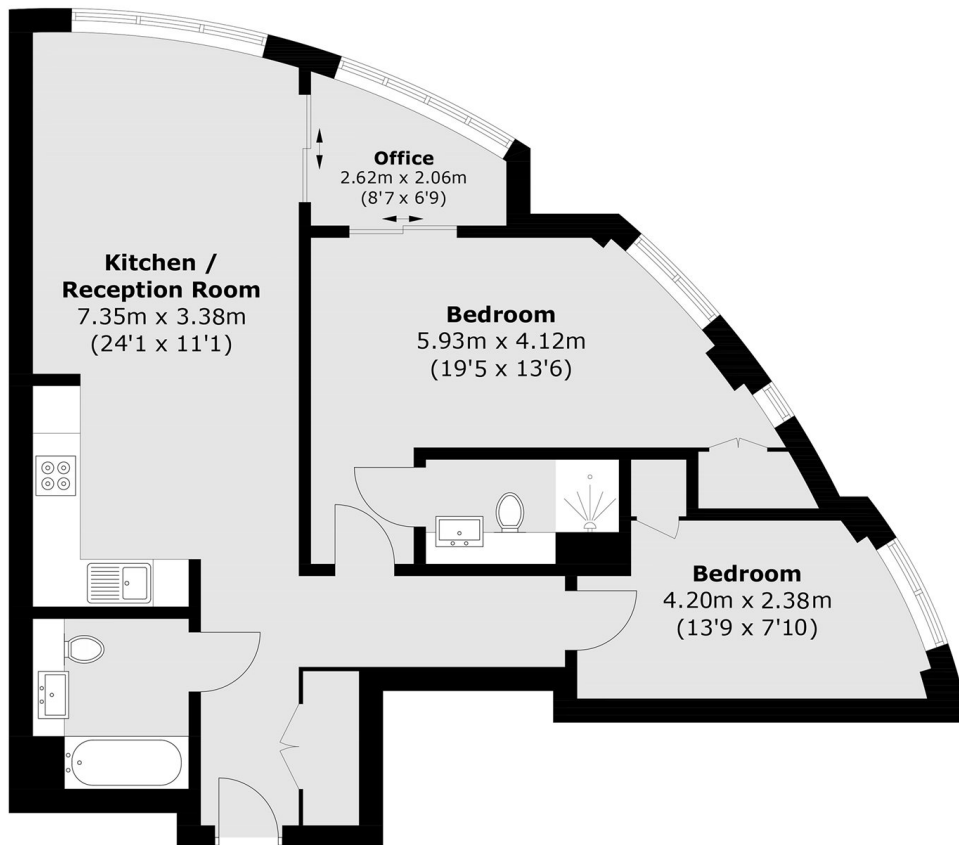

Total area (approx.): 73.4 sq. m (790.1 sq. ft)

Frank Harris & Co. South Bank and Waterloo  
123 Stamford Street, London,  
SE1 9NN  
020 7590 7100  
[southbanklettings@frankharris.co.uk](mailto:southbanklettings@frankharris.co.uk)

Energy Rating: B. We aim to make our particulars both accurate and reliable. However they are not guaranteed; nor do they form part of an offer or contract. If you require clarification on any points then please contact us, especially if you're traveling some distance to view. Please note that appliances and heating systems have not been tested and therefore no warranties can be given as to their good working order.

