

for sale

offers in excess of **£230,000**



Burwood Court Goldlay Avenue Chelmsford CM2 0TW

This beautifully refurbished ground floor 2 bedroom maisonette is set within the well-regarded Burwood Court development on Goldlay Avenue, offering stylish, modern accommodation in a peaceful cul-de-sac setting. The property benefits from its own private entrance and well-proportioned rooms,

Burwood Court Goldlay Avenue Chelmsford CM2 0TW

Entrance Hall

Living Room

19' 7" x 10' 6" (5.97m x 3.20m)

Kitchen

9' 8" x 8' 2" (2.95m x 2.49m)

Bedroom One

11' 10" into wardrobe x 11' 4" (3.61m into wardrobe x 3.45m)

Bedroom Two

8' 4" into wardrobe x 8' 2" (2.54m into wardrobe x 2.49m)

Family Bathroom







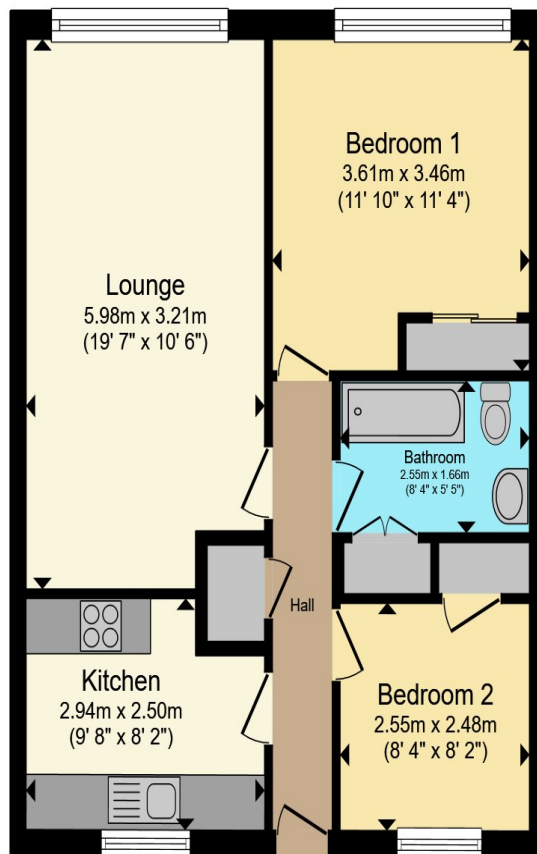

Total floor area 58.2 m² (627 sq.ft.) approx

This floor plan is for illustrative purposes only. It is not drawn to scale. Any measurements, floor areas (including any total floor area), openings and orientation are approximate. No details are guaranteed, they cannot be relied upon for any purpose and they do not form part of any agreement. No liability is taken for any error, omission or misstatement. A party must rely upon its own inspection(s). Powered by www.propertybox.io



To view this property please contact Connells on

T 01245 261 266
E chelmsford@connells.co.uk

4 Tindal Square
 CHELMSFORD CM1 1EH

Property Ref: CHL309101 - 0013

Tenure: Leasehold EPC Rating: E

Council Tax Band: B Service Charge: 1794.00

Ground Rent: Ask Agent

[view this property online connells.co.uk/Property/CHL309101](http://connells.co.uk/Property/CHL309101)

This is a Leasehold property with details as follows; Term of Lease 999 years from 19 Jan 1982. Should you require further information please contact the branch. Please Note additional fees could be incurred for items such as Leasehold packs.

1. MONEY LAUNDERING REGULATIONS Intending purchasers will be asked to produce identification documentation at a later stage and we would ask for your co-operation in order that there will be no delay in agreeing the sale. 2. These particulars do not constitute part or all of an offer or contract. 3. The measurements indicated are supplied for guidance only and as such must be considered incorrect. Potential buyers are advised to recheck measurements before committing to any expense. 4. We have not tested any apparatus, equipment, fixtures, fittings or services and it is in the buyers interest to check the working condition of any appliances.

Connells Residential is registered in England and Wales under company number 1489613, Registered Office is Cumbria House, 16-20 Hockliffe Street, Leighton Buzzard, Bedfordshire, LU7 1GN. VAT Registration Number is 500 2481 05.

see all our properties at www.connells.co.uk | www.rightmove.co.uk | www.zoopla.co.uk