



4 Fieldfare Road, Whiteley, Fareham, PO15 7PP

Asking Price £365,000



Fieldfare Road | Whiteley

Fareham | PO15 7PP

Asking Price £365,000

W&W are pleased to offer for sale this 2022 built three bedroom detached family home offered with no chain ahead. Internally, the property boasts three bedrooms, lounge, kitchen/dining room, utility room, downstairs cloakroom, main bathroom & en-suite shower room to the main bedroom. Outside, the property benefits from a landscaped side garden, garage & driveway parking.

Fieldfare is ideally located for the modern family lifestyle, the Whiteley shopping centre providing a variety of shops and eateries as well as a cinema and supermarket is just a 20 minute walk away, as is 'Meadowside', offering large play field, park & leisure centre. The M27, A27 & Swanwick train station are all easily accessible also. 'Cornerstone Primary School' is close to the property & 'Whiteley Primary School' is also within walking distance

### **ID Checks/ Anti Money Laundering Checks**

Should a purchaser(s) have an offer accepted on a property marketed by Walker & Waterer Estate agents, they will need to undertake an identification check. This is done to meet our obligation under Anti Money Laundering Regulations (AML) and is a legal requirement. We use a specialist third party service to verify your identity. The cost of these checks is £25 inc. VAT per person, which is paid in advance, when an offer is agreed and prior to a sales memorandum being issued. This charge is non-refundable under any circumstances.





2022 built three bedroom detached family home offered with no forward chain

Welcoming entrance hall enjoying attractive wood effect flooring flowing throughout the ground floor

Spacious dual aspect living room with double doors opening out to the garden

Dual aspect 18'6ft kitchen/dining room with walk in bay window

Modern kitchen enjoying high gloss cabinets, attractive worktops, integrated oven/hob with space for additional appliances

Utility room providing additional storage & space for appliances

Downstairs cloakroom

Main bedroom benefiting from built in storage & en-suite

En-suite shower room comprising three piece white suite

Two additional bedrooms with one benefitting from built in storage

Modern main bathroom comprising three piece suite

Landscaped garden with majority laid to paved patio and artificial lawn area

Garage & driveway parking

All services/appliances have not, and will not be tested

### **ADDITIONAL INFORMATION**

Property construction - To be confirmed

Electricity supply - Mains

Water supply - Mains

Sewerage - Mains

Heating - Gas central heating

Broadband - There is no broadband currently connected to the property

Please check here for potential broadband speeds - <https://www.openreach.com/fibre-broadband>

Please check here for all mobile networks - <https://checker.ofcom.org.uk/>



Garage  
194 sq.ft. (18.0 sq.m.) approx.

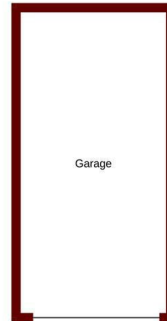

Ground Floor  
492 sq.ft. (45.7 sq.m.) approx.

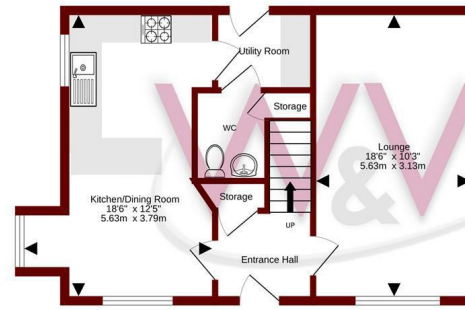

1st Floor  
481 sq.ft. (44.7 sq.m.) approx.

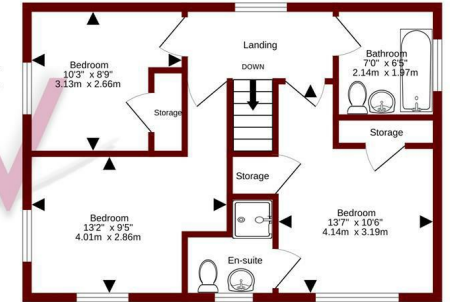

TOTAL FLOOR AREA: 1167 sq.ft. (108.4 sq.m.) approx.

Whilst every attempt has been made to ensure the accuracy of the floorplan contained here, measurements of doors, windows, rooms and any other items are approximate and no responsibility is taken for any error, omission or mis-statement. This plan is for illustrative purposes only and should be used as such by any prospective purchaser. The services, systems and appliances shown have not been tested and no guarantee as to their operability or efficiency can be given.  
Made with Metropix 6/2025

Energy Efficiency Rating		
	Current	Potential
Very energy efficient - lower running costs		
(92 plus) <b>A</b>		
(81-91) <b>B</b>		
(69-80) <b>C</b>		
(55-68) <b>D</b>		
(39-54) <b>E</b>		
(21-38) <b>F</b>		
(1-20) <b>G</b>		
Not energy efficient - higher running costs		
<b>England &amp; Wales</b>	EU Directive 2002/91/EC	

Council Tax Band - D

Tenure - Freehold

Current EPC Rating - A

Potential EPC Rating - A

H3 Whiteley Shopping Centre

Whiteley Way

Whiteley

Hants

PO15 7PD

01489 580800

whiteley@walkerwaterer.co.uk

www.walkerwaterer.co.uk