

Beechwood Grove, Acton, W3

Offers Over £280,000

2 1 1



- Please Quote MG1175 for all enquiries
- Over 55's Later Living Property
- Separate Kitchen
- Onsite Manager on Call
- Private Communal Gardens
- 2 Bed Apartment
- 2nd Floor with Lift Access
- Offers Over £280,000
- In need of cosmetic refurbishment
- Communal Common Room

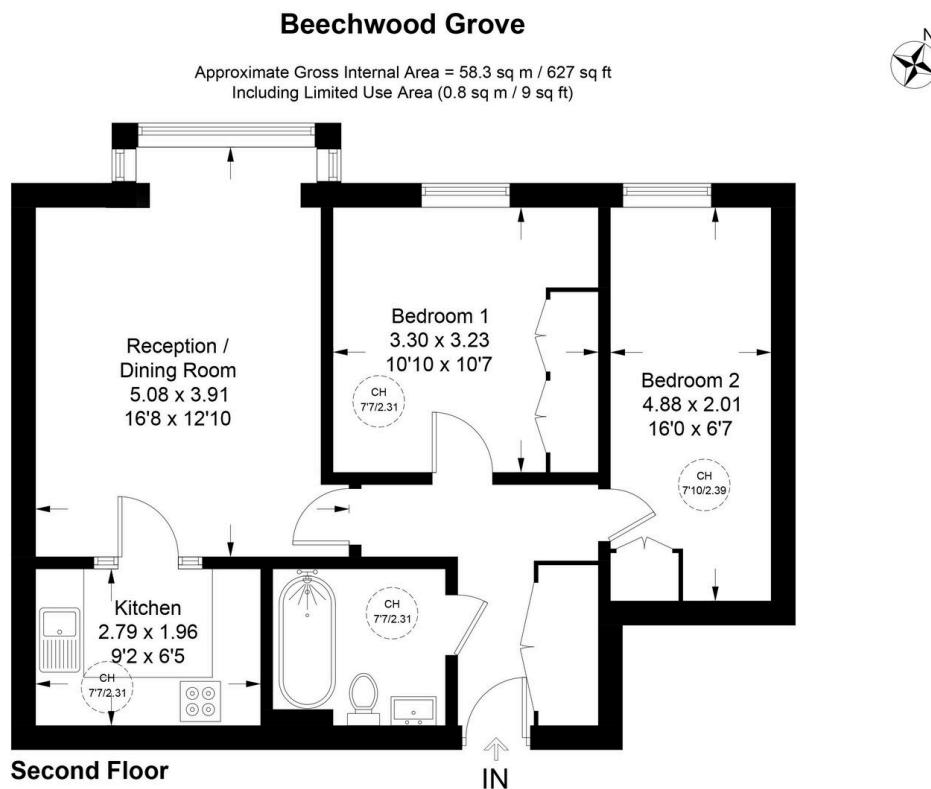

Illustration for identification purposes only, not for valuation purposes, measurements are approximate, not to scale. IPMS2

Located in the highly regarded Beechwood Grove development in Ealing, W3, this bright and spacious two-bedroom apartment offers secure, comfortable, and convenient later living for the over 55s. Positioned on the second floor and serviced by a lift, the property provides easy access throughout and the opportunity for the new owner to refurbish and personalise to their own taste. Inside, the apartment features.