

Orchard Road

ST GEORGE

APPROXIMATE FLOOR AREA
85.1 SQM / 916 SQFT



GROUND FLOOR
534 sq.ft. (49.6 sq.m.) approx.

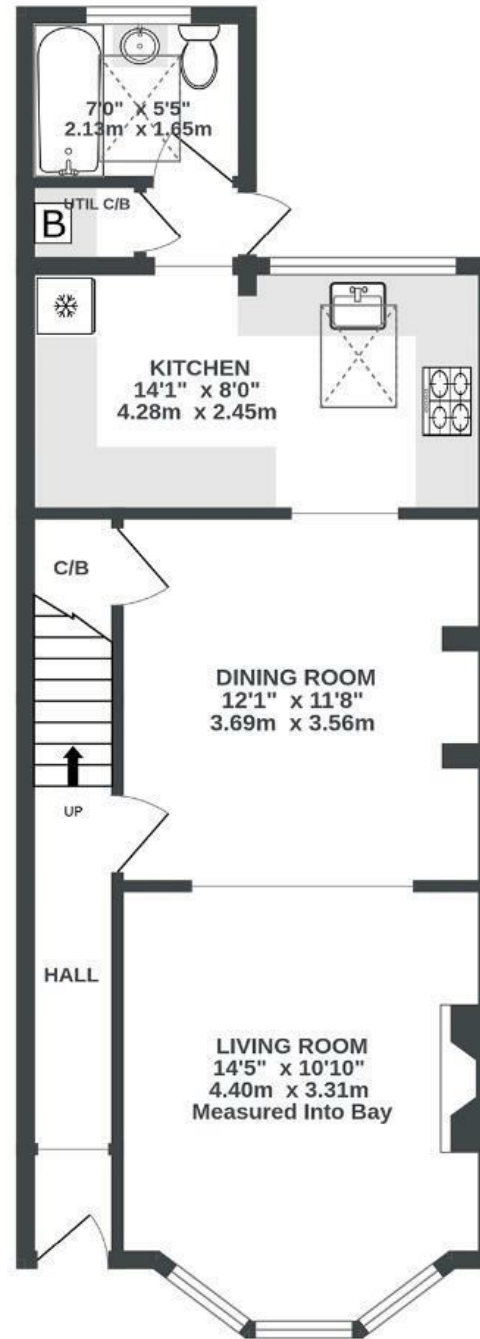

1ST FLOOR
382 sq.ft. (35.5 sq.m.) approx.

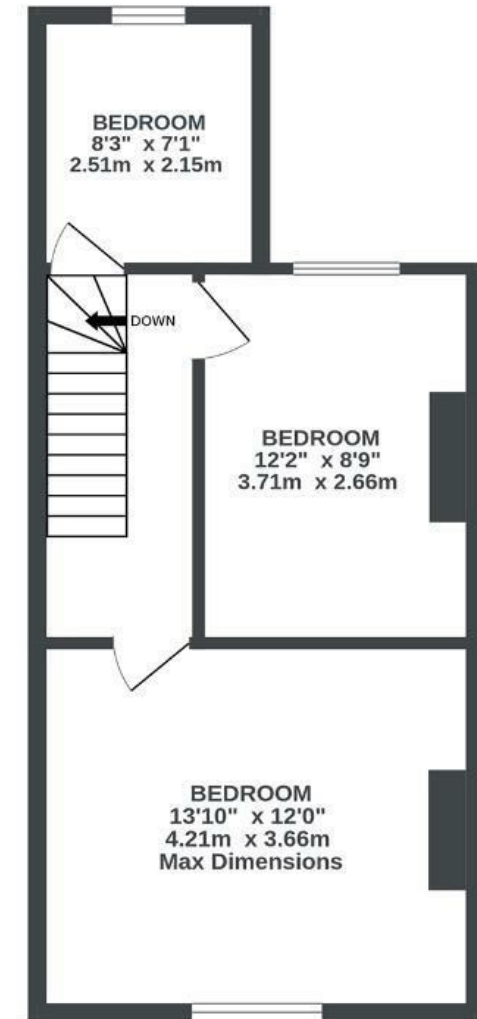

Illustrations are for reference purposes only, measurements are approximate, not to scale.

Boardwalk

Orchard Road

ST. GEORGE, BRISTOL



£410,000



3 Bedrooms



BS5 7HS



1 Bathrooms

"We've loved the past 10 years living on Orchard Road. It's a friendly road, and we've got to know many of our neighbours well. We've put a lot of thought and time into renovating and decorating the house, as well as extending and transforming the garden, making it a truly special place to live. We've also really valued being surrounded by so much green space, with St George Park, Troopers Hill, and Conham River Park all close by. Church Road now has a great selection of pubs, cafés and shops, all within a short walk through the park. The cycle path is easily accessible, and buses into town run frequently from the top of the Road."

