



The Hall, Church Road, Ramsden Bellhouse

The Hall, Church Road Ramsden Bellhouse

Offers in the Region of
£2,750,000

The Hall is an impressive Grade II listed Georgian residence set within approximately 2.37 acres (stls) of beautifully landscaped grounds, featuring a private boating lake and exceptional leisure outbuildings.

Dating back to the late 16th century and later re-fronted in Georgian red brick, The Hall was believed to be one of King Henry V11 past shooting lodges and blends historic charm with modern living. The accommodation is arranged over three floors and includes elegant reception rooms, a high-specification kitchen/breakfast room, and a principal bedroom suite with en suite, alongside further bedrooms and flexible space. The grounds are a standout feature, centred around a picturesque boating lake and complemented by a range of outbuildings including a detached office, garaging, and



an impressive entertainment barn with potential for conversion (stp).

Situated in the desirable village of Ramsden Bellhouse, the property offers a peaceful semi-rural lifestyle while remaining conveniently close to Billericay and Wickford, with rail connections to London Liverpool Street in just over 30 minutes.

An Anti-Money Laundering (AML) check is required for both buyers and sellers and is carried out through our legal partner at a fee of £65 per property, payable at the point of instruction. This service also includes access to a legal advice helpline, where qualified solicitors are available to support you with any queries throughout your moving process.

Sitting Room 21' 11" x 18' 4" (6.68m x 5.58m)

Dining Room 21' 7" x 17' 0" (6.57m x 5.18m)

Kitchen 17' 0" x 9' 4" (5.18m x 2.84m)

Breakfast Room 11' 7" x 8' 7" (3.53m x 2.61m)

Family room 22' 0" x 22' 10" (6.70m x 6.95m)

Study 9' 3" x 7' 7" (2.82m x 2.31m)

Bedroom 1 22' 0" x 17' 1" (6.70m x 5.20m)

Bedroom 2 18' 0" x 13' 5" (5.48m x 4.09m)

Attic Bedroom 22' 3" x 11' 1" (6.78m x 3.38m)

Bedroom 4

Games room 39' 2" x 16' 10" (11.93m x 5.13m)

Beauty room 17' 10" x 11' 6" (5.43m x 3.50m)

Gym 23' 4" x 8' 1" (7.11m x 2.46m)

Garage 23' 4" x 18' 3" (7.11m x 5.56m)

Private long gated driveway

Detached Barn, Office and Garden room

0.25 Acre Boating Lake

Additional 2.23 acres available (by way of separate negotiation)













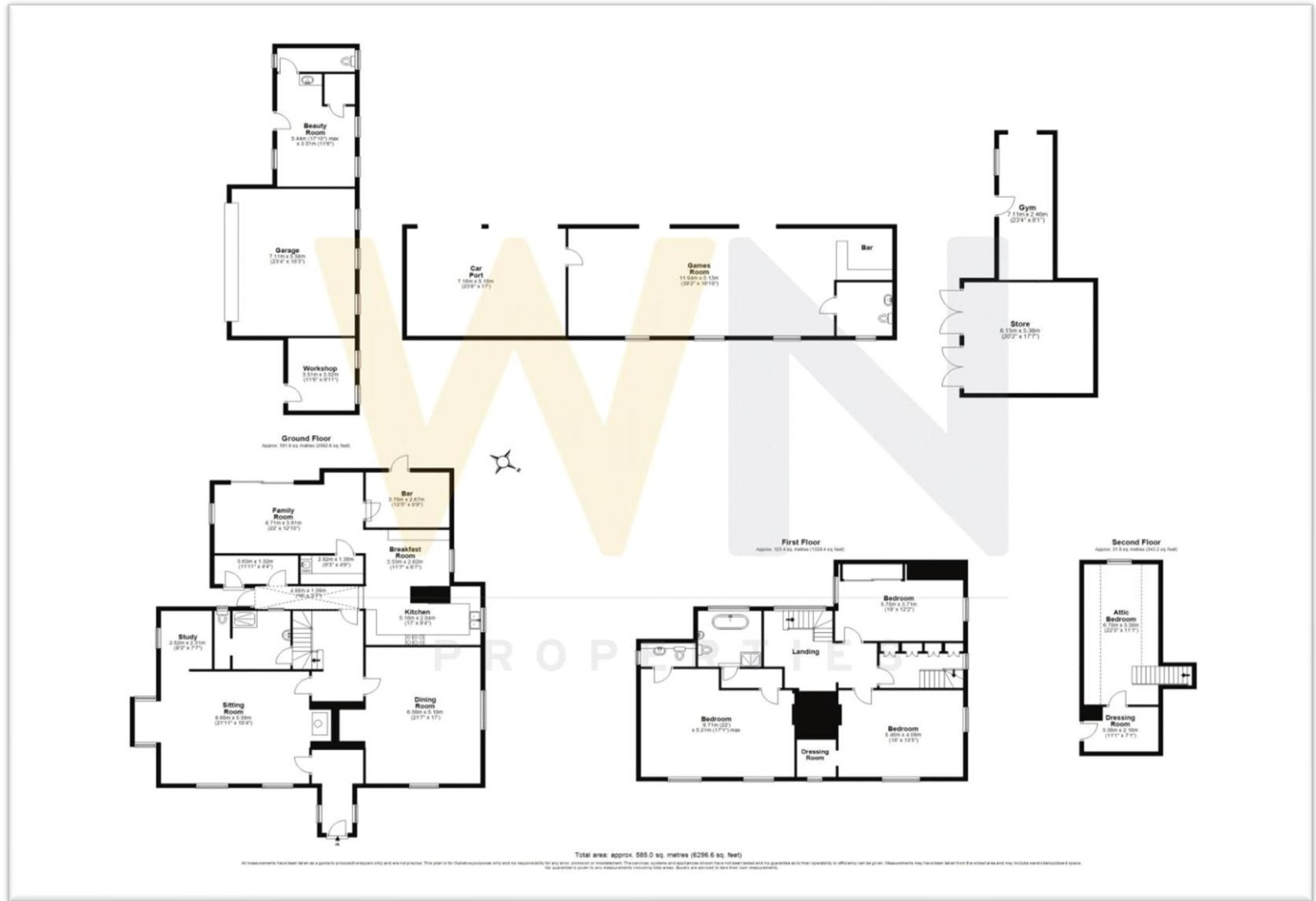

Council Tax Band G

148 Hutton Road
Shenfield
Essex CM15 8NL
01277 225191

admin@wnproperties.co.uk
wnproperties.co.uk



Every effort has been made to ensure the complete accuracy of these particulars, however they cannot be guaranteed. Always check before agreeing to purchase. This includes checking on the existence of relevant permissions, services/utilities, fixtures, fittings and appliances which have not been tested by WN Properties and there is no guarantee that they are in working order or fit for purpose. Photographs are for general information and it cannot be inferred that any items shown are included in the sale or within the ownership of the seller and therefore must be verified by your legal representative. No assumptions can be made from any description or image, relating to the type of construction, structural condition or the surroundings of the property. All measurements are approximate and any drawings/floorplans provided are for general guidance and are not to scale. WN Properties recommend ancillary service providers from time to time to assist you with your purchase. You are not under any obligation to use the services of any of the recommended providers, though should you accept our recommendation the provider may pay us a Referral Fee. The Referral Fee is separate from your obligation to pay your fees or commission.