



4, Hulsewood Close, Wilmington DA2 7AD
Guide Price £425,000 - £450,000



Guide Price £425,000-£450,000 A beautifully extended and impeccably refurbished ground floor maisonette offering two generous double bedrooms, quietly tucked away in a sought-after cul-de-sac in Wilmington—ideally positioned for local shops, schools, and transport links. Spanning an impressive 1,014 sq ft, this home provides significantly more space than a typical bungalow or two-bedroom house. The current owners have renovated throughout to an exceptional standard, with accommodation comprising an entrance porch and hallway, two spacious double bedrooms, a newly fitted bathroom, two elegant reception rooms, a utility room, a stylish shower room with WC, and a luxurious, newly installed kitchen. Further benefits include a share of the freehold, double glazing, gas central heating, striking herringbone flooring, a large, secluded landscaped rear garden, and a garage en bloc. This is a truly special home that must be viewed to be fully appreciated.

Hulsewood Close Wilmington, Dartford, DA2

Approximate Gross Internal Area = 94.2 sq m / 1014 sq ft

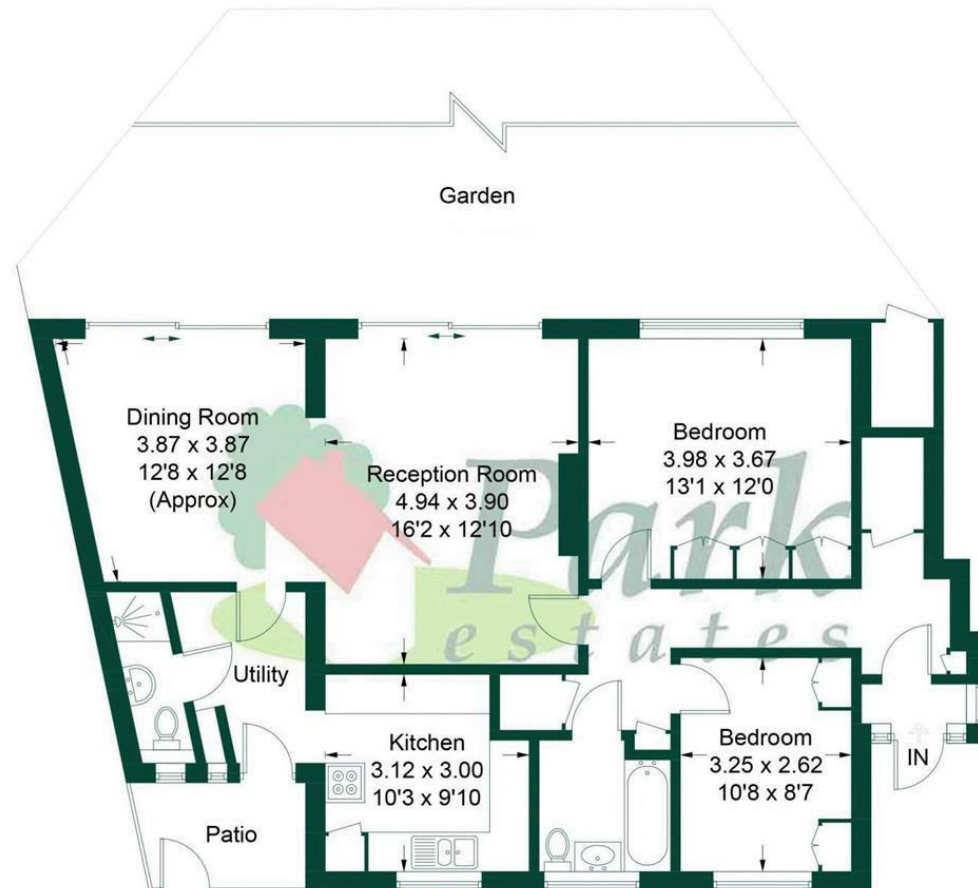

Ground Floor

This plan is for layout guidance only. Not drawn to scale unless stated. Windows and door openings are approximate. Whilst every care is taken in the preparation of this plan, please check all dimensions, shapes and compass bearings before making any decisions reliant upon them. Produced by Planpix on behalf of Park Estates (ID902224)

| Energy Efficiency Rating | | Current | Potential |
|---|--|-------------------------|-----------|
| Very energy efficient - lower running costs | | | |
| (92 plus) A | | | |
| (81-91) B | | | |
| (69-80) C | | | |
| (55-68) D | | 67 | 75 |
| (39-54) E | | | |
| (21-38) F | | | |
| (1-20) G | | | |
| Not energy efficient - higher running costs | | | |
| England & Wales | | EU Directive 2002/91/EC | |

Local Authority: Dartford Borough Council
 Dartford
 Council Tax Band: C



01322 553322

60-62 High Street, Bexley, Kent DA5 1AH

bexley@parkestates.co.uk
 www.parkestates.co.uk

Every care has been taken with the preparation of details, but accuracy is in no way guaranteed. These particulars do not constitute a contract and are issued and accepted on the express understanding that all negotiations will be conducted through Park Estates. The seller does not make or give, nor do we or our employees have any authority to give a representation or warranty in relation to the property. Please contact this office before viewing the property. If there is any point which is of particular importance to you, we will be pleased to check the information for you and confirm that the property remains available. This is particularly important if you are contemplating travelling some distance to view the property. We would strongly recommend that all the information that we provide about the property is verified by yourself on inspection and also by your conveyancer, especially where statements have been made by us to the effect that the information provided by us has not been verified.