

N A I S H

ESTATE AGENTS



YORK
EST. 1939



7 Croft Court

Bishopthorpe, York, YO23 2RU

Incredible four bedroom property just off the Main Street in Bishopthorpe

Offers In The Region Of £495,000

7 Croft Court

Bishopthorpe, York, YO23 2RU



- FOUR BEDROOM PROPERTY
- INCREDIBLE LOCATION
- MULTIPLE RECEPTION AREAS
- IMMACULATELY PRESENTED
- EXCELLENT SCHOOL CATCHMENTS
- WELL PRESENTED GARDEN
- OPEN PLAN KITCHEN
- OFF STREET PARKING

Offer Procedure

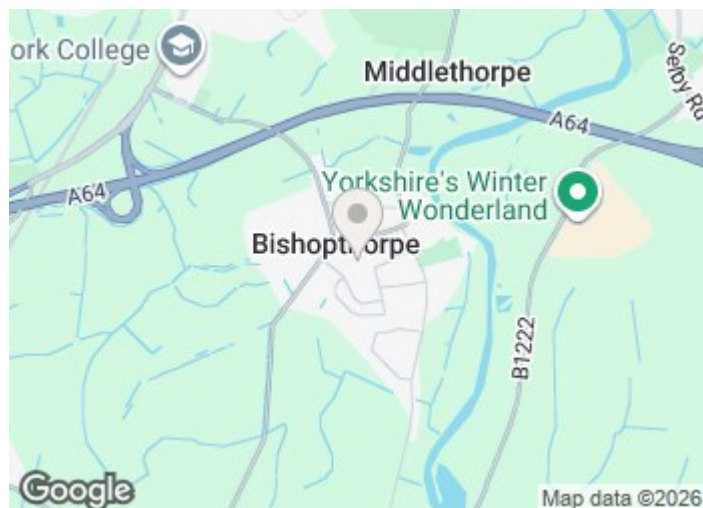

Directions



Floor Plan

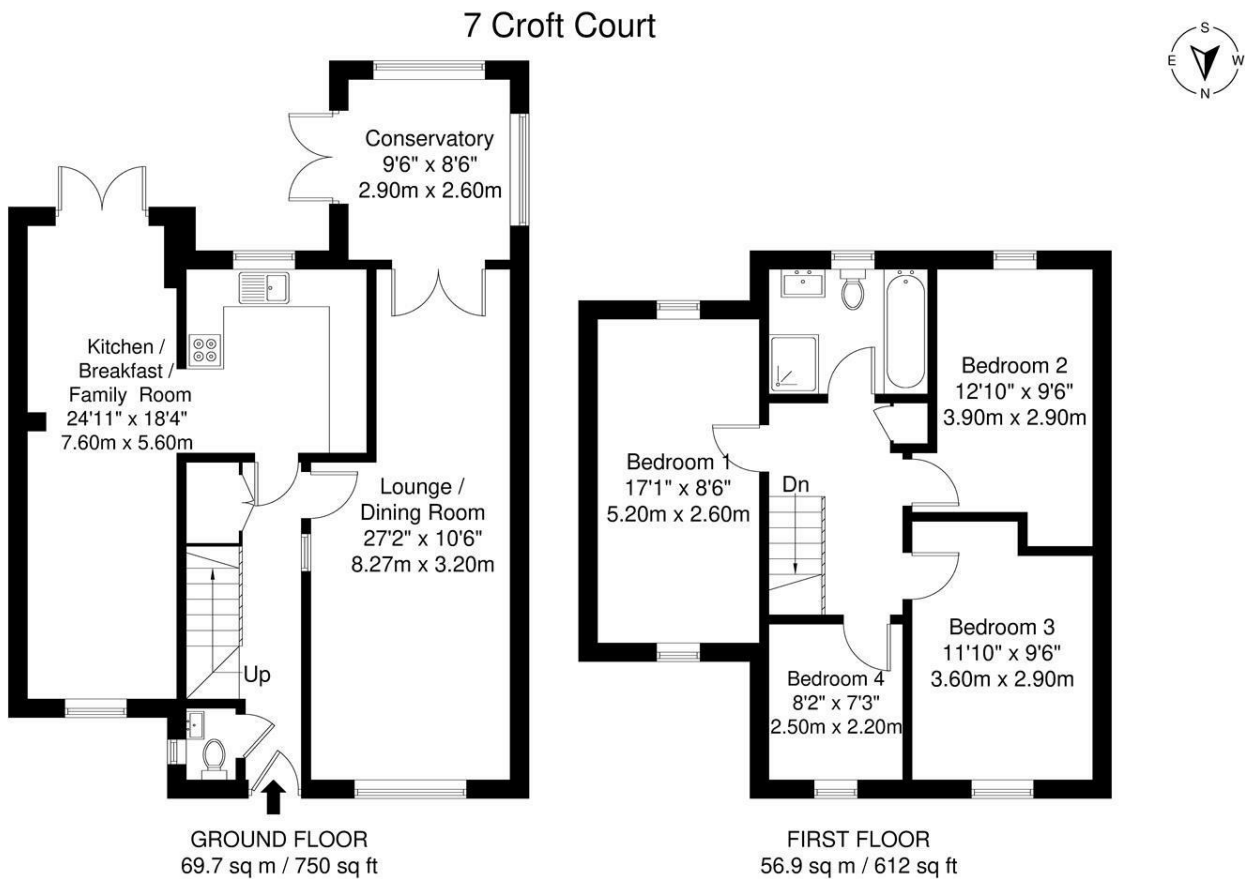

These particulars, whilst believed to be accurate are set out as a general outline only for guidance and do not constitute any part of an offer or contract. Intending purchasers should not rely on them as statements of representation of fact, but must satisfy themselves by inspection or otherwise as to their accuracy. No person in this firms employment has the authority to make or give any representation or warranty in respect of the property.

Energy Efficiency Rating		
	Current	Potential
Very energy efficient - lower running costs		
(92 plus) A		
(81-91) B		
(69-80) C		
(55-68) D		
(39-54) E		
(21-38) F		
(1-20) G		
Not energy efficient - higher running costs		
England & Wales		
EU Directive 2002/91/EC		