

SIGNATURE

NORTH EAST

OFFICIALLY RATED THE NO.1 ESTATE AGENT IN THE NORTH EAST





 Berrishill Grove, Whitley Bay NE25 9XU

Berrishill Grove, Whitley Bay NE25 9XU

Asking Price
£750,000

Signature North East are delighted to welcome to the market this charming four-bedroom detached bungalow, ideally located in the sought-after area of Whitley Bay. This property enjoys a superb position close to the coast, with the beach just a short stroll away. Berrishill Grove also benefits from easy access to a range of local amenities including Sainsbury's Supermarket and West Monkseaton Metro Station, as well as excellent bus links connecting to Whitley Bay town centre, making this an ideal choice for convenient coastal living.

Nestled within a peaceful private cul-de-sac with no facing neighbours, this detached bungalow offers complete privacy and tranquillity. Set on an extensive surrounding plot, it presents a rare opportunity for those seeking both space and potential. The generous land size makes it ideal for private commercial use or dwelling expansion, with huge development potential (subject to planning). Perfect for entrepreneurs, investors, or anyone seeking a private retreat, the setting combines seclusion with accessibility.

Upon entering the property, you are greeted by a welcoming central hallway which also provides access to a convenient W.C. The spacious living room offers ample room for your desired furnishings and is filled with natural light thanks to a large window and sliding doors that open onto the rear garden. Adjacent to this is a versatile sitting room, perfect for use as a dining area, which leads through to the kitchen. The kitchen provides an abundance of storage and can comfortably accommodate a small dining table. A utility room sits just off the kitchen, with access to both the garden and the double garage.

Continuing through the home, you will find four generously sized bedrooms, each easily accommodating a double bed and accompanying furnishings. The primary bedroom benefits from built-in storage and a private en-suite. Completing this floor is a family bathroom fitted with a bathtub and overhead shower, hand basin, and W.C.

Externally, this wonderful home boasts a generous front and rear garden, both laid to lawn with a spacious patio area ideal for outdoor furniture and entertaining. To the front, there is ample driveway parking and access to a double garage, providing excellent storage and convenience.

This lovely bungalow perfectly combines comfort, practicality, privacy, and location — a truly rare opportunity for those seeking life by the sea with potential for further development.



PLEASE NOTE THAT THE VENDOR HAS CERTIFIED THE PROPERTY INFORMATION AND IMAGES.

PROPERTY FLOORPLAN

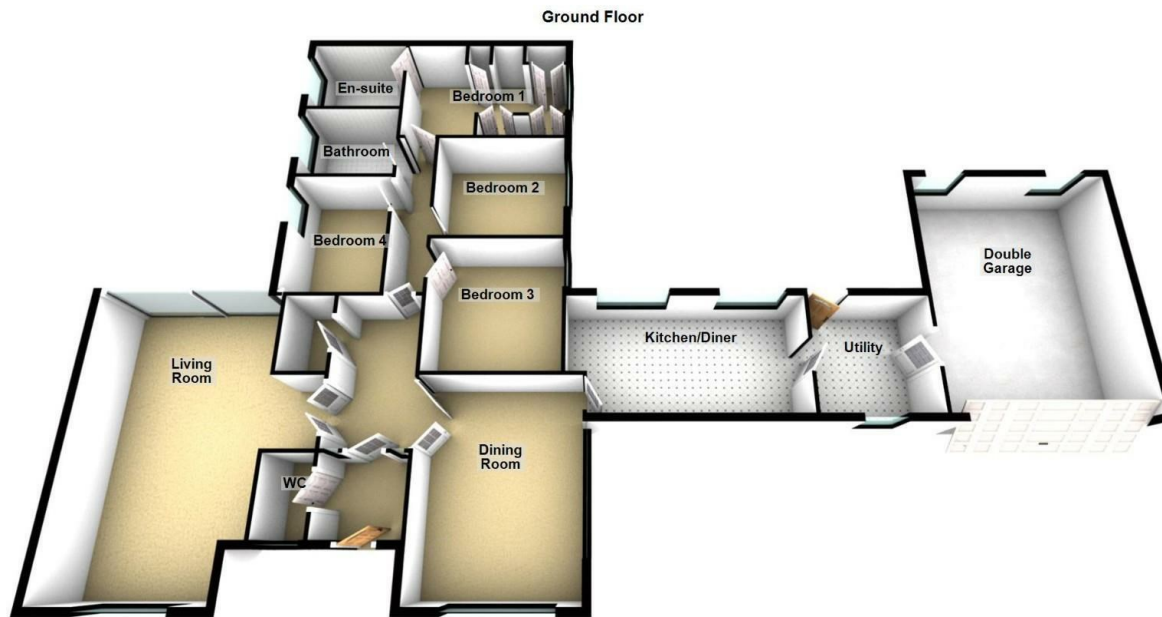

Total area: approx. 174.4 sq. metres (1877.0 sq. feet)

Measurements:

Living Room
23' x 18'6"

Dining Room
16'0" x 12'3"

Kitchen
10' x 18'

Utility
10' x 10'

WC
3'9" x 6'1"

Bedroom One
9'9" x 14'5"

En Suite
6'1" x 8'5"

Bedroom Two
8'11" x 10'6"

Bedroom Three
11'6" x 10'8"

Bedroom Four
10'7" x 8'5"

Bathroom
6'9" x 8'5"

Energy Efficiency Rating

	Current	Potential
Very energy efficient - lower running costs		
(92 plus) A		
(81-91) B		81
(69-80) C	69	
(55-68) D		
(39-54) E		
(21-38) F		
(1-20) G		
Not energy efficient - higher running costs		
England & Wales	EU Directive 2002/91/EC	





More 5 Star Customer Reviews than any other Agent based in the North East on allAgents.co.uk



SALES

LETTINGS

FINANCE

LAW

WE COVER THE WHOLE OF THE NORTH EAST

Whitley Bay
0191 251 3344

Cramlington
01670 897 213

Tynemouth
0191 296 6689

Morpeth
01670 513 966

Ponteland
01661 820 082

Wallsend
0191 432 4151

Alnwick
01665 511 800

Heaton
0191 432 4275

Forest Hall
0191 266 9966

Other locations
0191 640 3523

Newcastle
0191 640 2284

Durham
0191 303 8252

Gosforth
0191 640 3523

Sunderland
0191 543 6390

Whickham
0191 432 5102

Gateshead
0191 432 4294

Jesmond
0191 281 1037

Killingworth
0191 640 3602

Ryton
0191 413 9845

Head Office &
Lettings
0191 253 4815

*Highest recommended 5-star reviews than any other Estate Agent based in the North East on allAgents.co.uk - The UK's Largest Customer Review Website for the Property Industry & Awarded Best Estate Agency 2018 & 2019 - North East England by SME News