



6 Wyre Court, Tilehurst, Reading, Berkshire, RG31 6FU
£115,000 Leasehold

sansome & george
Residential Sales & Lettings

- Well Presented Ground Floor Studio Apartment
- Communal Entrance Hall & Entrance Hall
- Fitted Kitchen
- Off Road Parking
- Close to Shops & Bus Services
- Located on the Westwood Fields Development
- Lounge/Bedroom
- Bathroom
- UPVC Double Glazing
- No Onward Chain

A well presented ground floor studio Apartment located on the sought after Westwood Fields development. Situated on the western fringes of Reading, this fine home neighbours Tilehurst and Pangbourne Village, which hosts a wealth of local independent shops and businesses. Miles of open countryside, riverside walks, community barn, local sports and socials clubs with excellent recreational facilities are all minutes away.

The local sports complex and Tilehurst railway station with links to central London and Oxford are both easily accessible.

Accommodation comprises of communal entrance hall, entrance hall, lounge/bedroom, kitchen and bathroom. The property also features electric heating, UPVC double glazed windows and enclosed allocated parking.

This ideal first time or investment purchase is offered for sale with the added advantage of no onward chain.

Please contact Sansome & George Tilehurst office to arrange a viewing.

Lease term: 89 Years Approximately

Service charge: £91.91 Per month

Ground Rent - Not Applicable

Council Tax - Band A - West Berkshire

Misrepresentation and Misdescriptions Acts

Sansome & George Residential Sales & Lettings LTD for themselves and for the Vendors or Lessors of this property, whose agents they are, give notice that;- (1) these particulars are for guidance purposes only to intending Purchasers or Lessees and do not constitute, nor constitute any part of, an offer or a contract; (2) descriptions, dimensions, condition, use and other details are given without responsibility and intending Purchasers or Lessees are recommended to commission a structural survey and obtain legal advice; (3) Sansome & George Residential Sales & Lettings LTD or any person in their employ do not have any authority to make or give any representation or warranty in relation to the property, fixtures or fittings, mechanical and electrical services fitted thereto.



Approx Gross Internal Area
24 sq m / 263 sq ft

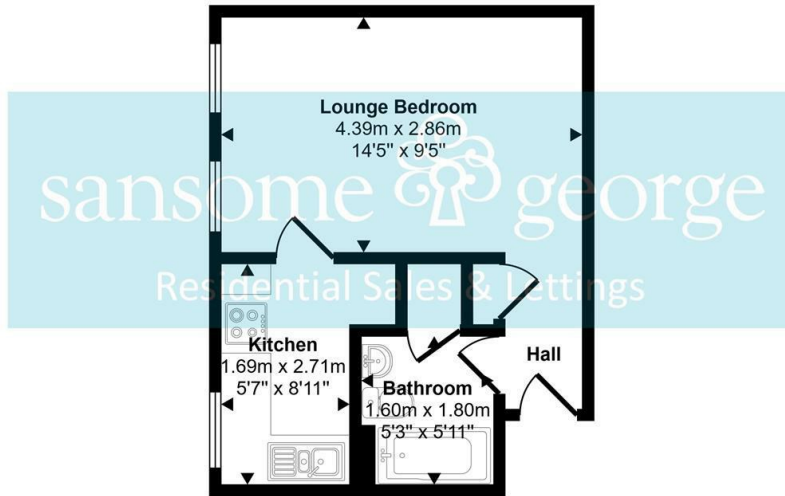

Floorplan

This floorplan is only for illustrative purposes and is not to scale. Measurements of rooms, doors, windows, and any items are approximate and no responsibility is taken for any error, omission or mis-statement. Icons of items such as bathroom suites are representations only and may not look like the real items. Made with Made Snappy 360.

