

£125,000 (Leasehold)

*Hanley's*



## Parsonage Court, Highworth, Swindon, SN6 7TJ

A well presented one bedroom first floor apartment with stair-lift set in the popular over 55's Parsonage Court development just a short level walk from the High Street. The accommodation comprises: Entrance hall with built in storage cupboard, living/dining room, kitchen with built-in oven and hob with extractor fan over, double bedroom with built in wardrobes and shower room. The property also benefits from electric radiator heating and double glazing. Parsonage Court offers a laundry room, residents' lounge with further lounge/conservatory, residents' parking, communal gardens and a visitors cottage available to rent per night. The property also benefits from newly fitted toilet system and stop-cock, a 'Call Care' emergency system. The property is being offered for sale with no onward chain. Management charge: £1573.08, Ground rent: £220.00 both paid twice yearly. Please contact our office for information on what is covered by the management charge.





FIRST FLOOR  
494 sq.ft. (45.9 sq.m.) approx.

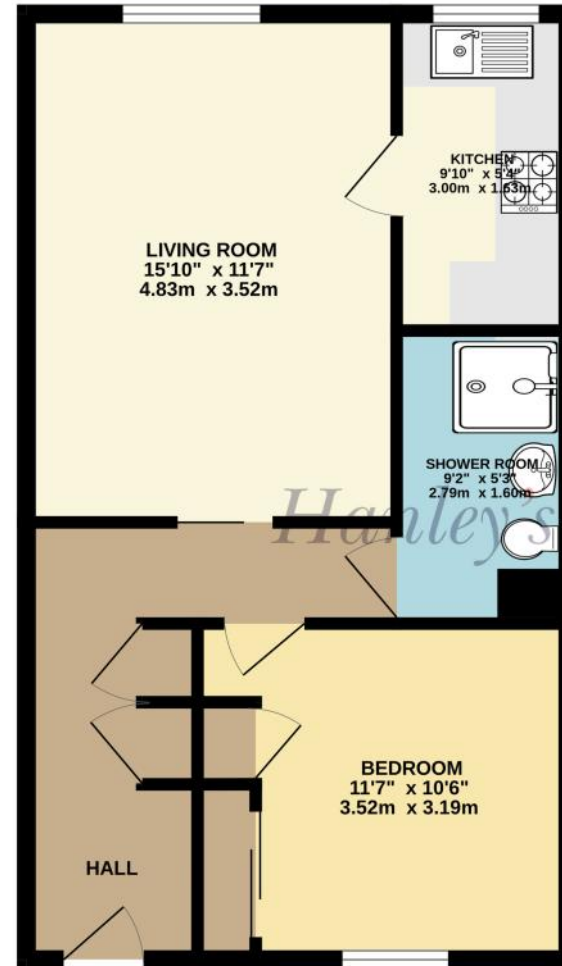

**DISCLAIMER.** These particulars, whilst believed to be accurate are set out as a general outline for guidance and do not constitute any part of an offer or contract. Intending purchasers should not rely on them as statements or representation of fact, but must satisfy themselves by inspection or otherwise as to their accuracy. No person in this firm's employment has the authority to make or give any representation or warranty in respect of the property. Floor plan measurements and distances are approximate only. We have not carried out a detailed survey nor tested the services, appliances or specific fittings. Your home is at risk if you do not keep up repayments on a mortgage or other loan secured on it.

