



**Masons Drive, Great Blakenham, Ipswich, IP6 0GE**

**welcome to**

## **Masons Drive, Great Blakenham, Ipswich**

This well-presented, mid-terraced home benefits from two large, double bedrooms, a spacious lounge, a large, open plan kitchen/diner, a ground floor cloakroom, a 1st floor bathroom, a beautifully landscaped rear garden and two allocated parking spaces to the rear.

### **Entrance Hall**

Carpet flooring, one radiator and an understairs storage cupboard.

### **Cloakroom**

Low level WC, pedestal wash hand basin, one radiator and extractor fan.

### **Kitchen/Diner**

Stunning, open plan kitchen/diner with double glazed window to the front, wood effect flooring throughout, two radiators, eye and base level units in white with wood effect worktop surfaces, a stainless steel one and a half bowl sink plus drainer and chrome mixer tap, an integrated fridge/freezer, oven, gas hob and extractor hood, space for a washing machine and dishwasher, integrated bins and ample space for a table and chairs.

### **Lounge**

Spacious lounge with double glazed windows to the rear, patio doors to the rear garden, carpet flooring, TV point and a wall papered wall.

### **First Floor Landing**

Carpet flooring, loft hatch, one radiator and an airing cupboard.

### **Master Bedroom**

Carpet flooring, double glazed window to the rear and one radiator.

### **Bedroom Two**

Carpet flooring, a built in wardrobe, double glazed window to the front and one radiator.

### **Bathroom**

Low level WC, pedestal wash hand basin, a bath with overhead shower and glass screen, part tiled walls, stone effect flooring, one radiator and extractor fan.

### **Outside:**

#### **Front Garden**

A pathway leading to the front door.

#### **Rear Garden**

Beautifully landscaped rear garden with a raised decking area, artificial grass, a sleeper border, flower beds, planters, a patio to the rear, fully enclosed borders, an outside tap and a rear gate, leading to the parking.

#### **Parking**

Two allocated parking spaces to the rear.

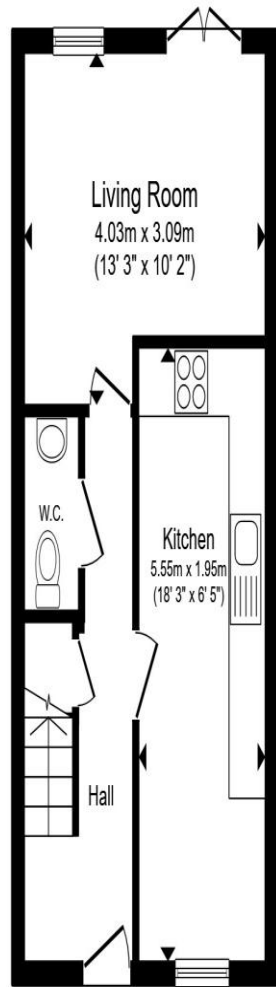

Ground Floor

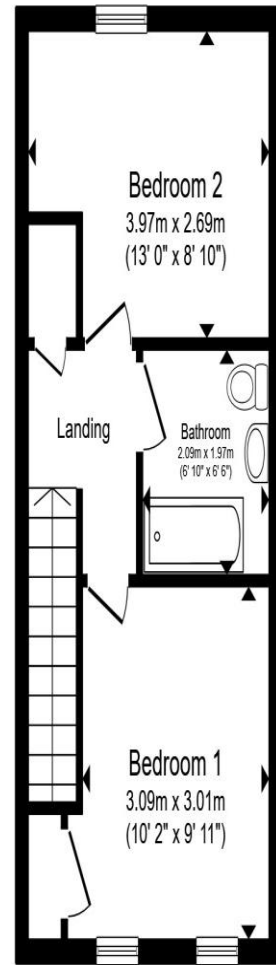

First Floor

Total floor area 63.6 m<sup>2</sup> (684 sq.ft.) approx

This floor plan is for illustrative purposes only. It is not drawn to scale. Any measurements, floor areas (including any total floor area), openings and orientation are approximate. No details are guaranteed, they cannot be relied upon for any purpose and they do not form part of any agreement. No liability is taken for any error, omission or misstatement. A party must rely upon its own inspection(s). Powered by [www.propertybox.io](http://www.propertybox.io)



**welcome to**  
**Masons Drive,**  
**Great Blakenham, Ipswich**

- Two large, double bedrooms
- Large, open plan kitchen/diner
- Ground floor cloakroom & 1st floor bathroom
- Two allocated parking spaces to the rear
- Beautiful views across the park & field to the front

Tenure: Freehold EPC Rating: C  
Council Tax Band: B

offers in excess of  
**£220,000**



**view this property online** [williamhbrown.co.uk/Property/IPS121198](http://williamhbrown.co.uk/Property/IPS121198)



Property Ref:  
IPS121198 - 0004

1. MONEY LAUNDERING REGULATIONS Intending purchasers will be asked to produce identification documentation at a later stage and we would ask for your co-operation in order that there is no delay in agreeing the sale. 2. These particulars do not constitute part or all of an offer or contract. 3. The measurements indicated are supplied for guidance only and as such must be considered incorrect. Potential buyers are advised to recheck measurements before committing to any expense. 4. We have not tested any apparatus, equipment, fixtures or services and it is in the buyers interest to check the working condition of any appliances. 5. Where an EPC, or a Home Report (Scotland only) is held for this property, it is available for inspection at the branch by appointment. If you require a printed version of a Home Report, you will need to pay a reasonable production charge reflecting printing and other costs. 6. We are not able to offer an opinion either written or verbal on the content of these reports and this must be obtained from your legal representative. 7. Whilst we take care in preparing these reports, a buyer should ensure that his/her legal representative confirms as soon as possible all matters relating to title including the extent and boundaries of the property and other important matters before exchange of contracts.

William H Brown is a trading name of Sequence (UK) Limited which is registered in England and Wales under company number 4268443, Registered Office is Cumbria House, 16-20 Hockliffe Street, Leighton Buzzard, Bedfordshire, LU7 1GN. VAT Registration Number is 500 2481 05.



**william h brown**



**01473 226101**



[ipswich@williamhbrown.co.uk](mailto:ipswich@williamhbrown.co.uk)



16-18 Wolsey House, Princes Street, IPSWICH,  
Suffolk, IP1 1QT



**[williamhbrown.co.uk](http://williamhbrown.co.uk)**