



Cold Blow Lane, SE14

£1,800 Per calendar month

New to the market is this beautiful two bedroom property in the heart of New Cross, refurbished to a modern standard throughout with two double bedrooms. Offered fully furnished and available to move into straight away.

Just a stone's throw away from New Cross Gate station.

Features

- Two Double Bedrooms
- Open Plan
- Modern Features
- Central Location
- Quiet Development
- Free Parking

Cold Blow Lane, London, SE14

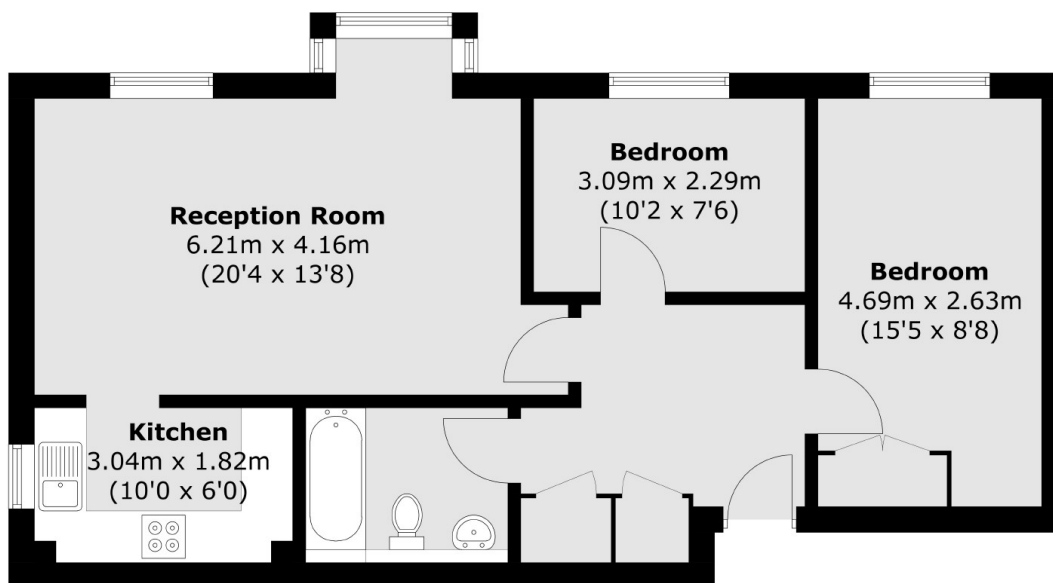

Total area (approx.): 61.6 sq. m (663.1 sq. ft)