



A well proportioned three double bedroom detached family home
Westbury Road, Northwood, Middlesex HA6 3DB

ROBSONS

Asking Price: £2,850 pcm

A well proportioned three double bedroom detached family home

Westbury Road, Northwood, Middlesex HA6 3DB

• ENTRANCE HALLWAY • LIVING/DINING ROOM • KITCHEN • DOWNSTAIRS SHOWER ROOM • THREE DOUBLE BEDROOMS ONE WITH FITTED WARDROBES • BATHROOM • MATURE WELL MAINTAINED REAR GARDEN • OFF STREET PARKING VIA OWN DRIVEWAY • GARAGE • UNFURNISHED

Description

A well proportioned three double bedroom detached family home offered to a high standard situated in the sought after Eastbury Farm Estate. The property offers spacious and versatile accommodation with added benefit of attractive rear garden and plenty of off street parking with own driveway and integral garage.

** An advance reservation payment of one weeks rent is required to secure the property **

Location

The property is equidistant from both Northwood and Moor Park, with their boutique shops, eateries and supermarkets. The Metropolitan Line train stations serve both town centres, which provide access to Baker Street, The City and beyond. The area is also well served for good quality schools for all ages and has the well regarded Eastbury Farm School on the estate. Recreational facilities cater for those enjoying a sporting life, with four major golf courses, cricket and football clubs and two fitness centres.



APPROX. GROSS INTERNAL FLOOR AREA 1057 SQ FT 98.1 SQ METRES (EXCLUDES GARAGE & OUT BUILDING)

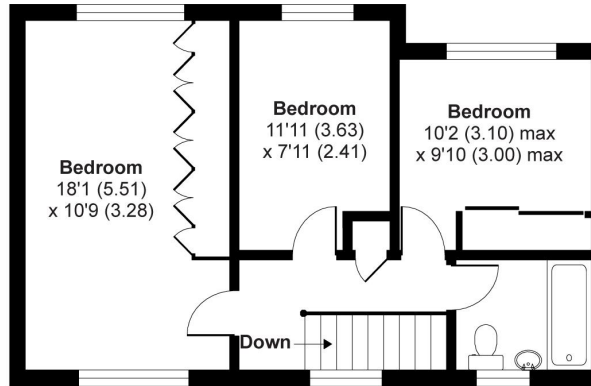

FIRST FLOOR



Out Building
6'6 (1.98)
x 3'4 (1.02)

Out Building

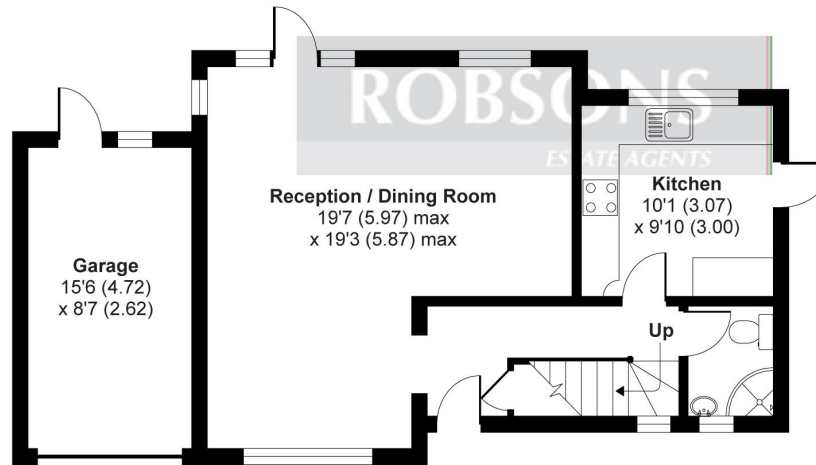

GROUND FLOOR

'For illustrative purposes only - not to scale. The position and size of doors, windows, appliances and other features are approximate only.'

Whilst every attempt has been made to ensure the accuracy of the floor plan contained here, measurements of doors, windows and rooms are approximate and no responsibility is taken for any error, omission or misstatement. These plans are for representation purposes only as defined by RICS Code of Measuring Practice and should be used as such by any prospective purchaser. Specifically no guarantee is given on the total square footage of the property if quoted on this plan. Any figure given is for initial guidance only and should not be relied on as a basis of valuation.

Copyright nichecom.co.uk 2014 Produced for Robsons REF :564754



REGISTERED OFFICE 2-4 PACKHORSE ROAD, GERRARDS CROSS, BUCKINGHAMSHIRE, ENGLAND, SL9 7QE. COMPANY NO. 07557114. VAT NO. GB211239453