



Maltings Field, Castlethorpe, Milton Keynes, MK19

Milton Keynes

£600,000

exp UK

Bedrooms: | Bathrooms: | Receptions:
4 | 2 | 3

Council Tax Band: E

Tenure: Freehold

Property Type: Detached House

- OPEN DAY 31/05/2026 | 1PM TO 3PM | By Appointment Only
- Premium bespoke kitchen with Bosch appliances, steam oven, induction hob, wine fridges & boiling water tap
- Smart home features including Tado heating, Somfy electric blinds & remote controlled Velux windows with rain sensors
- Two spacious reception rooms with underfloor heating & feature gas fireplaces
- Private rear garden with hot tub, mature grape vine & plum tree
- Fully boarded loft spanning the full length of the property for excellent storage
- Dimmable lighting throughout bedrooms, office, entrance hall & reception space
- Just 9 minutes from Wolverton train station, ideal for commuters
- Chain Free Property, Purchase with Ease
- EG1332



ETHAN GAULTER

exp

EG1332

OPEN DAY 31/05/2026 | 1PM TO 3PM | BY APPOINTMENT ONLY

A beautifully upgraded and exceptionally well appointed four bedroom detached family home in the sought after village of Castlethorpe, offering a superb blend of character, comfort and modern smart home convenience, whilst remaining exceptionally well connected for commuters. Wolverton train station is just a 9 minute drive away, Castlethorpe village shop is reachable within a 6 minute walk, Castlethorpe bus stop is approximately a 5 minute walk away with convenient connections into Milton Keynes and Northampton, and Castlethorpe First School, rated Outstanding by Ofsted, is just a 4 minute walk from the property, making this an excellent choice for families.

Set in a lovely village location with open countryside and scenic walking fields nearby, this impressive home has been thoughtfully enhanced throughout, with a stunning bespoke kitchen forming the true heart of the home. Beautifully fitted with premium integrated appliances, this space has been carefully designed for both everyday family life and entertaining, featuring one WiFi enabled Bosch oven, one combination microwave/steam oven, Bosch induction hob, integrated Bosch dishwasher, AEG washer dryer, dual built in bin storage, boiling water incinerator tap, undersink water softener system, and two wine fridges.

The accommodation is both generous and versatile, extending to approximately 1,696 sq ft, and comprises an inviting entrance hall, convenient downstairs WC, dedicated study/home office, spacious living room, and a superb open plan kitchen/lounge/dining area, creating a fantastic social and family focused environment.

To the first floor, the home offers four well proportioned bedrooms, including a principal bedroom with its own en suite shower room, alongside a modern family bathroom, making the layout perfectly suited to growing families, those working from home, or buyers simply seeking flexible additional space.

The property has been thoughtfully upgraded throughout with smart home enhancements that genuinely improve day to day living. Two principal reception areas benefit from underfloor heating and charming gas fireplaces, creating warm and inviting spaces throughout the seasons. Smart home features include custom Somfy electric blinds to the rear with remote control operation, remote controlled Velux windows with rain detection for added peace of mind, and dimmable lighting throughout all bedrooms, the second reception room, office and entrance hall, with selected remote functionality.

Further practical benefits include a Tado smart heating system, a fully boarded loft spanning the full length of the property for exceptional storage, an integral garage, and a private driveway providing off road parking for two vehicles, alongside plentiful on street parking for visiting guests.

Outside, the home continues to impress with a beautifully arranged rear garden designed for both relaxation and entertaining, featuring a private hot tub, established grape vine and plum tree, and a fantastic patio / BBQ entertaining area complete with pergola, creating the perfect outdoor setting for hosting friends and family or simply unwinding in privacy.



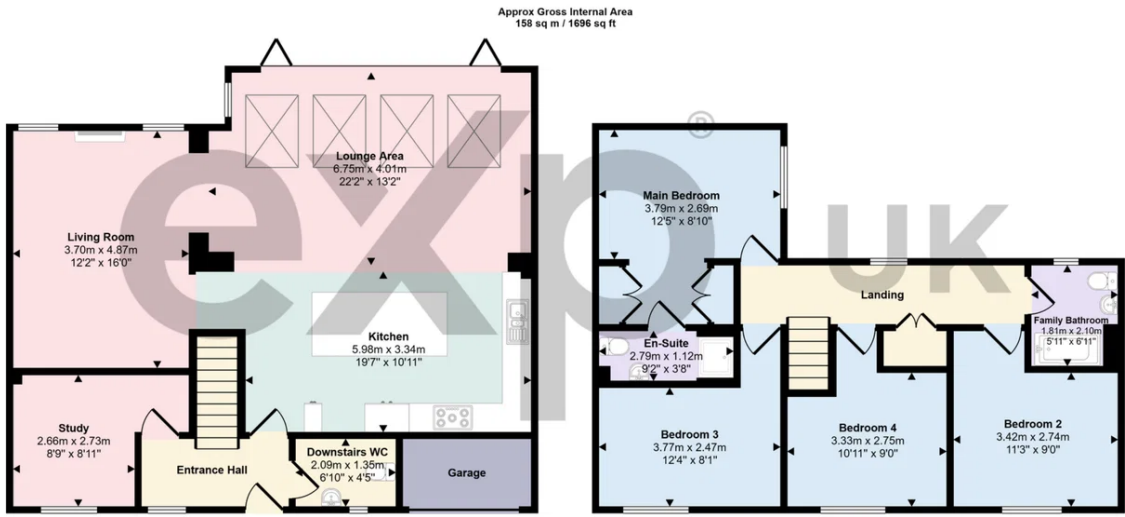

This floorplan is only for illustrative purposes and is not to scale. Measurements of rooms, doors, windows, and any items are approximate and no responsibility is taken for any error, omission or mis-statement. Icons of items such as bathroom suites are representations only and may not look like the real items. Made with Made Snappy 360.



Score	Energy rating	Current	Potential
92+	A		
81-91	B		
69-80	C		71 C
55-68	D	63 D	
39-54	E		
21-38	F		
1-20	G		

Ethan Gaulter
 Local Estate Agent
 01908 464 950
 Ethan.Gaulter@exp.uk.com
 https://ethangaulter.exp.uk.com